

9" HORIZONTAL DRIVE HEADSTOCK
Model A, B, & C

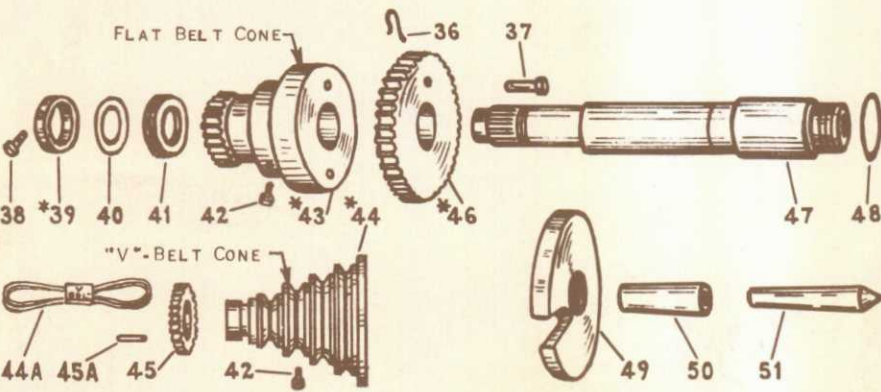

*Available only as sub-assembly. Parts included are indicated by the item numbers appearing in parenthesis after part name.

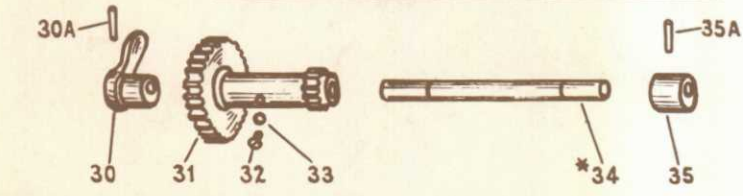
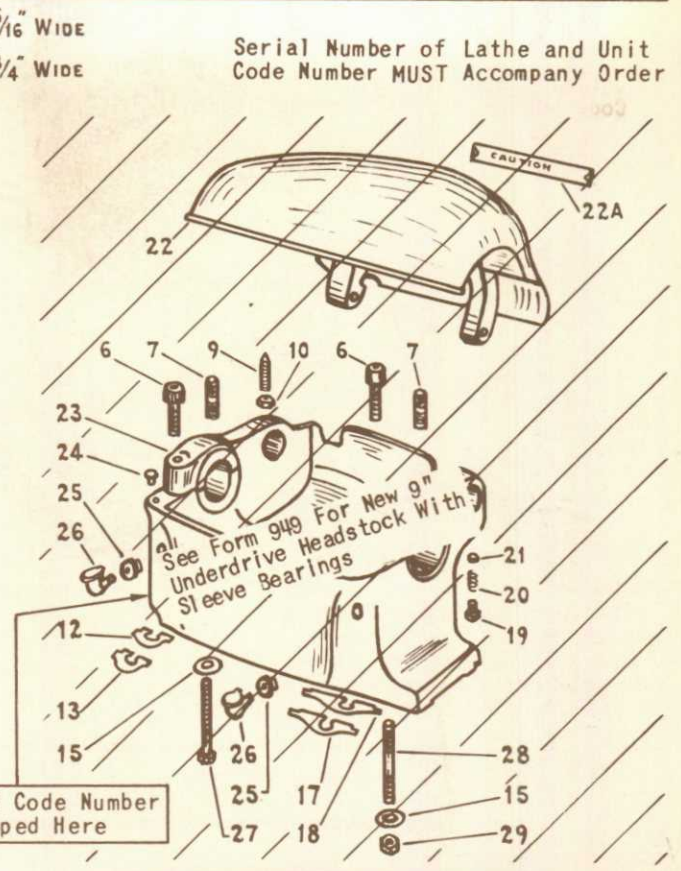

9" UNDERDRIVE HEADSTOCK
Model A, B, & C

HEADSTOCK PARTS			
ITEM NO.	PART NO.	PART NAME	PRICE EACH
1	PT1943N2	BRACKET, 2-5/16"	\$ 1.55
2	PT1942N1	BRACKET, 2-3/4"	1.85
3	PT148N1	QUILL GUARD	3.30
4	PT149N1	BULL GUARD	3.00
5	AS362N1	SAFETY GUARD	1.55
6	114X220	SCREW	.45
7	AS373N1	CAPILLARY OILER	.30
8	PT10N2	HEADSTOCK (Price on Req.)	
9	PT377NR1	STOP SCREW	.10
10	PT1058NR1	NUT	.05
11	PT2677NR1	OILER	.50
12	PT365N1	LAM. SHIM	.50
13	PT366N1	SOLID SHIM	.30
14	PT13NK1	CLAMP, 1-31/32"	1.40
14A	PT13NK1	CLAMP, 2-5/32"	1.60
15	PT1672NK1	WASHER	.05
16	112X228	SCREW	.10
17	PT363N1	LAM. SHIM	.55
18	PT364N1	SOLID SHIM	.45
19	PT376NR1	SCREW	.05
20	PT374NR1	SPRING	.05
21	PT1075NR1	SHOE	.05
22	PT2576NK1	COVER	19.60
22A	PT2583NK1	CAUTION PLATE	.50

Continued on reverse side

NOTE: Exchange Headstocks are available for 9" Model A, B, & C Lathes. Write for information.

Prices net. F.O.B. South Bend, Ind. (Subject to change without notice)

Serial Number of Lathe and Unit Code Number MUST Accompany Order

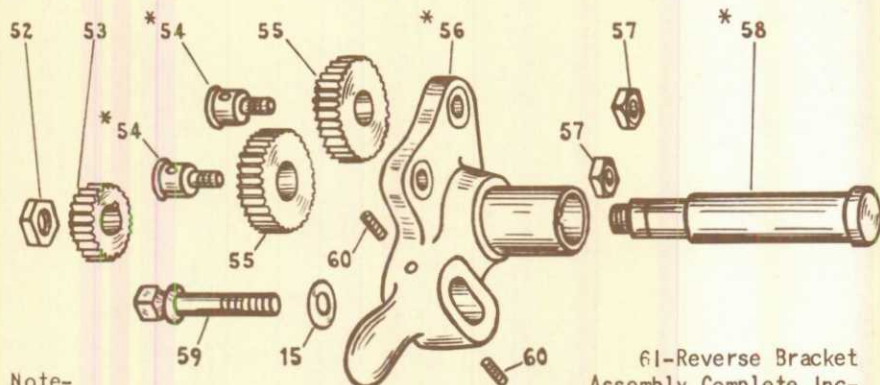

Note-
The 20 tooth and 40 tooth stud gears for the gear box lathe will be found on the gear box parts sheet, item Nos. 47 and 55.

61-Reverse Bracket Assembly Complete. Includes all items shown above.

9" HEADSTOCK (REVERSE BRACKET)
Model A, B, & C

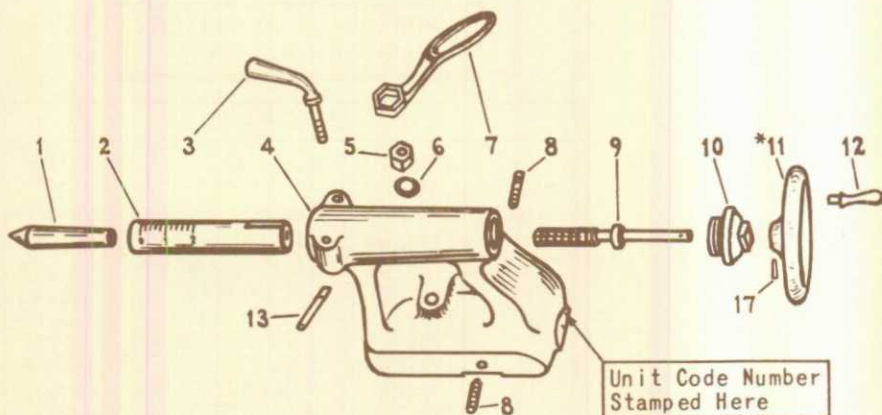

9" TAILSTOCK
Model A, B, & C

HEADSTOCK PARTS

ITEM NO.	PART NO.	PART NAME	PRICE EACH
23	PT2575N2	HEADSTOCK (Price on Req.)	
24	PT387NK1	RUBBER BUMPER	\$.05
25	PT386N1	OILER FLANGE	.40
26	PT2676NK1	OILER	.70
27	112X248	CLAMP SCREW	.15
28	PT385NK1	STUD	.30
29	138X27	STUD NUT	.05
30	PT24NK2	Order Item 34	---
30A	168X312	TAPER PIN	.10
31	AS361NK2	BACK GEAR (32-33)	11.75
32	PT1151N1	OIL SCREW	.05
33	PT378NK1	OIL HOLE WASHER	.05
34	*AS202NK1	ECC. SHAFT (30-30A-35-35A)	8.15
35	PT438NK1	Order Item 34	---
35A	168X310	TAPER PIN	.10
36	PT367NR1	SPRING	.05
37	PT214HR2	PLUNGER	1.80
38	PT382NK1	SCREW	.10
39	*AS25NK2	TAKE-UP NUT (38-40)	2.15
40	PT26NK2	TAKE-UP WASHER	.10
41	PT207NK1	THRUST BEARING	9.80
42	PT381NH1	OIL PLUG SCREW	.10
43	*AS14NK1	CONE (42)	23.60
44	*AS432NK1	V CONE (42-45-45A)	42.75
44A	CE5L550	"V" BELT	2.74
45	PT433NK1	V CONE PINION	5.90
45A	160X23	PIN	.05
46	*AS15NK1	BULL GEAR (36-37)	7.95
47	PT200N2	SPINDLE	36.00
48	PT370N2	RING	.50
49	CL2175NK	FACE PLATE	7.25
50	CL205NK	SPINDLE SLEEVE	2.60
51	CE2401	CENTER	3.00
52	137X29	NUT	.15
53	PT28NK1	REVERSE GEAR	3.10
54	*AS229N1	TWIN STUD (57)	2.30
55	PT27K32NK1	TWIN GEAR	3.00
56	*AS635N1	REV. BRACKET (60)	7.00
57	139X25	NUT	.05
58	*AS637NK1	REV. SHAFT (52)	3.05
59	PT371NK1	LOCK SCREW	.55
60	122X207	SET SCREW	.10
61	AXS635N1	Rev. Brkt. Compl.	24.35

TAILSTOCK PARTS

1	CE2401	CENTER	\$ 3.00
2	PT201HR1	SPINDLE	7.90
3	PT54NK1	LEVER	.95
4	PT50N1	T. S. TOP (Price on Req.)	
5	PT283NK1	NUT	.30
6	PT2861NK1	WASHER	.05
7	CE2653N	T. S. WRENCH	.70
8	PT278NK1	SCREW	.30
9	PT226N2	T. S. SCREW	3.40
10	PT52N1	T. S. NUT	2.50
11	*AS53NK1	HANDWHEEL (12-17)	3.25
12	PT1480	HANDLE	.55
13	PT286NR1	SPINDLE KEY	.30
14	PT51N1	T. S. BASE	4.00
15	PT56N3	CLAMP, 1-31/32"	.85
15A	PT56NK2	CLAMP, 2-5/32"	.90
16	143X214	CLAMP BOLT	.20
17	168X106	PIN	.05

Prices Net. F.O.B. South Bend, Ind.
(Subject to change without notice)

Serial Number of Lathe and Unit
Code Number MUST Accompany Order

Unit Code Number
Stamped Here

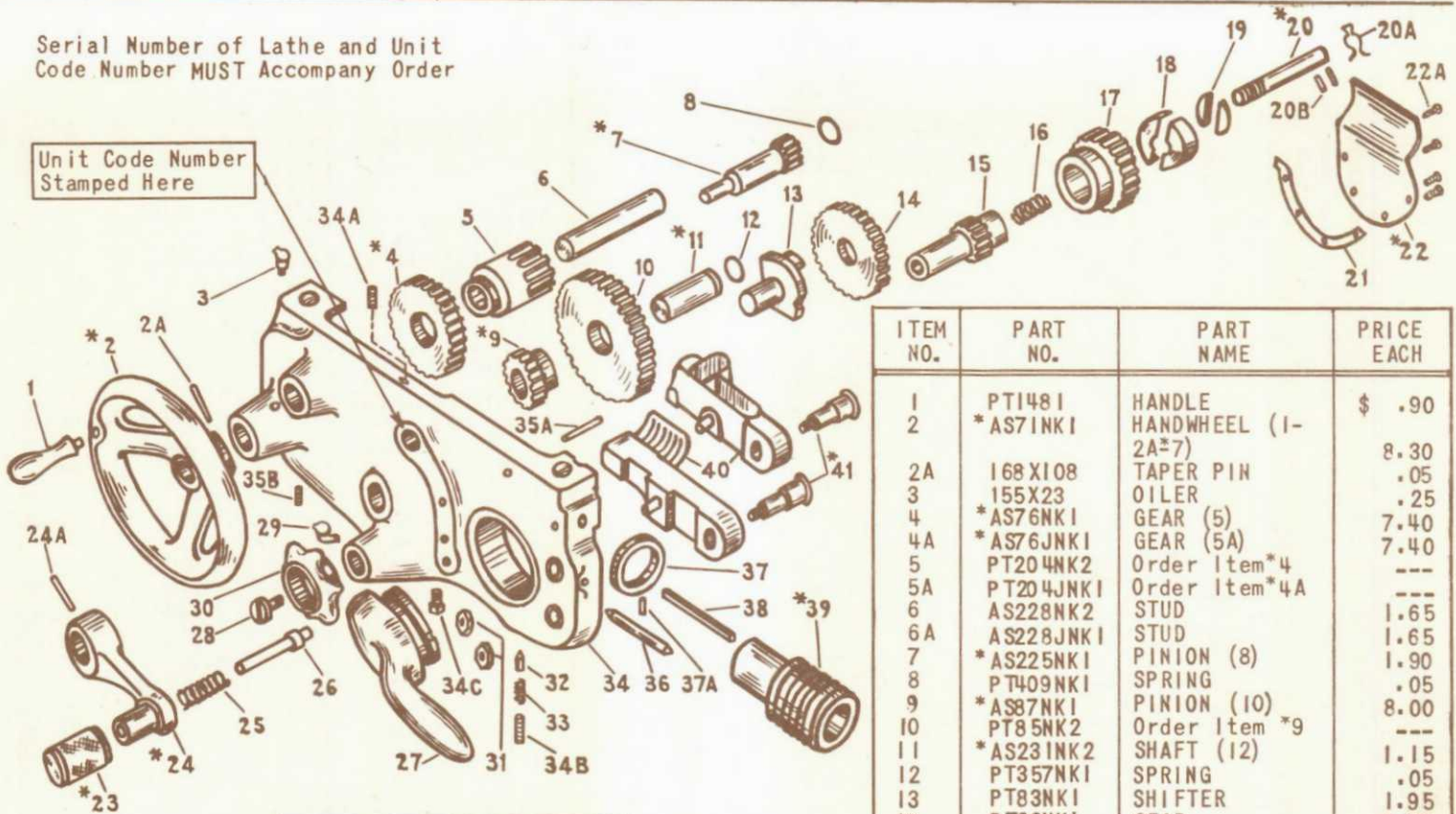

9" & 10-K APRON
Model A & B

Unit Code Number
Stamped Here

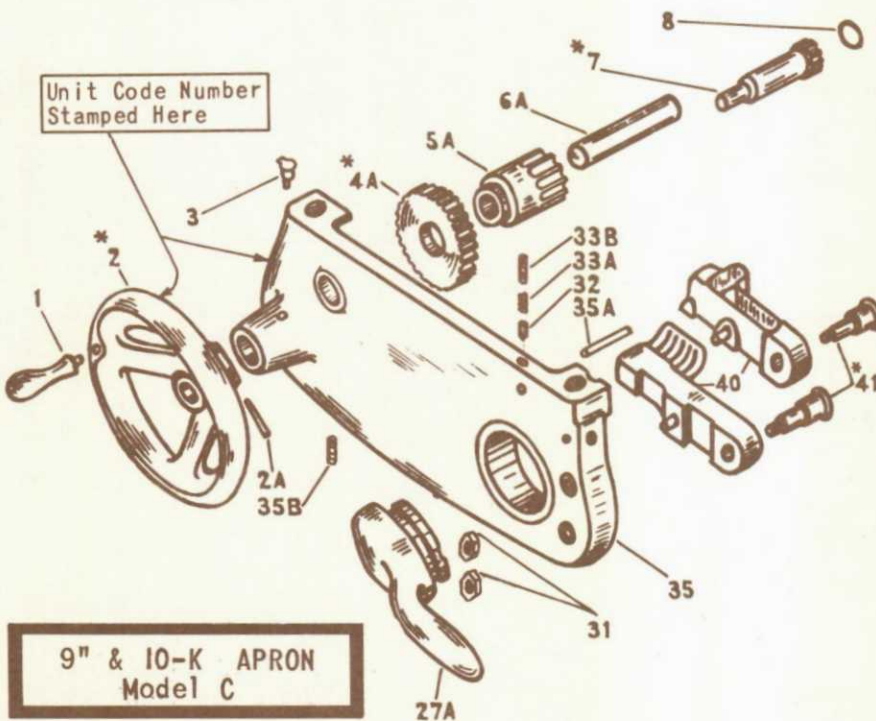

9" & 10-K APRON
Model C

ITEM NO.	PART NO.	PART NAME	PRICE EACH
1	PT1481	HANDLE	\$.90
2	*AS71NK1	HANDWHEEL (1-2A) ²⁷	8.30
2A	168X108	TAPER PIN	.05
3	155X23	OILER	.25
4	*AS76NK1	GEAR (5)	7.40
4A	*AS76JNK1	GEAR (5A)	7.40
5	PT204NK2	Order Item*4	---
5A	PT204JNK1	Order Item*4A	---
6	AS228NK2	STUD	1.65
6A	AS228JNK1	STUD	1.65
7	*AS225NK1	PINION (8)	1.90
8	PT409NK1	SPRING	.05
9	*AS87NK1	PINION (10)	8.00
10	PT85NK2	Order Item *9	---
11	*AS231NK2	SHAFT (12)	1.15
12	PT357NK1	SPRING	.05
13	PT83NK1	SHIFTER	1.95
14	PT86NK1	GEAR	4.30
15	PT80NK1	SLEEVE	3.00
16	162X19	SPRING	.10
17	PT77NK1	GEAR	5.45
18	PT352NK1	SHOES (Pair)	1.95
19	PT353NK1	EXPANDERS (Pair)	.45
20	*AS223NK1	SCREW (20B-28)	1.50
20A	PT349NK1	SPRING	.40
20B	160X22	PIN	.05
21	PT412NK1	GASKET	.05
22	*AS227NK1	TROUGH (21-22A)	1.80
22A	101X104	SCREW	.05
23	*AS88NK2	KNOB (25-26)	2.45
24	*AS84NK1	LEVER (13 ² 23-24A)	5.20
24A	168X210	TAPER PIN	.10
25	162X35	SPRING	.05
26	PT89NK1	Order Item *23	---
27	AS74NK1	CAM	3.00
27A	AS74JNK1	CAM	3.00
28	PT355NFI	SCREW	.10
29	PT2677NRI	OILER	.50
30	PT82NK1	KNOB	.95
31	137X25	NUT	.25
32	PT351NK1	PIN	.10
33	162X5	SPRING	.05
33A	162X34	SPRING	.05
33B	122X606	SCREW	.05
34	PT70NK1	APRON (Price on Request)	
34A	122X208	SCREW	.10
34B	122X604	SCREW	.05
34C	PT1511	PIPE PLUG	.30
35	PT70JNK1	APRON (Price on Request)	
35A	PT2854NK1	OIL TUBE	.10
35B	120X108	SCREW	.20
36	PT97NK2	PLUNGER	.50
37	PT208NK1	COLLAR	1.80
37A	160X19	PIN	.05
38	PT690NK1	KEY	.10
39	*AS203NK1	WORM (37-37A-38)	11.30
40	AS72NK1	HALF NUT	4.90
41	*AS350NK1	SCREW (31)	2.70

*Available only as sub-assembly. Parts included are indicated by the item numbers appearing in parenthesis after part name.

Prices Net F.O.B. South Bend, Ind.
(Subject to change without notice)

SOUTH BEND LATHE WORKS

425 E. Madison St., South Bend 22, Ind., U.S.A.

Printed in U.S.A.

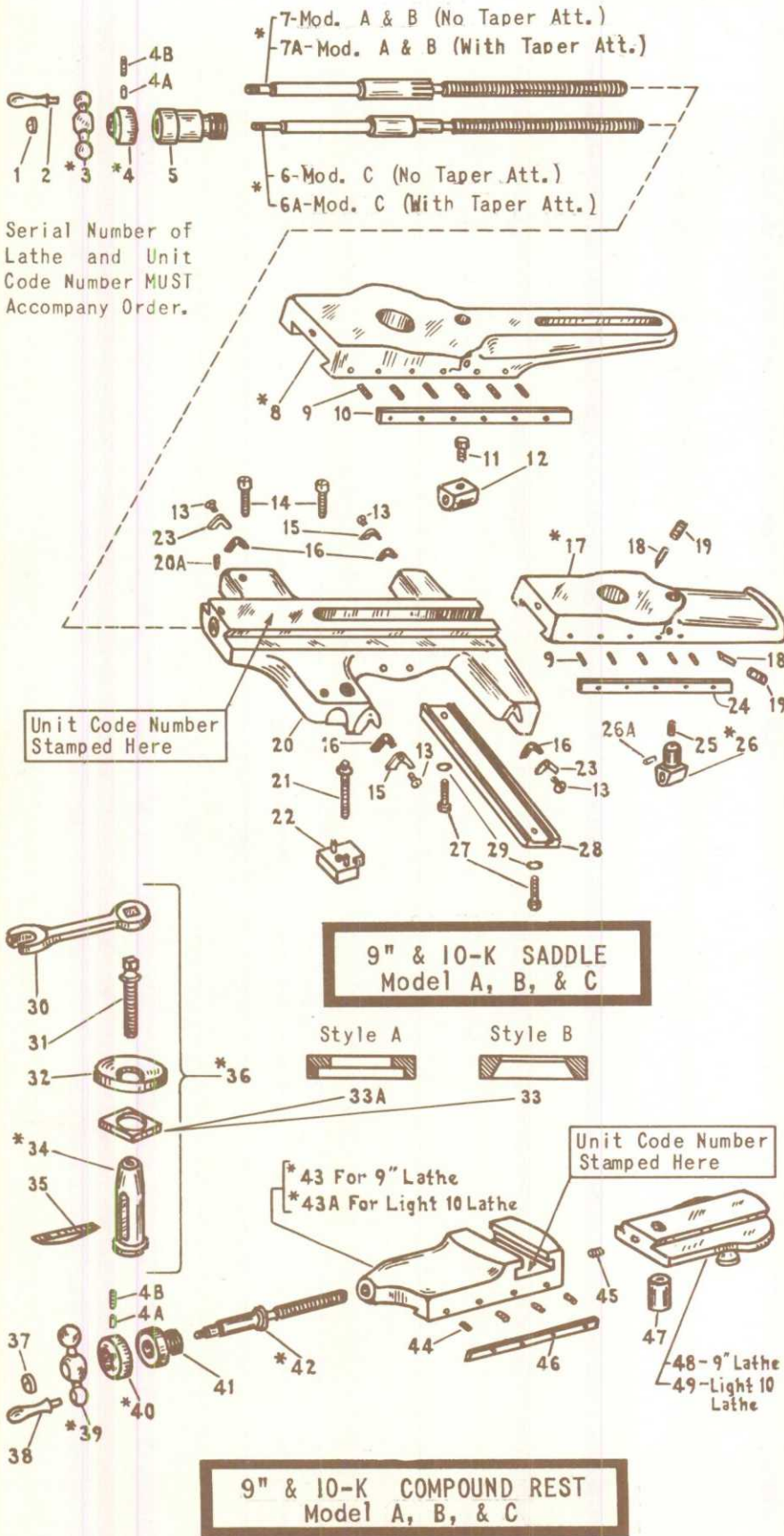

Serial Number of Lathe and Unit Code Number MUST Accompany Order.

Unit Code Number Stamped Here

Unit Code Number Stamped Here

ITEM NO.	PART NO.	PART NAME	PRICE EACH
1	PT295NR1	NUT	\$.10
2	PT1480	HANDLE	.55
3	*AS276NK1	BALL CRANK (2)	1.90
4	*AS64NK1	COLLAR (4A-4B)	2.40
4A	PT1076NR1	BINDER SHOE	.05
4B	122X103	SCREW	.05
5	PT63NK1	BUSHING	3.00
6	*AS224JNK2	C. F. SCREW (1 3 ² 4-5 ² 26)	15.55
6A	*ATA224JNK2	T. A. C. F. SCREW (1 ² 3 ² 4-5-11-12)	15.55
7	*AS224NK2	C. F. SCREW (1 3 ² 4-5 ² 26)	15.55
7A	*ATA224NK2	T. A. C. F. SCREW (1 ² 3 ² 4-5-11-12)	15.55
8	*AS485NK1	T. A. BASE (9- 10-18-19)	22.00
9	122X446	SCREW	.05
10	PT874NK1	GIB	1.30
11	PT66NK1	SCREW	.50
12	PT486NK1	CR. FEED NUT	1.80
13	107X6	SCREW	.05
14	PT244NK2	SADDLE SCREW	.10
15	PT57NK1	RETAINER-L	.10
16	PT59NK1	FELT WIPER	.05
17	*AS92NK2	BASE (9-18-19- 24)	12.85
18	PT211NK1	SHOE	.45
19	121X212	SCREW	.20
20	AS60NK1	SADDLE (Price on Request)	
20A	122X102	SCREW	.05
21	PT210NK2	LOCK SCREW	.70
22	AS62NK2	LOCK	.85
23	PT58NK1	RETAINER-R	.10
24	PT221NK1	GIB	.55
25	PT359NK1	LOCK SCREW	.05
26	*AS65NK1	C. F. NUT (25-26A)	1.95
26A	PT358NK1	PIN	.05
27	112X114	SCREW	.05
28	PT61NK1	GIB	1.55
29	PT3400	WASHER	.05
30	CE2650NK	WRENCH	.85
31	PT233NK1	T. P. SCREW	.90
32	PT251NK1	RING	1.40
33	PT209NK2	BLOCK Style B	.90
33A	PT209NK1	BLOCK Style A	.90
34	*AS250NK3	TOOL POST (33)	5.20
35	PT252NK2	WEDGE	.50
36	*CE2450NK	TOOL POST (30- 31-32 ² 34-35)	7.55
37	PT295NR1	NUT	.10
38	PT1480	HANDLE	.55
39	*AS277NR1	CRANK (38)	2.85
40	*AS110NK1	COLLAR (4A-4B)	1.90
41	PT94NK1	BUSHING	1.95
42	*AS230NK2	SCREW (37 ² 39- 40-41-47)	12.20
43	*AS90N1	C. R. TOP (*42- 44-45-46-48)	33.20
43A	*AS90K1	C. R. TOP (*42- 44-45-46-49)	34.70
44	122X444	SCREW	.05
45	122X508	SCREW	.10
46	PT257NK1	GIB	.55
47	PT95NK1	C. R. NUT	1.55
48	PT91N1	SWIVEL	10.35
49	PT91K1	SWIVEL	11.85

*Available only as sub-assembly. Parts included are indicated by the item numbers appearing in parenthesis after part name.

Prices Net. F.O.B. South Bend, Ind. (Subject to change without notice)

Serial Number of Lathe and Unit Code Number MUST Accompany Order

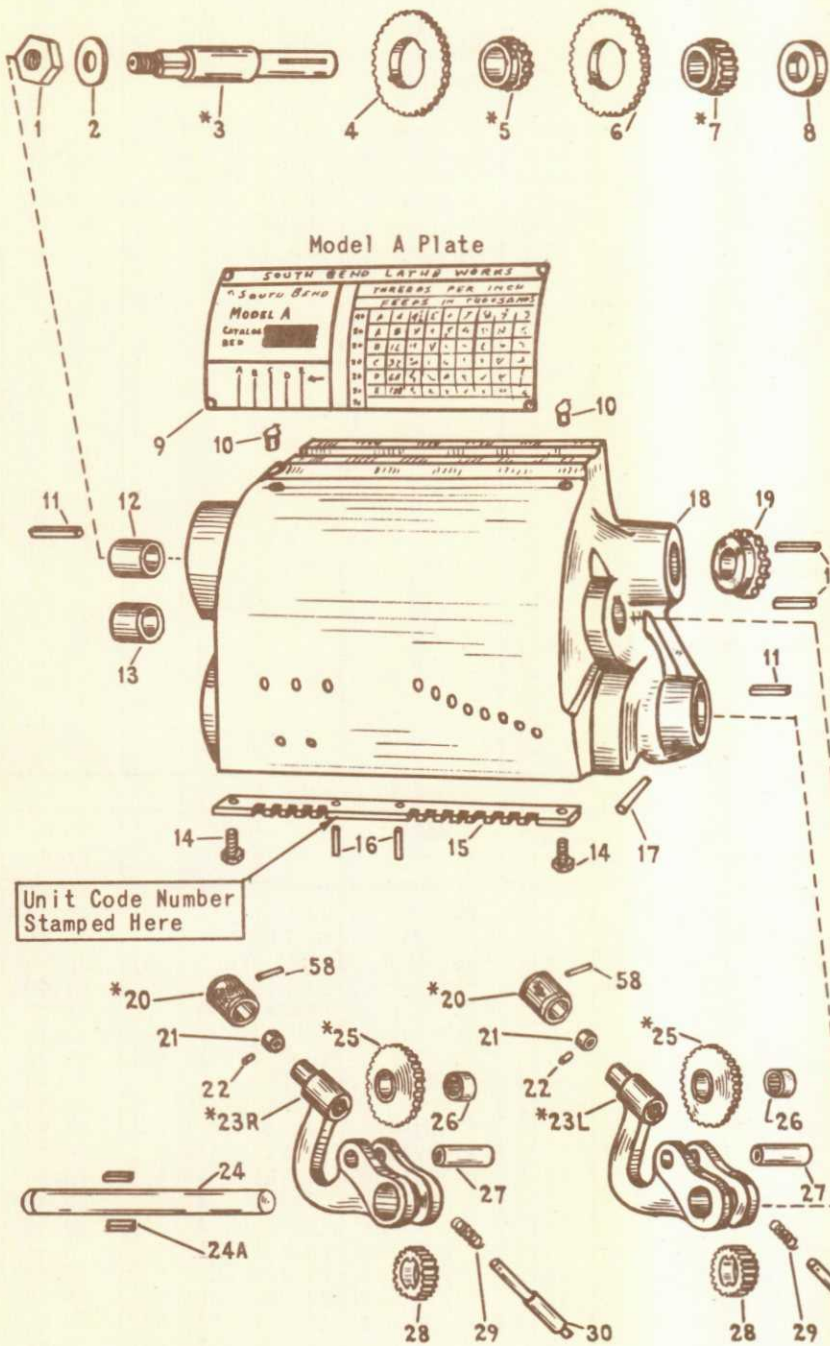

GEAR BOX PARTS

ITEM NO.	PART NO.	PART NAME	PRICE EACH
1	140X29	NUT	\$.10
2	161X73	WASHER	.05
3	*AS603NKI	SHAFT (1-2-8)	12.30
4	PT627NKI	Order Item 5	---
5	*AS625NKI	COMP. PINION(4)	9.15
6	PT626NKI	Order Item 7	---
7	*AS619NKI	COMP. PINION(6)	8.30
8	PT604NKI	COLLAR	1.60
9	AS154INK3	INDEX PLATE	1.95
10	155X20	OILER	.25
11	256X3	FELT WICKING	.10
12	PT606NK2	BUSHING	1.15
13	PT601NK2	BUSHING	1.15
14	111X6	SCREW	.10
15	PT607NKI	GUIDE BAR	1.95
16	160X19	PIN	.05
17	PT1807	PIN	.05
18	AS600NKI	GEAR BOX (Price on Req.)	
19	PT628NKI	L. S. GEAR	4.30
20	*AS609NKI	KNOB (29-30+58)	3.00
21	PT610NR1	BUSHING	.85
22	160X42	PIN	.05
23R	*AS400NK2	R. H. TUMBLER(20-21-22-25-26-27-29-30)	14.55
23L	*AS401NK1	L. H. TUMBLER(20-21-22-25-26-27-29-30)	14.55
24	PT620NKI	SHAFT	1.95
24A	256X1	FELT WICK	.10
25	*AS605NKI	GEAR (26)	4.40
26	PT384NKI	BEARING	1.15
27	160X252	SHAFT	.70
28	PT621NKI	GEAR	4.00
29	162X50	SPRING	.05
30	PT608NKI	PLUNGER	1.15
31	PT624NKI	GEAR	3.40
32	PT626NKI	Order Item 33	---
33	*AS623NKI	PINION GEAR(32)	8.00
34	PT626NKI	Order Item 35	---
35	*AS622NKI	PINION GEAR(34)	8.30
36	PT615K16NKI	CONE GEAR, 16T	4.50
37	168X310	TAPER PIN	.10
38	PT615K18NKI	CONE GEAR, 18T	3.10
39	PT615K20NKI	CONE GEAR, 20T	3.30
40	PT615K22NKI	CONE GEAR, 22T	3.40
41	PT615K23NKI	CONE GEAR, 23T	3.60
42	PT615K24NKI	CONE GEAR, 24T	3.90
43	PT615K26NKI	CONE GEAR, 26T	4.05
44	PT615K28NKI	CONE GEAR, 28T	4.25
45	160X251	PIN	.05
46	*AS614NKI	SHAFT	5.50

Continued on reverse side
Prices Net F.O.B. South Bend, Ind.
(Subject to change without notice)

*Available only as sub-assembly. Parts included are indicated by the item numbers appearing in parenthesis after part name.

9" & 10-K GEAR BOX
Model A

Serial Number of Lathe and Unit Code Number MUST Accompany Order

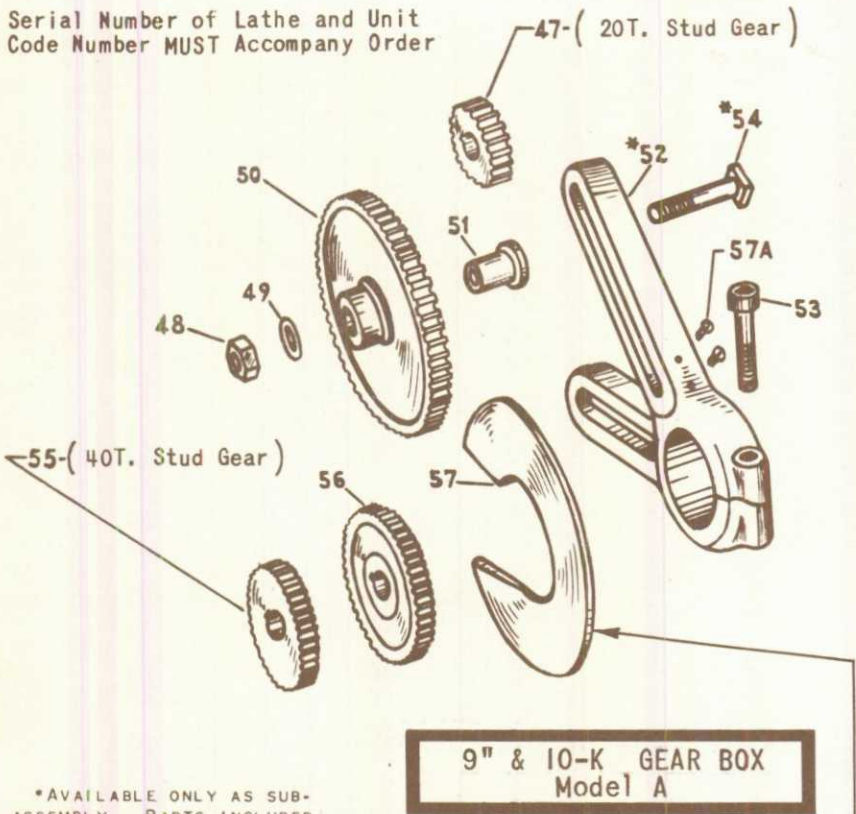

9" & 10-K GEAR BOX Model A

*AVAILABLE ONLY AS SUB-ASSEMBLY. PARTS INCLUDED ARE INDICATED BY THE ITEM NUMBERS APPEARING IN PARENTHESIS AFTER PART NAME.

NOTE: This Guard, With Screws, Item No. 57A Also Used On Models B And C.

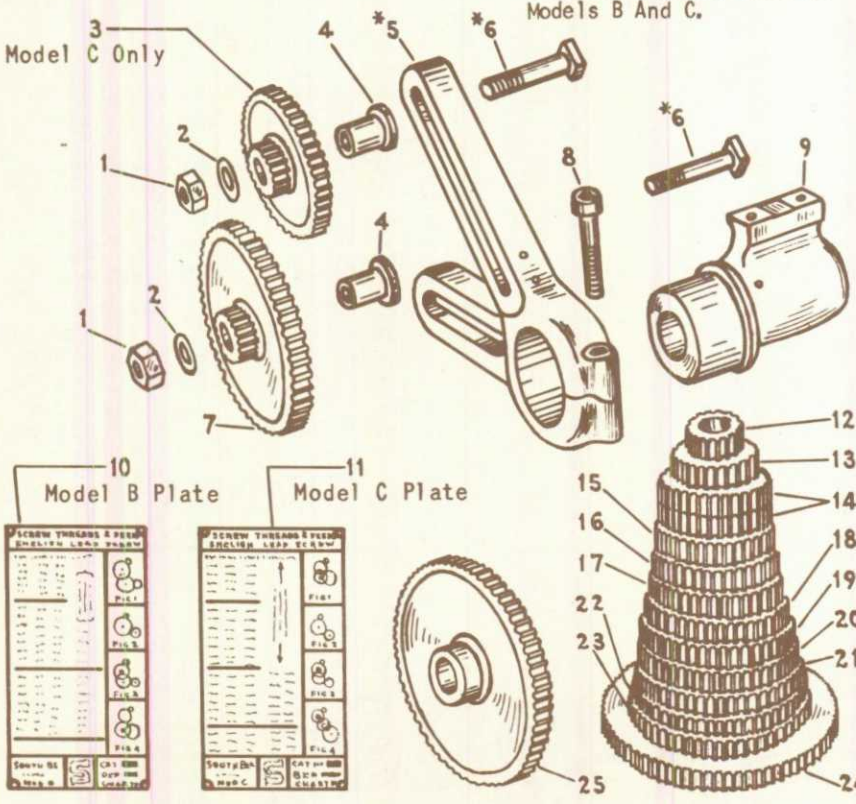

9" & 10-K STANDARD CHANGE GEAR Model B & C

GEAR BOX PARTS

ITEM NO.	PART NO.	PART NAME	PRICE EACH
47	PT32K20NK1	GEAR, 20 T.	\$ 3.40
48	140X29	NUT	.10
49	161X21	WASHER	.05
50	PT33NK1	IDLER GEAR	6.90
51	PT38NK1	BUSHING	1.20
52	*AS31NK1	BRACKET (53)	9.20
53	114x228	SCREW	.45
54	*AS247NK1	BOLT (48-49)	.60
55	PT32K40NK1	GEAR, 40 T.	3.60
56	PT32K56NK1	GEAR, 56 T.	5.10
57	PT389NK2	GUARD	1.80
57A	PT1150N1	SCREW	.05
58	160x27	Pin	.05

STANDARD CHANGE GEAR PARTS

ITEM NO.	PART NO.	PART NAME	PRICE EACH
1	140X29	NUT	\$.10
2	161X21	WASHER	.05
3	AS336NK1	COMP. GEAR, 18/54T	10.35
4	PT38NK1	BUSHING	1.20
5	*AS31NK1	BRACKET (8)	9.20
6	*AS247NK1	BOLT (1-2)	.60
7	AS36NK1	COMP. GEAR, 18/72T	10.75
8	114X228	SCREW	.45
9	PT4NK1	FRONT BRACKET	5.90
10	AS1525NK3	INDEX PLATE	1.95
11	AS1527JNR2	INDEX PLATE	1.95
12	PT32K16NK1	CHANGE GEAR, 16T	3.35
13	PT32K24NK1	CHANGE GEAR, 24T	3.40
14	PT32K32NK1	CHANGE GEAR, 32T	3.45
15	PT32K36NK1	CHANGE GEAR, 36T	3.45
16	PT32K40NK1	CHANGE GEAR, 40T	3.60
17	PT32K44NK1	CHANGE GEAR, 44T	4.00
18	PT32K46NK1	CHANGE GEAR, 46T	4.00
19	PT32K48NK1	CHANGE GEAR, 48T	4.65
20	PT32K52NK1	CHANGE GEAR, 52T	4.65
21	PT32K54NK1	CHANGE GEAR, 54T	5.05
22	PT32K56NK1	CHANGE GEAR, 56T	5.10
23	PT32K60NK1	CHANGE GEAR, 60T	5.55
24	PT32K80NK1	CHANGE GEAR, 80T	6.90
25	PT33NK1	IDLER GEAR, 80T	6.90

Prices Net F. O. B. South Bend, Ind. (Subject to change without notice)

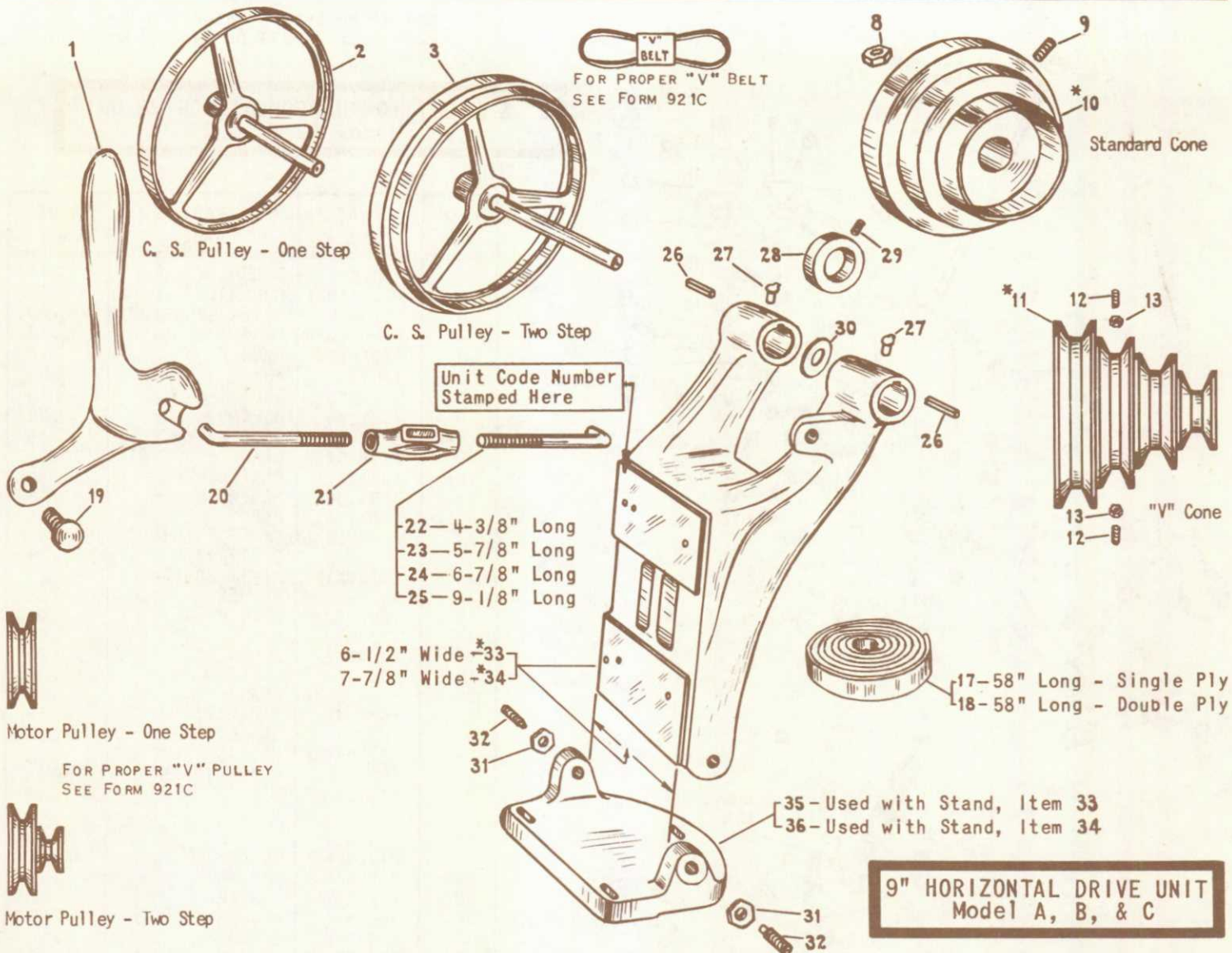

Serial Number of Lathe and Unit Code Number MUST Accompany Order.

*Available only as sub-assembly. Parts included are indicated by the item numbers appearing in parenthesis after part name.

ITEM NO.	PART NO.	PART NAME	PRICE EACH	ITEM NO.	PART NO.	PART NAME	PRICE EACH
1	PT1945NI	LEVER	\$ 6.90	28	AS735NRI	COLLAR	\$ 1.15
2	AS1941NI	SHAFT & PULLEY	9.30	29	120X206	SCREW	.20
3	AS1960N3	SHAFT & PULLEY	15.35	30	PT1676NI	WASHER	.05
4				31	139X29	HEX NUT	.05
5				32	PT243NRI	PIVOT SCREW	.45
6				33	*AS1940N2	STANDARD (26-27)	16.10
7				34	*AS2940NI	STANDARD (26-27)	23.95
8	139X27	HEX NUT	.05	35	PT1944NI	SMALL BASE	4.00
9	120X212	SCREW	.25	36	PT2944NI	LARGE BASE	7.15
10	*AS103NKI	CONE (STD.) (8-9)	9.10	37			
11	*AS431NKI	CONE (V) (12-13)	17.25	38			
12	120X112	SCREW	.20	39			
13	139X25	HEX NUT	.05	40			
14				41			
15				42			
16							
17	CE2323N	FLAT BELT S.P.	1.90				
18	CE3190	FLAT BELT D.P.	7.25				
19	PT1949NK2	PIN	.15				
20	PT1946NI	R. H. ROD	.55				
21	PT1948NI	TURNBUCKLE	1.55				
22	PT394NI	L. H. ROD	.70				
23	PT396NI	L. H. ROD	.70				
24	PT397NI	L. H. ROD	.70				
25	PT395NI	L. H. ROD	.70				
26	256X9	FELT WICK	.20				
27	155X20	OILER	.25				

Prices Net. F.O.B. South Bend, Ind. (Subject to change without notice)

Serial Number of Lathe and Unit
Code Number MUST Accompany Order

**9" & LIGHT 10 UNDERNEATH DRIVE UNIT
Model A, B, & C**

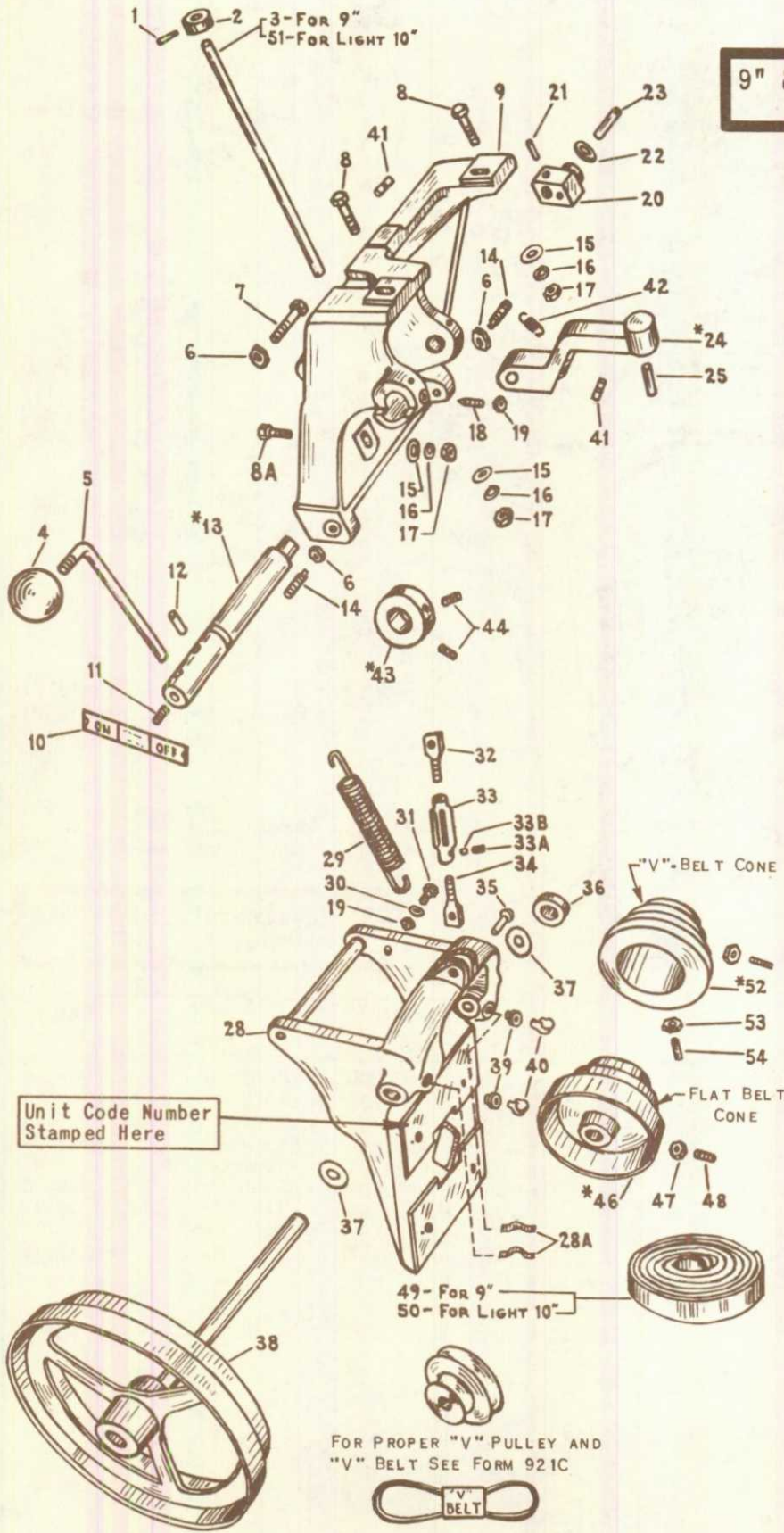

ITEM NO.	PART NO.	PART NAME	PRICE EACH
1	120X6	SCREW	\$.15
2	PT2610NK1	COLLAR	1.15
3	PT2608N	COVER LOCK ROD	.50
4	PT406K&FH	KNOB	.70
5	PT2609NK1	HANDLE	.10
6	139X29	NUT	.05
7	112X336	BOLT	.10
8	112X224	BOLT	.05
8A	542X406	BOLT	.15
9	PT2640NK2	CRADLE SUPPORT	20.60
10	AS417NK1	PLATE	.50
11	120X106	SCREW	.20
12	160X116	PIN	.05
13	*AS2605NK1	SHAFT (11-12-20 21-22-23)	4.35
14	PT390NK1	PIVOT SCREW	.25
15	167X4	WASHER	.05
16	180X302	LOCK WASHER	.05
17	138X27	NUT	.05
18	121X112	SCREW	.25
19	139X25	NUT	.05
20	PT2603NK1	CRANK	.55
21	168X410	TAPER PIN	.10
22	161X17	WASHER	.05
23	PT2604NK1	RELEASE PIN	.90
24	*AS2607NK2	BRACKET (25)	9.10
25	PT1824-3	PIN	.30
26			
27			
28	PT2540NK1	CRADLE	32.45
28A	PT2610NK1	SPRING	.55
29	PT2638NT1	SPRING	.50
30	161X14	WASHER	.05
31	112X116	SCREW	.05
32	PT2600NK1	R. H. SCREW	1.25
33	AS2606NK1	TURNBUCKLE	2.00
33A	120X6	SCREW	.15
33B	PT108INT1	SHOE	.05
34	PT2601NK1	L. H. SCREW	1.25
35	PT1949NK2	CLEVIS PIN	.15
36	AS735NR1	COLLAR	1.15
37	PT1676NK1	WASHER	.05
38	AS1960N3	SHAFT & PULLEY	15.35
39	PT386R1	OILER FLANGE	.45
40	155X44	OILER	.75
41	PT2615NK1	PIN	.10
42	PT2614NK1	SPRING	.10
43	*AS2613NK1	COLLAR (44)	2.50
44	120X108	SCREW	.20
45			
46	*AS103NK1	C. S. CONE (47-48)	9.10
47	139X27	NUT	.05
48	120X212	SCREW	.30
49	CE3192N	FLAT BELT D. P.	7.75
50	CE3192K	FLAT BELT D. P.	7.75
51	PT2608K1	COVER LOCK ROD	.65
52	*AS43INK1	C.S. CONE (53-54)	17.25
53	139X25	NUT	.05
54	120X112	SCREW	.20

*Available only as sub-assembly. Parts included are indicated by the item numbers appearing in parenthesis after part name.

Prices Net F. O. B. South Bend, Ind.
(Subject to change without notice)

Serial Number of Lathe and Unit Code Number MUST Accompany Order

9" & 10-K BED, LEG, LEAD SCREW Model A, B, & C

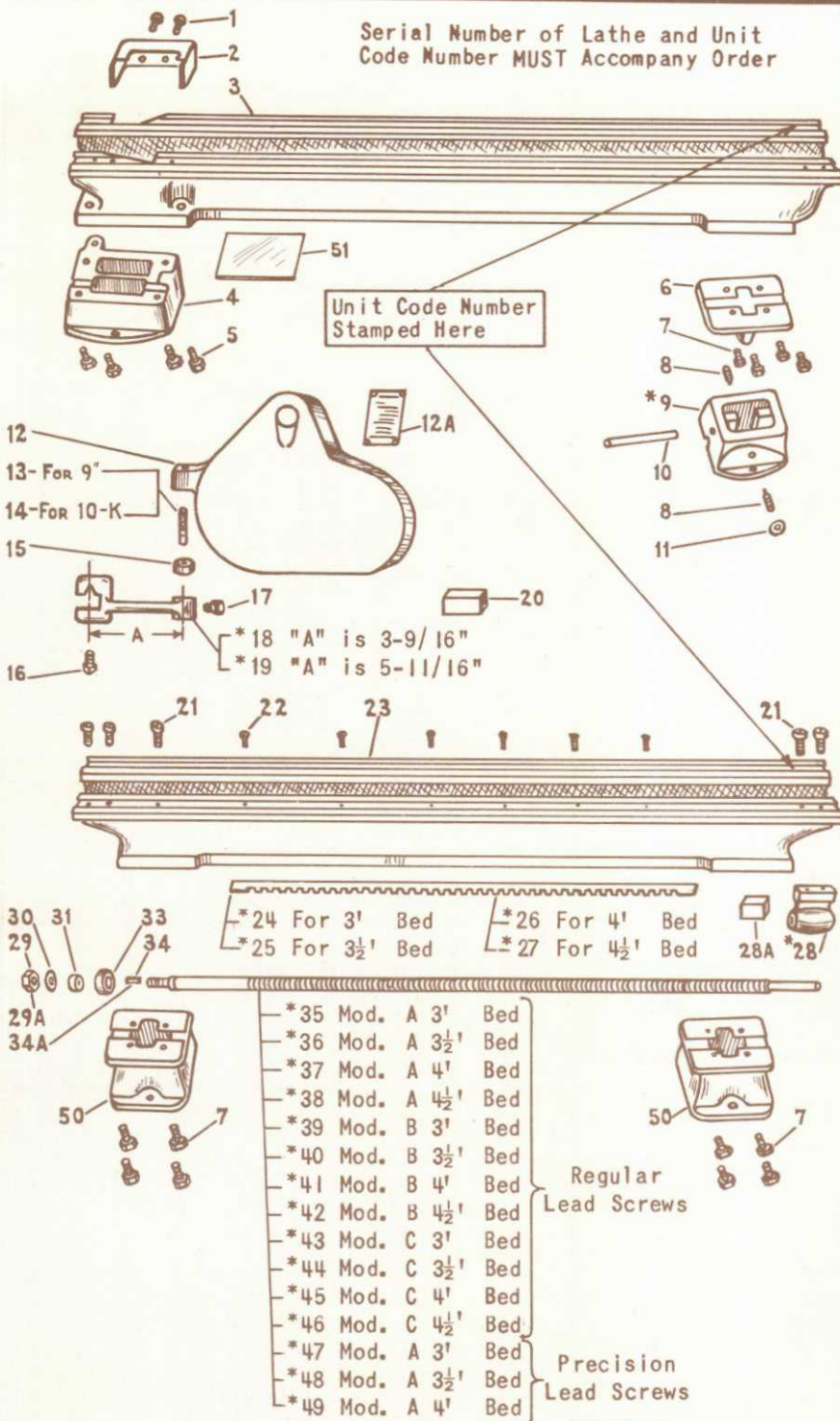

ITEM NO.	PART NO.	PART NAME	PRICE EACH
1	101x608	SCREW	\$.05
2	PT2504NK2	COVER	1.85
3	PT2501NK1	U. D. BED (Write for data)	
4	PT2625NK1	U. D. LEG	13.75
5	112x220	SCREW	.05
6	PT403NK1	BENCH LEG TOP	4.00
7	112x116	SCREW	.05
8	121x228	SCREW	.40
9	*AS402NK1	LEG BASE (8-11)	12.05
10	PT404NR1	LEG SHAFT	.75
11	AS405NR1	LEVELING PLATE	.50
12		GEAR GUARD (Price on Req.)	
12A	PT441-3	LUBE CHART	1.95
13	PT281NI	BRACKET STUD	.45
14	PT281KI	BRACKET STUD	.45
15	PT648K1	RING	.50
16	118x214	SET SCREW	.15
17	PT1851	THUMB SCREW	.40
18	*AS147NK2	BRACKET (16-17)	3.60
19	*AS907NK2	BRACKET (16-17)	3.60
20	506x7	CERRO-MATRIX ILB	2.90
21	PT388NR1	G. B. SCREW	.40
22	PT444NR1	RACK SCREW	.10
23	PT1NK5	BED (Write for data)	
24	*AS275W3NK1	RACK (22)	6.45
25	*AS275W35NK1	RACK (22)	7.55
26	*AS275W4HK1	RACK (22)	8.75
27	*AS275W45NK1	RACK (22)	9.85
28	*AS5NK1	L.S. BRKT. (21)	2.30
28A	506x6	BABBITT 1 LB.	.60
29	140x29	NUT-FOR MODEL B & C	.10
29A	PT1053NR1	NUT-FOR MODEL A	.10
30	161x21	WASHER	.05
31	PT35NK1	COLLAR	.90
32			
33	PT39NR2	THRUST COLLAR	1.40
34	164x86	KEY-FOR MODEL B & C	.25
34A	164x2	KEY-FOR MODEL A	.30
(The following Lead Screws include collar, key, washer and nut)			
35	*AS629W3NK1	LEAD SCREW	22.70
36	*AS629W35NK1	LEAD SCREW	26.20
37	*AS629W4NK1	LEAD SCREW	29.65
38	*AS629W45NK1	LEAD SCREW	33.20
39	*AS300W3NK1	LEAD SCREW	23.70
40	*AS300W35NK1	LEAD SCREW	27.20
41	*AS300W4NK1	LEAD SCREW	30.25
42	*AS300W45NK1	LEAD SCREW	34.20
43	*AS300JW3NK1	LEAD SCREW	23.70
44	*AS300JW35NK1	LEAD SCREW	27.20
45	*AS300JW4NK1	LEAD SCREW	30.25
46	*AS300JW45NK1	LEAD SCREW	34.20
47	*AP629W3NK1	LEAD SCREW	48.80
48	*AP629W35NK1	LEAD SCREW	52.30
49	*AP629W4NK1	LEAD SCREW	55.80
50	PT436NK	BENCH LEG	4.00
51	195x3	VEL. GASKET	.55
52	1640W35NK	METAL BASE (Price on Req.)	
53	1603W35NK	METAL BASE (Price on Req.)	

*Available only as sub-assembly. Parts included are indicated by the item numbers appearing in parenthesis after part name.

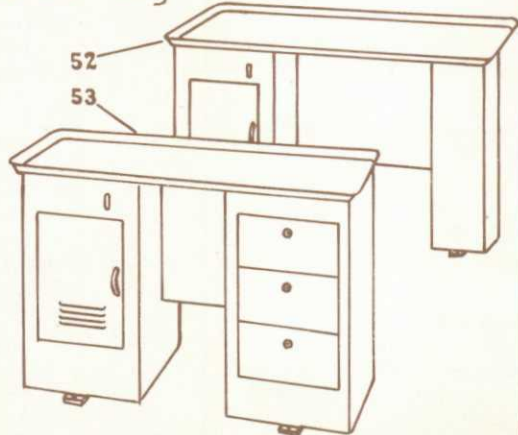

Prices Net. F.O.B. South Bend, Ind. (Subject to change without notice)

Serial Number of Lathe and Unit
Code Number MUST Accompany Order

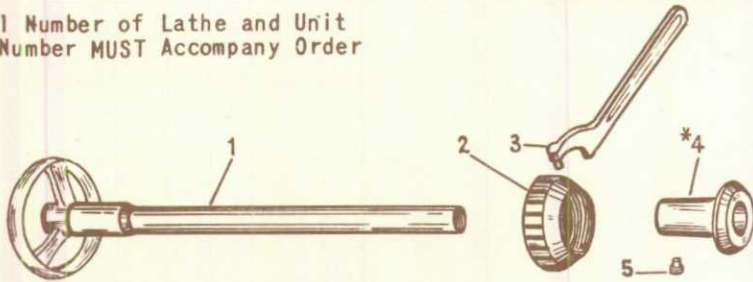

9" HANDWHEEL COLLET ATTACHMENT
Model A, B, & C

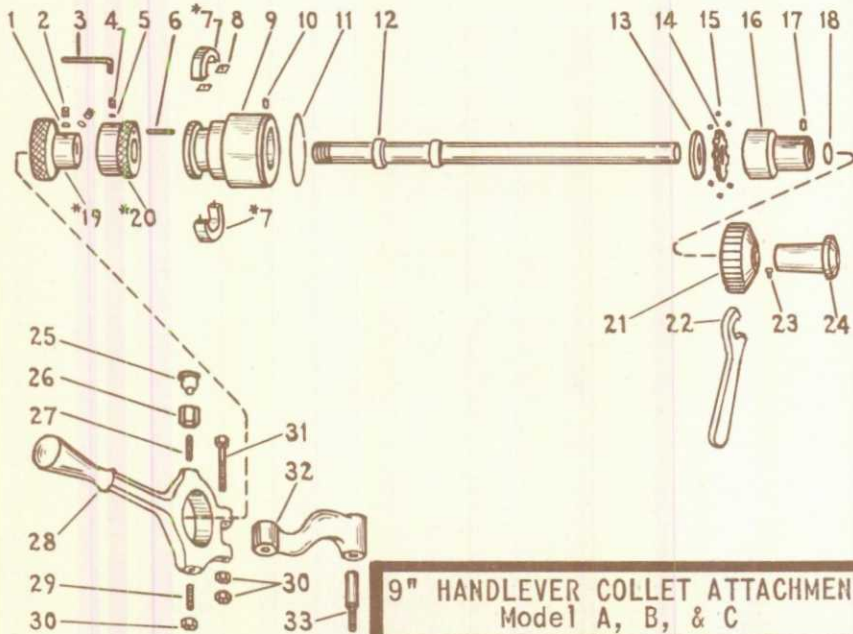

9" HANDLEVER COLLET ATTACHMENT
Model A, B, & C

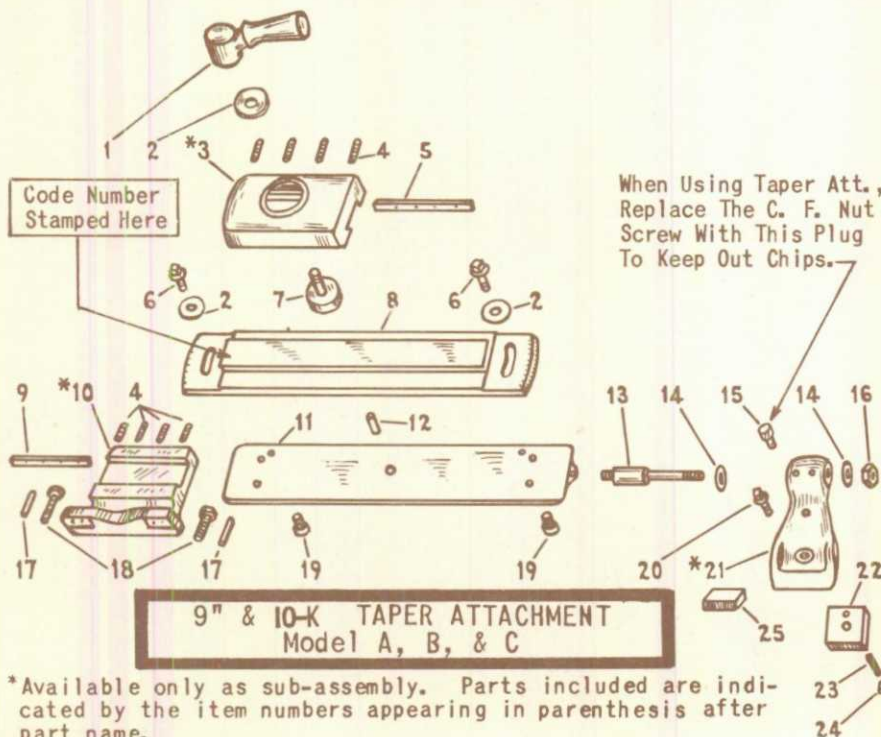

9" & 10" TAPER ATTACHMENT
Model A, B, & C

*Available only as sub-assembly. Parts included are indicated by the item numbers appearing in parenthesis after part name.

When Using Taper Att.,
Replace The C. F. Nut
Screw With This Plug
To Keep Out Chips.

HANDWHEEL COLLET ATTACHMENT

ITEM NO.	PART NO.	PART NAME	PRICE EACH
1	AS793N4	DRAW BAR ASM.	\$15.90
2	PT995NK1	KNOCK-OUT NUT	2.60
3	CE2734	SPANNER WRENCH	.85
4	*AS795N1	SLEEVE (5)	8.05
5	PT493NH1	KEY	1.00

HANDLEVER COLLET ATTACHMENT

1	PT4809RH1	SHOE	\$.05
2	120x903	SET SCREW	.20
3	CE2392	WRENCH	.07
4	126x503	SET SCREW	.20
5	PT1078RH1	SHOE	.05
6	PT1859-1	PIN	.05
7	*AS988NK1	YOKE SEGMENT(8)	5.40 p.r.
8	256x11	FELT WICKS	.55
9	PT986N4	CLUTCH YOKE CONE	26.00
10	PT1823	PIN	.50
11	PT983NK1	CONE SNAP RING	.25
12	PT975N3	DRAW BAR	10.00
13	PT981N2	COLLAR	2.85
14	PT488N2	BALL RETAINER	3.05
15	172x20	STEEL BALL	.05
16	PT979N4	CLUTCH SLEEVE	15.70
17	160x58	SPINDLE PIN	.05
18	PT976N1	BAR SNAP RING	.45
19	*AS978N2	CL. STOP NUT(1-2)	4.50
20	*AS998N1	LOCK COLLAR(4-5)	3.45
21	PT995NK1	KNOCK OUT NUT	2.60
22	CE2734	SPANNER WRENCH	.85
23	PT493NH1	KEY	1.00
24	*AS795N1	SLEEVE (23)	8.05
25	155x5	OILER	.60
26	PT494NR&TI	YOKE LEVER NUT	1.40
27	PT492NR&TI	YOKE LEVER SCREW	1.25
28	PT990NK1	YOKE LEVER	6.15
29	PT377NR1	SCREW	.10
30	PT1058NR1	JAM NUT	.05
31	PT991NK1	YOKE BOLT	1.95
32	PT993NK2	YOKE BRACKET	2.05
33	PT997NK1	BRACKET STUD	.90

TAPER ATTACHMENT

1	PT873NK1	LEVER	\$ 3.00
2	PT857NR2	WASHER	.40
3	*AS861NK2	SLIDE BLOCK(4-5)	11.00
4	122x444	GIB SCREW	.05
5	PT870NK2	BLOCK GIB	2.60
6	PT872NK2	LOCK SCREW	1.15
7	AS867NK1	BINDER STI'D	3.80
8	PT869NK1	SWIVEL BAR	32.90
9	PT859NK1	BED BRKT. GIB	5.25
10	*AS862NK2	BED BRKT. (4-9) Price on Req.	
11	PT860NK1	T. A. BED	27.00
12	160x132	T. A. BED PIN	.05
13	PT865NK1	TIE ROD	4.00
14	161x23	TIE ROD WASHER	.05
15	PT876NK1	CHIP PLUG	1.40
16	PT1051NF1	TIE ROD NUT	.30
17	160x82	BRACKET PIN	.05
18	112x220	BRACKET SCREW	.05
19	111x108	BED SCREW	.15
20	PT371NK1	CLAMP SCREW	.55
21	*AS864NK1	"V" Brkt. (20-22-23-24-25)	8.00
22	PT863NR1	CLAMP	1.15
23	122x624	SET SCREW	.10
24	137x25	NUT	.25
25	506x6	BABBITT, 1 LB.	.60

Prices Net F.O.B. South Bend, Ind.
(Subject to change without notice)

UNIT CODE NUMBER
STAMPED HERE

SERIAL NUMBER OF LATHE AND UNIT
CODE NUMBER "MUST" ACCOMPANY ORDER

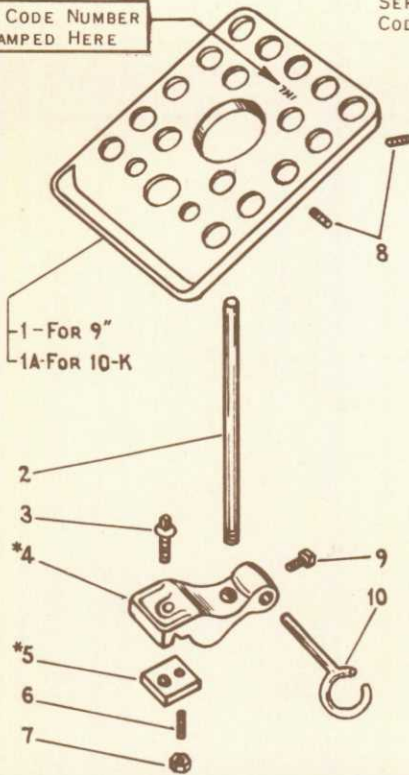

1-For 9"
1A-For 10-K

9" & 10-K COLLET RACK

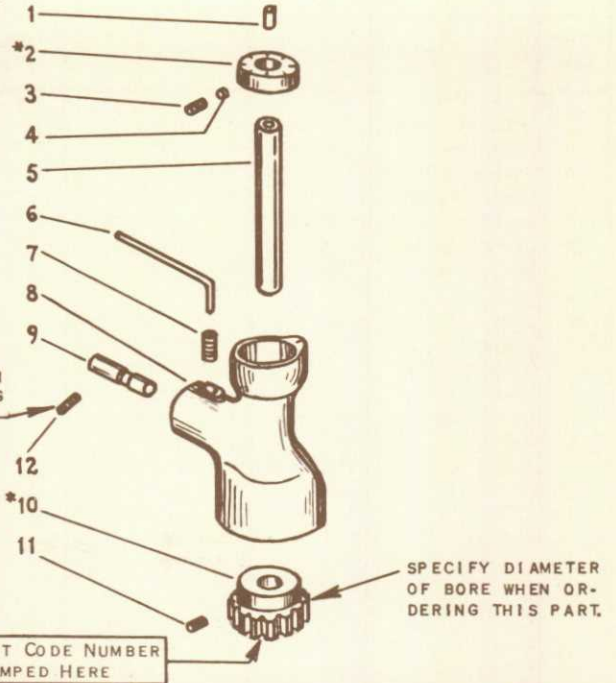

SET SCREW USED IN
APRON FOR LOCKING
INDICATOR.

SPECIFY DIAMETER
OF BORE WHEN OR-
DERING THIS PART.

UNIT CODE NUMBER
STAMPED HERE

9" & 10-K THREAD DIAL INDICATOR



9" & 10-K LARGE FACE PLATE
CATALOG NO. CL2180NK
WRITE FOR PRICE

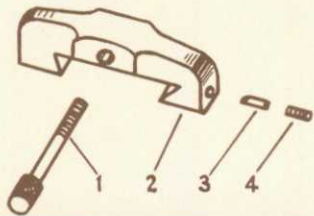

9" & 10-K THREAD CUTTING STOP

UNIT CODE NUMBER
STAMPED HERE

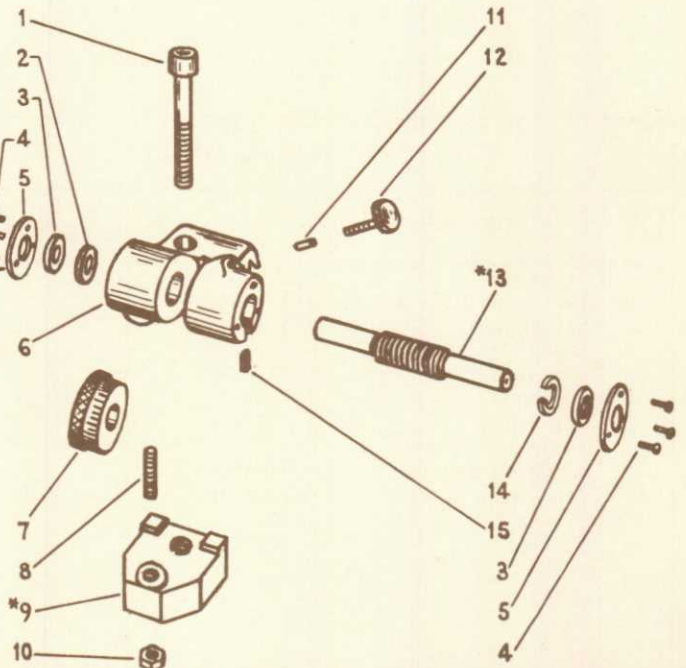

9" & 10-K MICROMETER CARRIAGE STOP

*AVAILABLE ONLY AS SUB-
ASSEMBLY. PARTS INCLUDED
ARE INDICATED BY THE ITEM
NUMBERS APPEARING IN PAR-
ENTHESIS AFTER PART NAME.

See List On Reverse Side

9" & 10-K MICROMETER CARRIAGE STOP			
ITEM NO.	PART NAME	PART NO.	PRICE EACH
1	CAP SCREW	114 x 124	\$.35
2	FELT WASHER	PT1207NT1	.05
3	BUSHING	PT1206NT1	.30
4	PHILLIP SCREW	104 x 206	.05
5	COVER PLATE	PT1209NT1	.55
6	MICROMETER STOP FRAME	PRICE ON REQUEST	
7	ORDER ITEM 13	PT1203NT2	---
8	SET SCREW	122 x 520	.10
9	CLAMP (8-10)	*AS1201NK1	1.30
10	JAM NUT	137 x 23	.25
11	SHOE	PT1083NT1	.45
12	LOCK SCREW	PT1204NT2	.40
13	SHAFT (7)	*AS1202NK2	4.75
14	FELT WASHER -- SLOTTED	PT1208NT1	.05
15	KEY	PT1210NH1	.10

9" & 10-K COLLET RACK			
ITEM NO.	PART NAME	PART NO.	PRICE EACH
1	COLLET RACK	PT780N2	\$13.75
1A	COLLET RACK	PT780KR2	19.60
2	RACK PIPE	PT497NK1	.95
3	COLLAR SCREW	PT371NK1	.55
4	BRACKET (3-*5-9)	*AS782NK1	5.25
5	CLAMP (6-7)	*AS863NR1	1.50
6	SET SCREW	122 x 624	.10
7	JAM NUT	137 x 25	.25
8	SET SCREW	122 x 505	.05
9	SQUARE HD. SET SCREW	118 x 108	.15
10	DRAW BAR HOOK	PT781NR & T1	1.15

9" & 10-K THREAD DIAL			
ITEM NO.	PART NAME	PART NO.	PRICE EACH
1	OILER	155 x 16	\$.20
2	INDICATOR DIAL (3-4)	*AS888NK2	3.10
3	SET SCREW	122 x 103	.05
4	SHOE	PT1078NK1	.05
5	INDICATOR SHAFT	PT891NK2	.95
6	WRENCH	CE2392	.07
7	SET SCREW	120 x 6	.15
8	INDICATOR FRAME	PRICE ON REQUEST	
9	MOUNTING STUD	PT889NK1	.95
10	WORM WHEEL (11)	*AS887NR2	4.15
11	SET SCREW	120 x 6	.15
12	SET SCREW	120 x 6	.15

9" & 10-K THREAD CUTTING STOP			
ITEM NO.	PART NAME	PART NO.	PRICE EACH
1	SCREW	PT249NR1	\$ 1.55
2	THD. CUTTING STOP	PT67NK1	4.00
3	BINDER PLUG	PT418NK1	.95
4	SET SCREW	122 x 606	.05

PRICES NET. F.O.B. SOUTH BEND, IND. (SUBJECT TO CHANGE WITHOUT NOTICE)

SERIAL NUMBER OF LATHE AND UNIT
CODE NUMBER 'MJST' ACCOMPANY ORDER

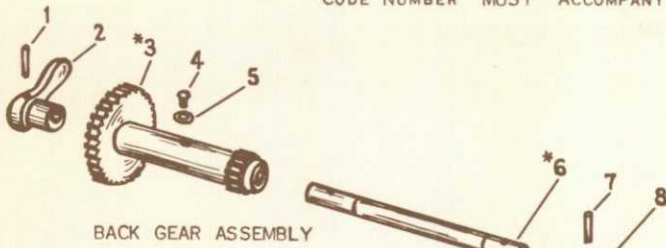

BACK GEAR ASSEMBLY

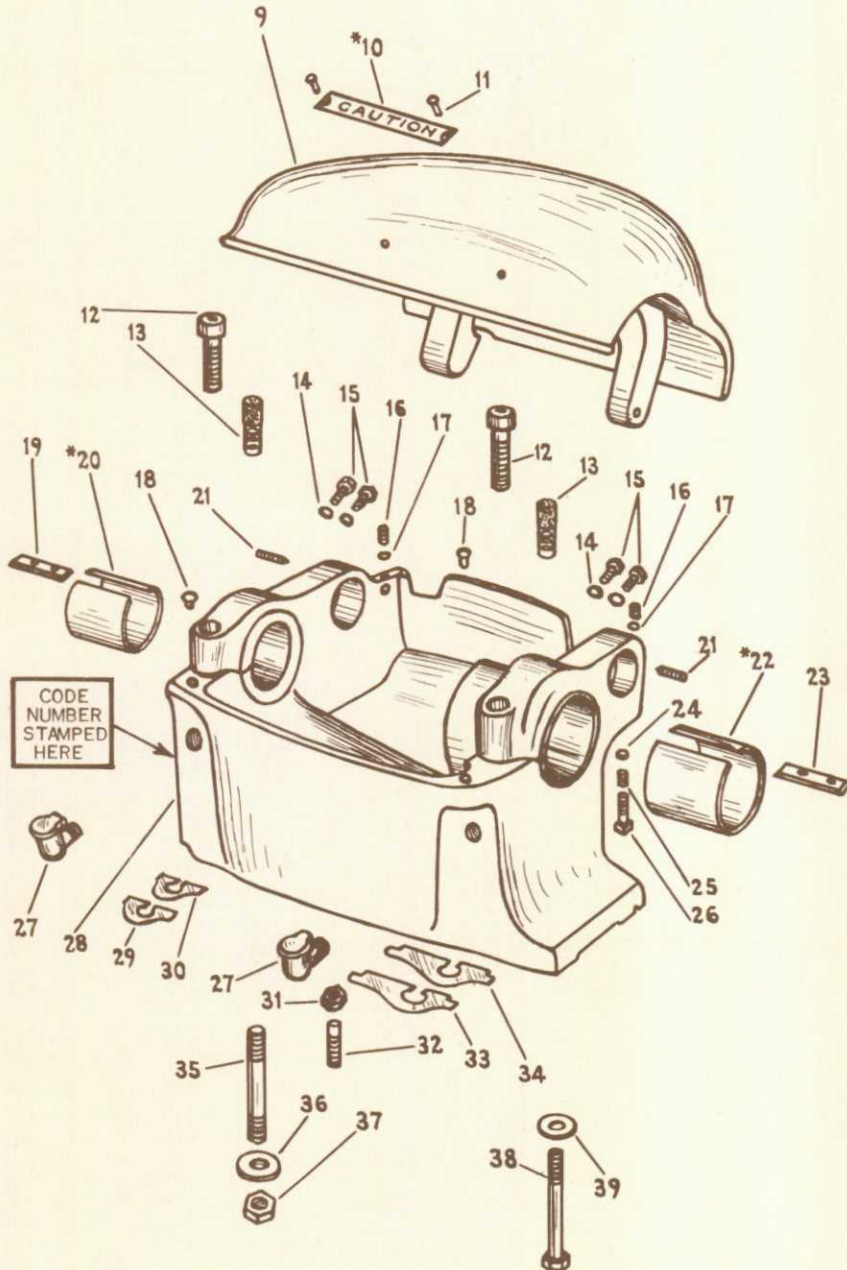

9" UNDERDRIVE HEADSTOCK
WITH SLEEVE BEARINGS
MODEL A, B, OR C

*AVAILABLE ONLY AS SUB-ASSEMBLY. PARTS INCLUDED ARE INDICATED BY THE ITEM NUMBERS APPEARING IN PARENTHESIS AFTER PART NAME.

ITEM NO.	PART NAME	PART NO.	PRICE EACH
1	TAPER PIN	168X312	\$.10
2	ORDER ITEM 6	-----	---
3	BACK GEARS (4-5)	*AS361NK 2	11.75
4	SCREW	PT1151N1	.05
5	WASHER	PT378NK 1	.05
6	ECCENTRIC SHAFT (1-2-7-8)		
7	TAPER PIN	*AS20 2NK 1 168X310	8.15 .10
8	ORDER ITEM 6	-----	---
9	CONE COVER	PT2576NK 1	19.60
10	CAUTION PLATE (11)	*AS258 3NK 1	.65
11	DRIVE SCREW	130X3	.05
12	CAP SCREW	114X220	.45
13	CAPILLARY OILER	AS373KH2	.30
14	WASHER	183X103	.05
15	SCREW	PT1165RH1	.05
16	HINGE SCR. LOCK SCR.	122X106	.10
17	SHOE	PT1080NK 1	.05
18	RUBBER BUMPER	PT387NK 1	.05
19	EXPANDER (SMALL)	PT523K 2	1.55
20	SMALL BEARING (13-14-15-19-29-30)	*AS512K 1	16.50
21	GUARD HINGE SCREW	121X12	.25
22	LARGE BEARING (13-14-15-23-33-34)	*AS511K 1	17.75
23	EXPANDER (LARGE)	PT524K 2	1.80
24	SHOE	PT1075NR 1	.05
25	SPRING	PT374NR 1	.05
26	SCREW	PT376NR 1	.05
27	OILER	PT2676NK 1	.70
28	U. D. HEADSTOCK	WRITE FOR INFORMATION	
29	SOLID SHIM (SMALL)	PT366K 1	.30
30	LAMINATED SHIM (SMALL)	PT365K 1	.45
31	NUT	139X26	.05
32	STOP SCREW	PT377NR 1	.10
33	SOLID SHIM (LARGE)	PT364K 1	.45
34	LAMINATED SHIM (LARGE)	PT363K 1	.55
35	CLAMPING STUD	PT385NK 1	.30
36	WASHER	PT1672NK 1	.05
37	NUT	138X27	.05
38	SCREW	112X248	.15
39	WASHER	PT1672NK 1	.05
40	NUT	137X29	.15
41	REVERSE GEAR	PT28NK 1	3.10
42	FELT WICK	256X1	.10
43	-----	-----	-----
44	TWIN GEAR	PT27K32NK 1	3.00
45	FELT WICK	256X14	.30
46	REVERSE BRACKET (45-53-*60)	*AS635K 2	29.10
47	NUT	139X25	.05
48	FELT WICK	256X3	.10
49	REVERSE SHAFT (40)	*AS637NK 1	3.05
50	LOCK BUSHING	PT2585K 2	.85
51	SNAP RING	PT409T 1	.05
52	TWIN GEAR STUD (42-47)	*AS229K 1	3.45
53	OILER	155X20	.25
54	PIN	PT2584K 1	.05
55	BUSHING	PT2586K 1	.55
56	SPRING	162X35	.05
57	PLUNGER KNOB	PT88NK 2	1.20
58	PLUG	PT150 1	.05
59	KEY	164X85	.25
60	REVERSE PLUNGER (54-55-56-57-61)	*AS640K 1	2.55
61	PIN	160X10	.05
62	REV. BRACKET ASSEMBLY (41-44-*46-48-*49-50 51-*52-58-59)	*AXS635K 2	52.75
63	TAKE UP NUT (64-76)	*AS25NK 2	2.15
64	TAKE UP WASHER	PT26NK 2	.10
65	THRUST BEARING	PT207NK 1	9.80
66	CONE (67)	*AS14NK 1	23.60

CONTINUED ON REVERSE SIDE

ITEM NO.	PART NAME	PART NO.	PRICE EACH
67	OIL PLUG SCREW	PT38 1NH1	\$.10
68	BULL GEAR (69-70)	*AS15NK1	7.95
69	SPRING	PT367NR1	.05
70	PLUNGER	PT214NR2	1.80
71	SPINDLE	PT200N2	36.00
72	PROTECTING RING	PT370K1	.70
73	FACE PLATE 5 1/8" O.D.	CL2175NK	7.25
74	SPINDLE SLEEVE	CL205NK	2.60
75	CENTER	CE2401	3.00
76	SCREW	PT382NK1	.10
77	KEY	PT2090	.25
78	CONE (67-79-80)	*AS432NK1	42.75
79	PIN	160X23	.05
80	"V"-CONE PINION	PT433NK1	5.90

SERIAL NUMBER OF LATHE AND UNIT CODE NUMBER 'MUST' ACCOMPANY ORDER

SEE REVERSE SIDE FOR LOCATION OF CODE NUMBER

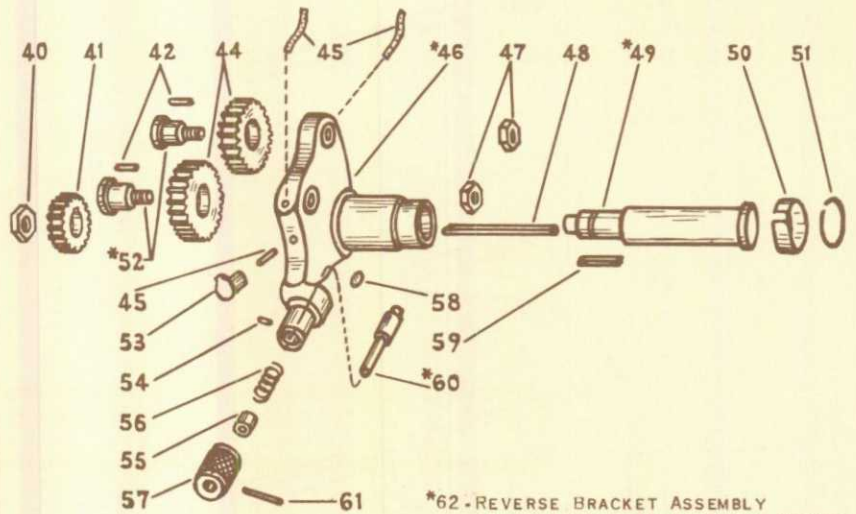

REVERSE BRACKET ASSEMBLY

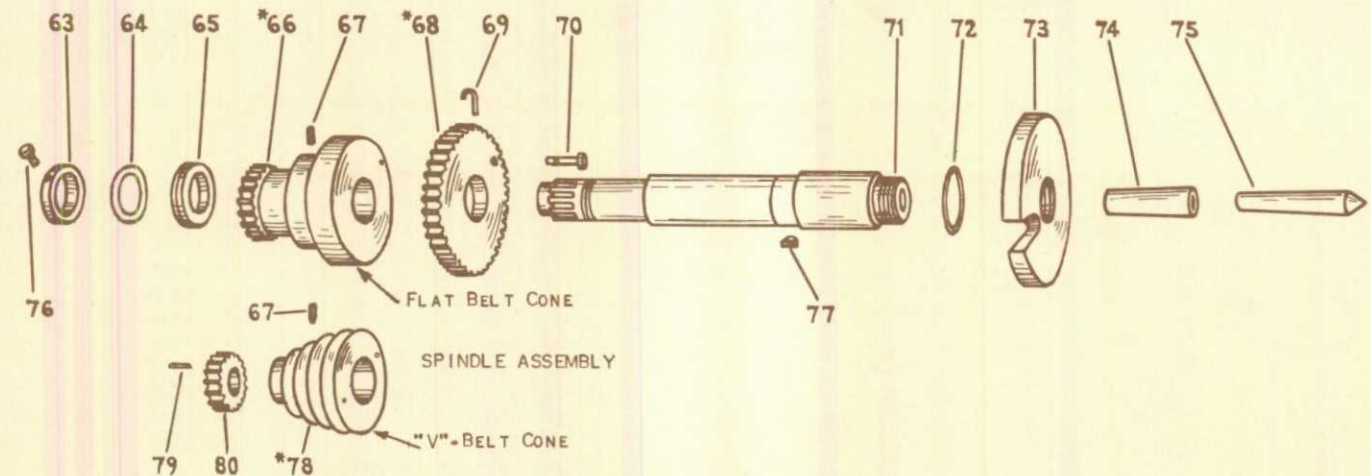

9" UNDERDRIVE HEADSTOCK
WITH SLEEVE BEARINGS
MODEL A, B, OR C

*AVAILABLE ONLY AS SUB-ASSEMBLY. PARTS INCLUDED ARE INDICATED BY THE ITEM NUMBERS APPEARING IN PARENTHESIS AFTER PART NAME.

UNIT CODE NUMBER
STAMPED HERE

DIRECT READING GRADUATED COLLARS - EACH GRADUATION REPRESENTS A MOVEMENT OF THE CROSS SLIDE OF .0005" OR A REDUCTION IN THE DIAMETER OF THE WORK OF .001". (FURNISHED ONLY IN LARGE DIAMETER SIZE.)

SERIAL NUMBER OF LATHE AND UNIT CODE NUMBER "MUST" ACCOMPANY ORDER

TOP VIEW OF SADDLE SHOWING LOCATION OF CODE NUMBER

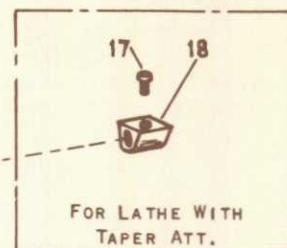
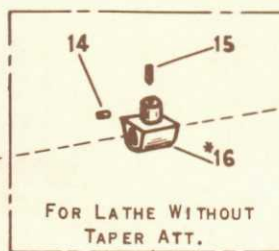
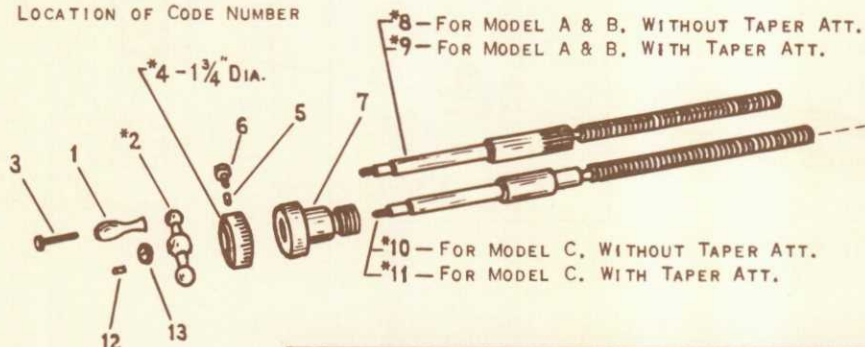

9" & LIGHT 10 CROSS FEED SCREW-DIRECT READING COLLAR
FOR MODEL A, B & C

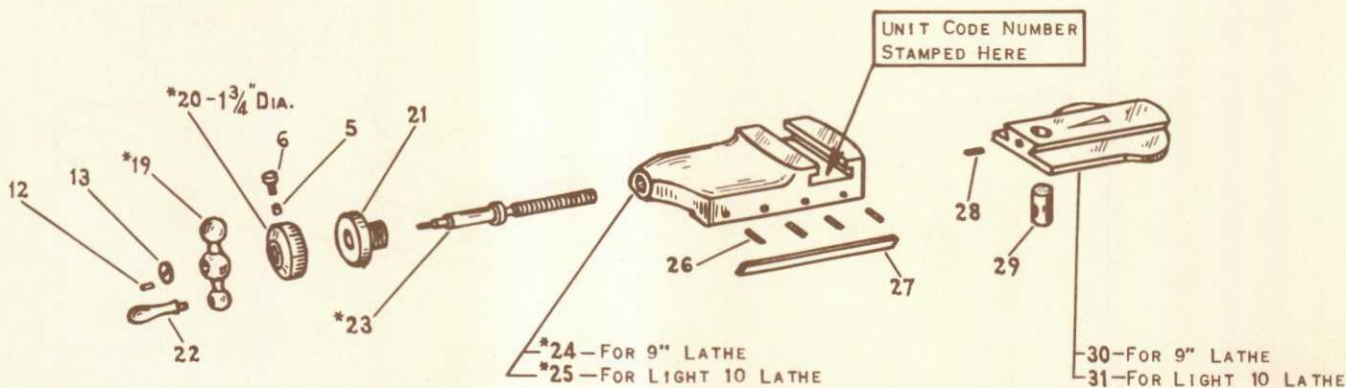

9" & LIGHT 10 COMPOUND REST TOP-DIRECT READING COLLAR
FOR MODEL A, B & C

*AVAILABLE ONLY AS SUB-ASSEMBLY. PARTS INCLUDED ARE INDICATED BY THE ITEM NUMBERS APPEARING IN PARENTHESIS AFTER PART NAME.

ITEM NO.	PART NAME	PART NO.	PRICE EACH	ITEM NO.	PART NAME	PART NO.	PRICE EACH
1	HANDLE, SWIVELING	PT1491	\$ 1.30	19	COMP. REST BALL		
2	C.F. BALL CRANK (1-3)	*AS1264NK1	3.95	20	C.R. COLLAR (5-6)	*AS277NR1	\$ 2.85
3	HANDLE STUD	PT1241	.45	21	COMP. REST BUSHING	*AS1269NR1	3.80
4	C.F. COLLAR (5-6)	*AS1266NK1	3.35	22	HANDLE, SOLID	PT94NR2	2.20
5	SHOE	PT1086-1	.05	23	COMP. REST SCREW (12 13-*19-*20-21-29)	PT1480-1	.55
6	THUMB SCREW	PT4921S1	.35	24	COMP. REST TOP, 9" (*23-26-27-28-30)	*ASD230NK3	14.70
7	C.F. BUSHING	PT63NK2	3.85	25	COMP. REST TOP, LT. 10- (*23-26-27-28-31)	*ASD90N1	35.70
8	C.F. SCREW (*2-7-12 13-*4-*16)	*ASD224NK3	19.15	26	SCREW	*ASD90K1	37.20
9	C.F. SCREW (*2-7-12 13-*4-17-18)	*ADTA224NK3	19.50	27	COMP. REST GIB	122x444	.05
10	C.F. SCREW (*2-7-12 13-*4-*16)	*ASD224JNK3	19.15	28	SCREW	PT257NK1	.55
11	C.F. SCREW (*2-7-12 13-*4-17-18)	*ADTA224JNK3	19.50	29	COMP. REST NUT	122x508	.10
12	PIN	160x17	.05	30	COMP. REST SWIVEL	PT95NK1	1.55
13	RETAINING NUT	PT295NR1	.10	31	COMP. REST SWIVEL	PT91N1	10.35
14	PIN	PT358NK1	.05			PT91K1	11.85
15	SCREW	PT359NK1	.05				
16	C.F. NUT (14-15)	*AS65NK1	1.95				
17	SCREW	PT66NK1	.50				
18	C.F. NUT	PT486NK1	1.80				

PRICES NET. F.O.B. SOUTH BEND, IND. (SUBJECT TO CHANGE WITHOUT NOTICE)

SOUTH BEND LATHE, INC. 425 E. Madison St., South Bend 22, Indiana, U.S.A.

Printed in U.S.A.

UNIT CODE NUMBER
STAMPED HERE

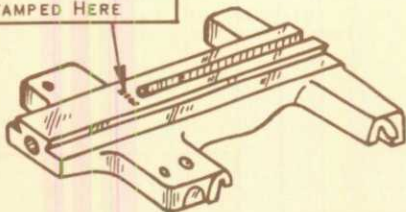

SERIAL NUMBER OF LATHE AND UNIT
CODE NUMBER "MJST" ACCOMPANY ORDER

TOP VIEW OF SADDLE SHOWING
LOCATION OF CODE NUMBER

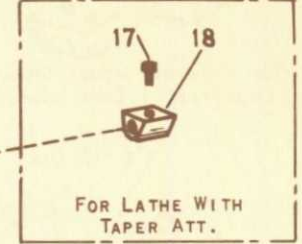
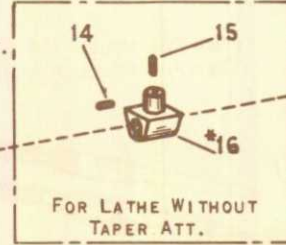
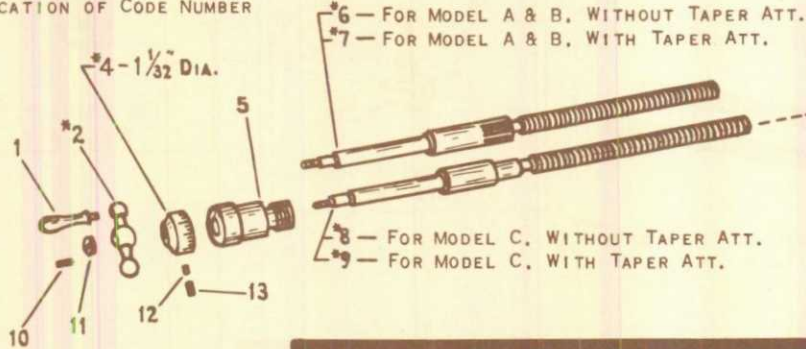

9" & LIGHT 10 CROSS FEED SCREW-METRIC COLLAR
FOR MODEL A, B & C

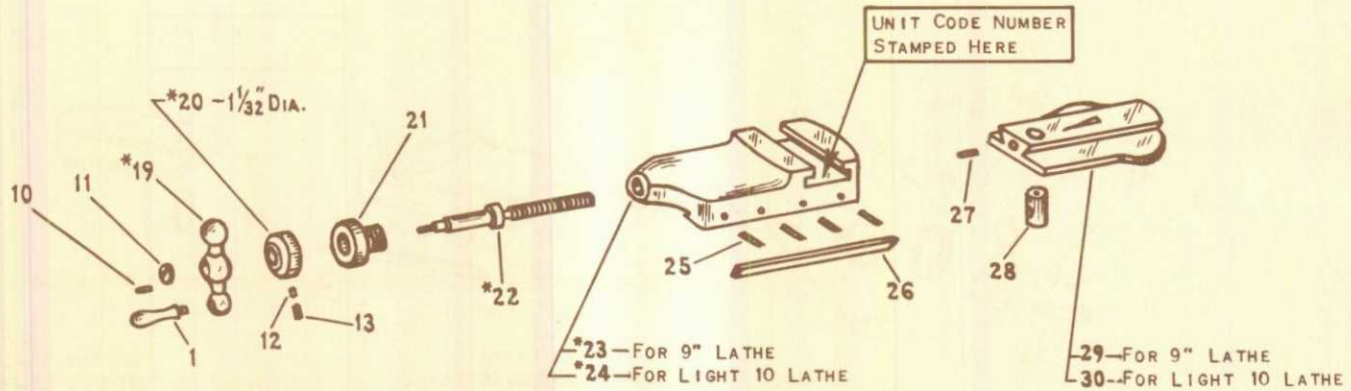

9" & LIGHT 10 COMPOUND REST TOP-METRIC COLLAR
FOR MODEL A, B & C

ITEM NO.	PART NAME	PART NO.	PRICE EACH	ITEM NO.	PART NAME	PART NO.	PRICE EACH
1	HANDLE, SOLID	PT1480-1	\$.55	19	C.R. BALL CRANK(1)	*AS277NR1	\$ 2.85
2	C.F. BALL CRANK(1)	*AS276NK1	1.90	20	C.R. COLLAR(12-13)	*AS2235NK1	1.95
3				21	C.R. BUSHING	PT94NK1	1.95
4	C.F. COLLAR(12-13)	*AS2232NK1	2.40	22	C.R. SCREW(10-11- *19-*20-21-28)	*AS2233NK1	12.30
5	C.F. BUSHING	PT63NK1	3.00	23	C.R. TOP, 9" (*22- 25-26-27-29)	*ASM9ON1	33.30
6	C.F. SCREW(*2-5-10 11-*4-*16)	*AS2230NK1	15.25	24	C.R. TOP, LT. 10 (*22-25-26-27-30)	*ASM9OK1	34.80
7	C.F. SCREW(*2-5-10 11-*4-17-18)	*ATA2230NK1	15.65	25	SCREW	122x444	.05
8	C.F. SCREW(*2-5-10. 11-*4-*16)	*AS2230JNK1	15.25	26	C.R. GIB	PT257NK1	.55
9	C.F. SCREW(*2-5-10 11-*4-17-18)	*ATA2230JNK1	15.65	27	SCREW	122x508	.10
10	PIN	160x17	.05	28	COMP. REST NUT	PT2234NK1	1.55
11	RETAINING NUT	PT295NR1	.10	29	C.R. SWIVEL, 9"	PT91N1	10.35
12	SHOE	PT1076NR1	.05	30	C.R. SWIVEL, LT. 10	PT91K1	11.85
13	SCREW	122x103	.05				
14	PIN	PT358NK1	.05				
15	SCREW	PT359NK1	.05				
16	C.F. NUT (14-15)	*AS2231NK1	1.95				
17	SCREW	PT66NK1	.50				
18	C.F. NUT	PT2272NK1	1.80				

*AVAILABLE ONLY AS SUB-
ASSEMBLY. PARTS INCLUDED
ARE INDICATED BY THE ITEM
NUMBERS APPEARING IN PAR-
ENTHESIS AFTER PART NAME.

PRICES NET. F.O.B. SOUTH BEND, IND. (SUBJECT TO CHANGE WITHOUT NOTICE)

STANDARD GRADUATED COLLARS - EACH GRADUATION REPRESENTS A MOVEMENT OF THE CROSS SLIDE OF .001" OR A REDUCTION IN THE DIAMETER OF THE WORK OF .002".

DIRECT READING GRADUATED COLLARS - EACH GRADUATION REPRESENTS A MOVEMENT OF THE CROSS SLIDE OF .0005" OR A REDUCTION IN THE DIAMETER OF THE WORK OF .001".

UNIT CODE NUMBER
STAMPED HERE

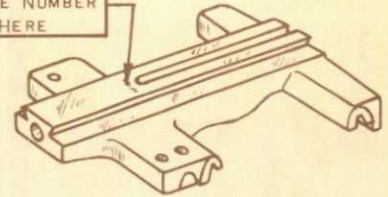

TOP VIEW OF SADDLE SHOWING LOCATION OF CODE NUMBER

- *14-FOR MODEL A & B WITH STANDARD GRAD. COLLAR-WITHOUT TAPER ATT.
- *15- " " " " " " " " " " -WITH TAPER ATT.
- *16- " " " " " " DIR. RDG. " " " -WITHOUT TAPER ATT.
- *17- " " " " " " " " " " " -WITH TAPER ATT.

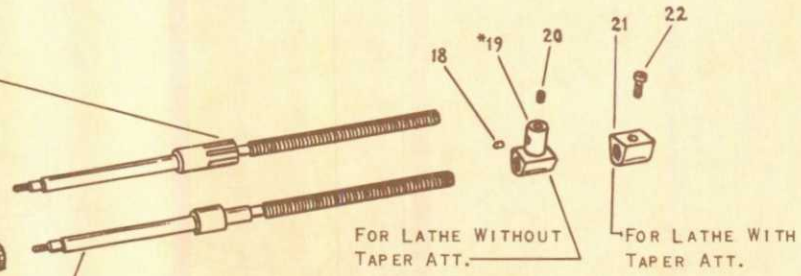
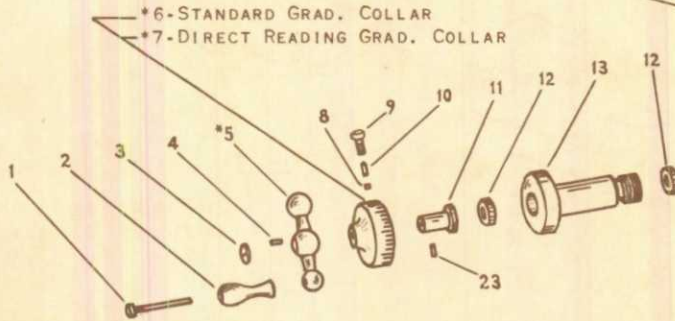

- *24-FOR MODEL C WITH STANDARD GRAD. COLLAR-WITHOUT TAPER ATT.
- *25- " " " " " " " " " " -WITH TAPER ATT.
- *26- " " " " " " DIR. RDG. " " " -WITHOUT TAPER ATT.
- *27- " " " " " " " " " " " -WITH TAPER ATT.

SERIAL NUMBER OF LATHE AND UNIT CODE NUMBER "MUST" ACCOMPANY ORDER

9" & LIGHT 10 CROSS FEED SCREW-LARGE DIA. (1 3/4") COLLAR
STANDARD AND DIRECT READING GRADUATIONS FOR MODEL A, B, AND C

*AVAILABLE ONLY AS SUB-ASSEMBLY. PARTS INCLUDED ARE INDICATED BY THE ITEM NUMBERS APPEARING IN PARENTHESIS AFTER PART NAME.

ITEM NO.	PART NAME	PART NO.	PRICE EACH	ITEM NO.	PART NAME	PART NO.	PRICE EACH
1	STUD	PT1241	\$.45	19	CROSS FEED NUT (18-20)	*AS65NK1	\$ 1.95
2	HANDLE	PT1491	1.30	20	SCREW	PT359NK1	.05
3	RETAINING NUT	PT295NR1	.10	21	CROSS FEED NUT	PT486NK1	1.80
4	PIN	160X17	.05	22	SCREW	PT66NK1	.50
5	BALL CRANK (1-2)	*AS1264NK1	3.95	23	PIN	160X247	.05
6	GRADUATED COLLAR (8-9-10)	*AS64NK2	3.50	24	CROSS FEED SCREW (3-4-*5-*6-11-12-13-*19-23)	*AS224JNK4	22.70
7	GRADUATED COLLAR (8-9-10)	*AS1266NK2	3.95	25	CROSS FEED SCREW (3-4-*5-*6-11-12-13-21-22-23)	*ATA224JNK4	23.05
8	SHOE	PT1080NK1	.05	26	CROSS FEED SCREW (3-4-*5-*7-11-12-13-*19-23)	*ASD224JNK4	23.15
9	THUMB SCREW	PT1857	.35	27	CROSS FEED SCREW (3-4-*5-*7-11-12-13-21-22-23)	*ADTA224JNK4	23.50
10	PIN	160X16	.05				
11	C. F. SLEEVE	PT69R1	1.20				
12	BEARING	AS841R1	1.70				
13	CROSS FEED BUSHING	PT63NK3	3.85				
14	CROSS FEED SCREW (3-4-*5-*6-11-12-13-*19-23)	*AS224NK4	22.70				
15	CROSS FEED SCREW (3-4-*5-*6-11-12-13-21-22-23)	*ATA224NK4	23.05				
16	CROSS FEED SCREW (3-4-*5-*7-11-12-13-*19-23)	*ASD224NK4	23.15				
17	CROSS FEED SCREW (3-4-*5-*7-11-12-13-21-22-23)	*ADTA224NK4	23.50				
18	PIN	PT358NK1	.05				

PRICES NET F.O.B. SOUTH BEND, IND. (SUBJECT TO CHANGE WITHOUT NOTICE)

27 THREADS PER INCH

It is possible to cut 27 threads per inch on any South Bend Lathe by procuring an additional gear. Our present 9" and Light Ten Models B & C Lathes and 10"-1" Collet Lathes with wide range gear box are already equipped to cut 27 threads. For other South Bend Lathes see list below:

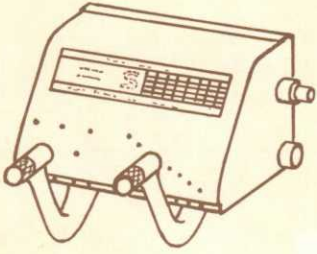
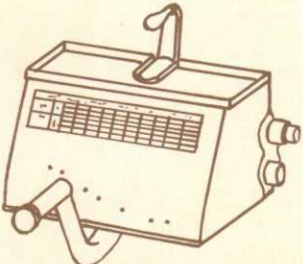
	SIZE AND TYPE OF LATHE	PART NO.	PRICE EACH
	DOUBLE TUMBLER GEAR BOXES		
	9" & Lt. 10, Model A, Double Tumbler. . .	PT32K42NK1	\$3.60
	10" (11/16 or 1" Col. Cap.) Double Tumbler	PT32K42R1	4.20
	13" Double Tumbler	PT612K32T1	8.20
	14½", 16" 16-24" & 2H Double Tumbler		
	For Gear Box Code No. Q.C.G. 103...	PT612K32FH2	9.35
	For Gear Box Code No. D.T.G. 104...	PT612K32FH3	9.35
	SINGLE TUMBLER GEAR BOXES		
	10" (11/16 or 1" Col. Cap.) Single Tumbler	PT612K32R1	7.05
	13" Single Tumbler	PT612K24T1	7.45
	14½", 16", 16-24" & 2H Single Tumbler . .	PT612K24FH1	8.95
SEE REVERSE SIDE FOR SET-UP CHART			
Prices Net f.o.b. South Bend, Indiana. (Subject to change without notice.)			

IMPORTANT. When ordering you must specify "Gear is to be used to cut 27 threads per inch." Also state serial number of your lathe which is stamped on flat way of bed at tailstock end and gear box code number stamped on face of tumbler guide bar attached to bottom of gear box. This information enables us to double check and to determine if correct gear is being ordered.

SET-UP CHART FOR
CUTTING 27 THREADS PER INCH

DOUBLE TUMBLER GEAR BOX

Stud Gear { 9" & Lt. 10 requires 20 Tooth Gear. Furnished With Lathe
10" (1" Col.) requires 20 Tooth Gear. Furnished With Lathe
13" requires 32 Tooth Special Gear, PT612K32T1
14½", 16", 16-24" & 2H requires 32 Tooth Special Gear. Use PT612K32FH2 Gear on lathes with Gear Box Code QCG103. For lathes with Gear Box Code DTG104 use PT612K32FH3 Gear

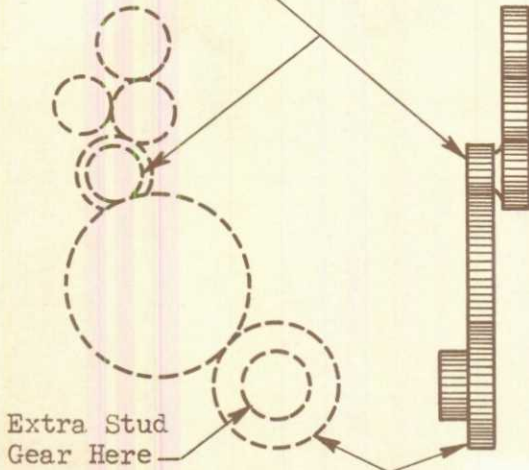

Stud Gear	Left Hand Tumbler	Threads Per Inch							
See Note Above	A								
	A								
	B								
	C		27						
	D								
	E								

Gear Box Gear { 9" & Lt. 10 requires 42 Tooth Special Gear, PT32K42NK1
10" (1" Col.) requires 42 Tooth Special Gear, PT32K42R1
13" requires 64 Tooth Gear. Furnished On Lathe
14½", 16", 16-24 and 2H requires 64 Tooth Gear. Furnished On Lathe

SINGLE TUMBLER GEAR BOX

Stud Gear { 10" Lathe requires 32 Tooth Special Gear, PT612K32R1
13" Lathe requires 24 Tooth Special Gear, PT612K24T1
14½", 16", 16-24 and 2H Lathes requires 24 Tooth Special Gear, PT612K24FH1

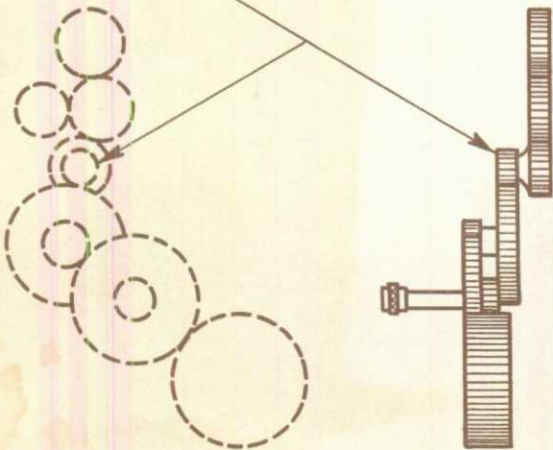

Sliding Gear	Top Lever	Threads Per Inch							
In	Left								
	Center								
	Right								
Out	Left		27						
	Center								
	Right								