

OPERATING INSTRUCTIONS  
AND PARTS LIST FOR  
**WEN-SAW MODEL 909**



### Guarantee

*The Wen-Saw Model 909 was thoroughly checked and tested before shipment, and is guaranteed against defective material or workmanship for a period of 90 days from date of purchase.*

*Should trouble develop, return saw to the dealer from whom it was purchased or prepaid direct to the factory or authorized service station. If our inspection shows that the trouble was caused by defective material or workmanship, we will make all repairs free of charge, f.o.b. our factory. Repairs made necessary by normal wear, abuse, or out of warranty, will be charged for at our regular repair prices.*

*With good care and proper use you will have many years of trouble-free service from your Wen Saw.*

**WEN PRODUCTS, INC.**

5810 NORTHWEST HIGHWAY

CHICAGO 31, ILLINOIS

## OPERATING INSTRUCTIONS

### Power Supply —

This electric saw has a Universal motor and can be operated on 110-120 v. 25-60 cycles A.C. or 110-120 v. D.C.

### Saw Blades —

Packed with this saw is a package containing seven blades, each of which is especially designed to do an excellent cutting job for specific types and sizes of materials. With the full complement of all seven blades, this saw will do an amazing job of cutting almost any material. Instructions for proper selection of the correct blade are packed in the blade package.

To attach blades, loosen both set screws and insert blade as far as it will go. Tighten set screws firmly against blade using wrench provided.

### Operation —

Grasp handle of saw firmly, rest the front of the guide plate on the work and align the blade with cutting line scribed on the work. Press switch button to ON position, apply *FIRM* downward pressure on the guide plate and move the saw forward with enough pressure to permit the blade to cut freely. For best results work should be held firmly in place either by clamping or otherwise holding. Do not remove saw from work without first shutting off motor.

To self-start an inside cut, place front end of guide plate on work with saw tilted forward at 90° angle from upright position, hold with *FIRM* downward pressure. Turn on power and tilt saw gradually backward until blade contacts work at point of cut. Continue tilting blade into work until blade cuts clear through work.

### Lubrication and Cleaning —

The bearings and gears at the blade end are in a permanently sealed grease chamber—and will not require further lubrication under normal use conditions. The bearing at the other end, however, should be oiled every three months. Use a few drops of S.A.E. 20 oil. *Avoid using too much oil*; the commutator must be kept oil free. Keep the motor housing free of sawdust by blowing it out regularly with dry compressed air.

### Replacing Brushes —

Replacement of worn brushes will be a big help in getting full power from your Saw, and will prolong armature life. These relatively inexpensive parts should be replaced when worn to about 1/8-inch length. Always replace them in pairs.

To remove Brush Assemblies simply remove the Brush Caps. When removing them for inspection, always replace them in the same position—and on the same side from which removed.

### Grounding Caution —

To safeguard the user against electric shock, the metal housing should be grounded whenever your Saw is in use. **THIS IS ABSOLUTELY ESSENTIAL IF THE USER IS IN DAMP OR WET SURROUNDINGS.**

The Wen 909 saw is equipped with a 3-wire conductor which automatically grounds the metal housing when plugged into the proper 3-way receptacle. When using the adapter to plug into a 2-way receptacle the pig-tail wire should be connected to the metal conduit carrying the electrical wires. "Except in Canada."

When using an extension cord, a 3-wire conductor cord with proper ground connections should be used. We recommend No. 12 or larger wire for the extension cord up to 100 feet and No. 10 or larger for up to 150 feet.

## HOW TO ORDER REPAIR PARTS—

All parts listed herein may be ordered either through your dealer, authorized service station, or direct from the factory. When ordering parts by mail, always give the model number, the part number and the part description.

Your parts order will be expedited if you will enclose, with order, your check or money order to cover parts, plus postage.

### PARTS AND PRICE LIST FOR WEN-SAW MODEL 909

<i>Ref. No.*</i>	<i>Part No.</i>	<i>Description</i>	<i>List Price</i>
1	90A1	Motor Housing .....	\$ 3.75
2	90A2	Handle Cover .....	.75
3	90A3	Gear Housing (complete with bearings).....	4.70
4	90A11	Gear Housing Cover .....	.60
5	90A4C	Spur Gear (complete with shaft, drive pin, and counterweight) .....	3.80
6	90A5	Armature .....	11.00
7	90A6	Field Assembly .....	8.00
8	90A7	8' 3-conductor cord set.....	2.20
10	90A9	Brush cap .....	.40
11	90A10	Switch .....	4.20
12	90A19	Needle Bearing .....	1.30
13	90A20	Pinion Shaft Bearing (Oilite).....	.30
14	90A21	Base Plate .....	1.85
15	90A22	Drive shaft bearings .....	.35
16	90A23C	Drive Shaft Complete with cross-slide, slotted plug, collar, set screws, and 1 bearing.....	3.90
17	90A28	Set screw Allen wrench.....	.10
18	90A31	Drive roller .....	.30
19	90A46C	Brush Holder Assembly .....	.50
20	90A48	Brush (with spring ) .....	.50
21	90A53	Auxiliary Knob .....	.50
22	90A58	Air turbulence ring .....	.30
23	90A102	Rear armature shaft bearing.....	.30
24	90A107	Guide bar .....	1.00
39	90A114	Blade Guard .....	.30
	900	1 ea. blades Nos. 91, 92, 93, 94, 95, 96, 97.....	3.40
	901	3 ea. blades No. 91 (3 teeth per inch—very fast rough cuts)	1.80
	902	3 ea. blade No. 92 (5 teeth per inch—fast rough cut)....	1.50
	903	3 ea. Blade No. 93 (8 teeth per inch—medium cut).....	1.20
	904	3 ea. Blade No. 94 (14 teeth per inch—fine scroll work)..	1.20
	905	3 ea. Blade No. 95 (Knife blade).....	1.20
	906	3 ea. Blade No. 96 (14 teeth per inch—high speed steel).	1.80
	907	3 ea. Blade No. 97 (32 teeth per inch—high speed steel —extra fine cuts) .....	1.80

\*Refers to Number of part on diagram on back page

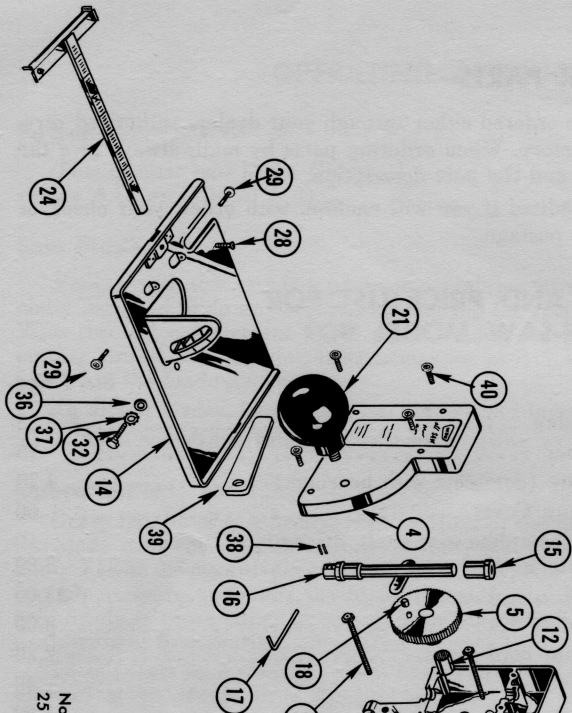

**IDENTIFICATION NUMBERS  
1 THROUGH 24 AND 39\*  
DESCRIBED ON PAGE 3**

**MISCELLANEOUS PARTS**

No. Part No. Description  
25 - 90A62 - Loading Spring Washers

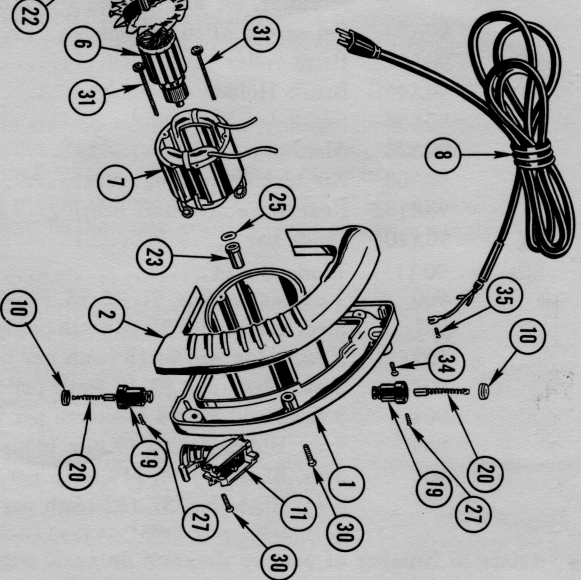

**HARDWARE - STANDARD PARTS**

No.	Part No.	Description
27	90A13	Socket Head Set Screw Cup Point
28	90A14	8-32 x 1/4 Round Head Screw
29	90A15	Dog Point Screw
30	90A16	8-32 x 1 1/8 Self Tapping Screw
31	80A32	10-32 x 3/8 Machine Screw
32	90A18	10-32 x 2 1/4 Machine Screw
33	90A22	8-18 x 5/8 Self Tapping Screw
34	90A30	6-20 x 5/16 Self Tapping Screw
35	90A32	No. 10 Flat Washer
36	90A26	No. 10 Flat Washer
37	90A117	No. 10 External Tooth Lockwasher
38	90A125	8-32 x 1/4 Nylon Socket Head Set Screw Cup Point
40	91A43	8-18 x 3/4 Self Tapping Screw