

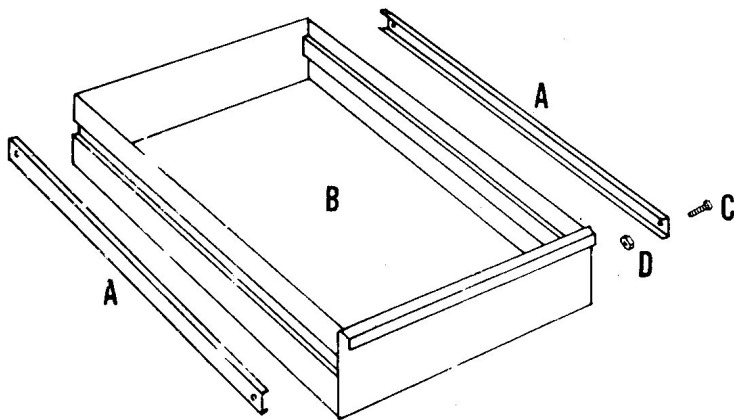

# R 9362 CABINET ASSEMBLY INSTRUCTIONS

Numbers Denote Assembly Sequence  
(See reverse side for details)

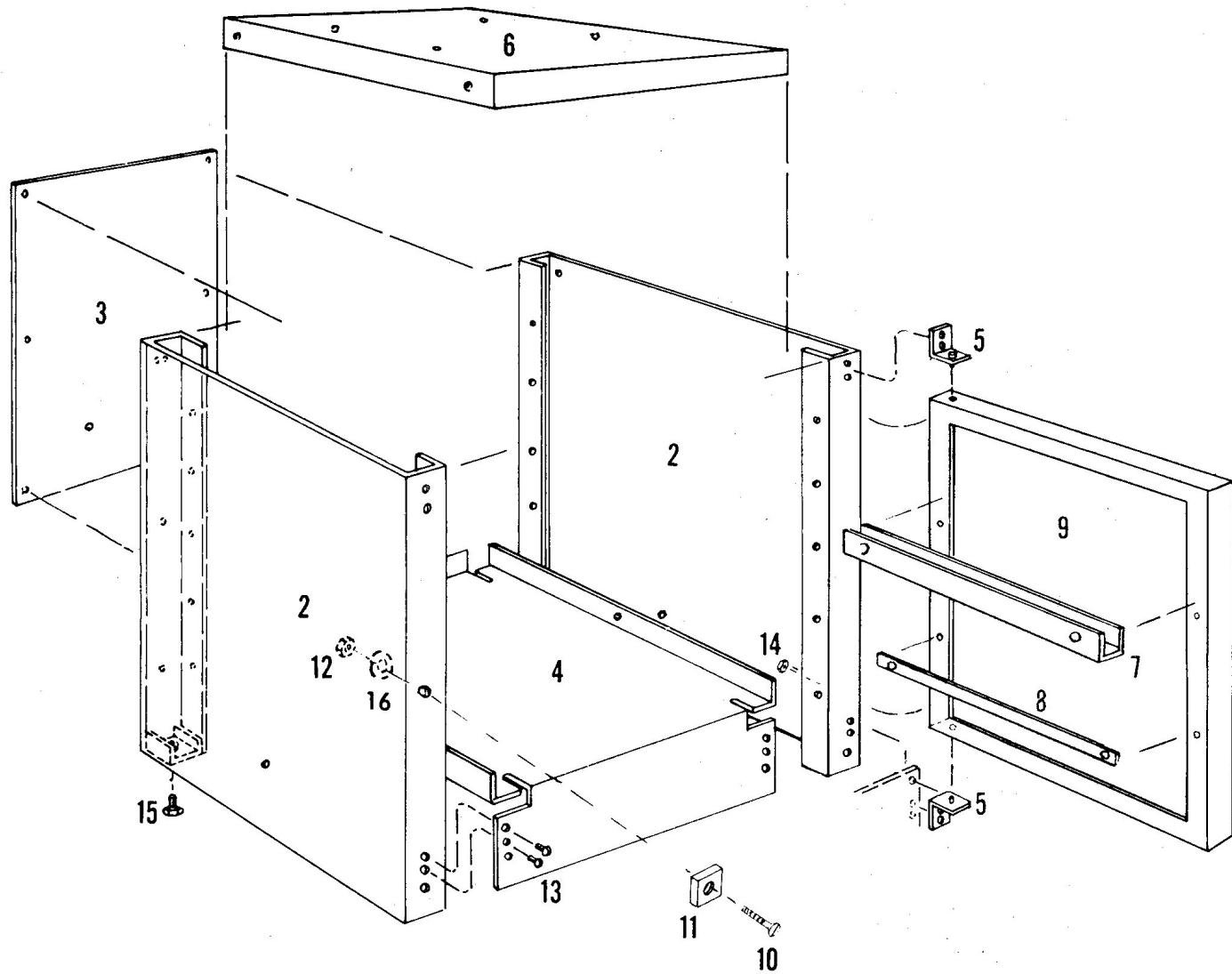

R 9361  
Utility Drawer

# ASSEMBLY SEQUENCE

**DeWALT MODEL R 9362 CABINET AND R 9361 UTILITY DRAWER GENERAL INFORMATION**—The hex head machine screws and hex nuts used for the cabinet assembly are all the same size ( $\frac{1}{4}$ -20 X  $\frac{1}{2}$  inches long). When assembling the cabinet the screws should be inserted from the outside and secured with the hex nut on the inside.

## I. TO ASSEMBLE CABINET

1. Place the two side panels in standing position approximately 22 inches apart.
2. Attach back panel (3) to side panels (1) and (2) using four screws and hex nuts only in the two top and two bottom corner holes (make sure end of back panel with the four holes is at the bottom).
3. Insert shelf (4) into top of cabinet.  
Tilt shelf front upward to allow it to pass over the back two corner screws, then level out as you lower into position. The back flange of the shelf should rest on the two bottom back panel screws.
4. Insert four screws through back and side panels into holes in shelf and secure with hex nuts. Insert screws into the two remaining center holes in the back panel and secure to side panels with hex nuts.
5. Assemble the hinge (5) to top right-hand panel flange, make sure top of hinge is flush with top of cabinet flange and secure with screws and hex nuts.
6. Remove the two top corner screws from back panel. Place top (6) on the cabinet with the flange having no holes facing the front of cabinet. Secure with screws and hex nuts in the back and side panels.
7. Place cabinet on its back. Mount door (9) to the top hinge. Insert bottom hinge (5) into door and attach hinge to the bottom of right side panel using the two upper holes. (Hinge mounts on the top of the shelf flange.) Adjust bottom hinge up or down and right or left so that the door is square with the outside edges of the cabinet and swings freely.
8. Insert screws into the remaining front shelf flange holes and tighten securely with hex nuts.
9. Insert the four adjustment feet (15) into the mounting holes in the bottom of the cabinet and place the cabinet in the upright position on its feet.
10. Assemble the door shelves (7) and (8) to the door (9) making sure the shelves are placed in back of the door flange and secure with screws and hex nuts.
11. Attach the magnetic latch (11) to the center hole in the left side panel with flat head screw (10)) and secure with washer and special hex nut. (Be sure screw head is flush with magnetic latch surface.)
12. After the cabinet is completely assembled adjust to floor level by means of the adjustable feet, using a spirit level on top of the cabinet. To assure perfect levelness, it is recommended that the level be placed in two positions (corner to corner in each direction) and adjustment to feet be made accordingly. It is also suggested that the level be used against both sides, front and back. This will assure that the cabinet parts are properly assembled and matching parts are square with each other.

## II. RECHECK ALL HARDWARE TO BE SURE IT IS TIGHT

Your DeWalt may now be mounted to the top of the cabinet using the remaining four screws and hex nuts. Attaching the machine could slightly change the level of your machine table top. It is suggested you recheck "Adjusting Table Top Parallel With Arm" as described in your machine instruction book.

### R - 9361 UTILITY DRAWER

## III. GENERAL INFORMATION

Additional channel mounting holes predrilled at the factory are provided in the side panels of the cabinet. These additional holes make it possible to install the Utility Drawer in four different positions or equip the cabinet with one, two, three or four drawers.

### DRAWER ASSEMBLY TO CABINET

1. Attach the two drawer channels (A) (furnished with Drawer Kit 9361) to the side panels of the cabinet with hardware provided at position desired.
2. Insert Drawer (B) so that channels (A) fit into recess on each side of drawer.

#### PARTS LIST R - 9362 CABINET

Ident	Description	Quantity	Part Number
2	Side Panel	2	80002
3	Back Panel	1	80001
4	Shelf	1	80003
5	Hinge	2	80009
6	Top	1	80000
7	Hardware Tray	1	80006
8	Retainer Strap	1	80007
9	Cabinet Door	1	80005
10	Flat Hd. Mach. Screw 10-32 x 5/8	1	80099
11	Magnetic Latch	1	80168
12	Hex Nut #10-32	1	406
13	Hex Hd. Screw 1/4-20 x 1/2	30	80033
14	Kep Nut 1/4-20	30	80034
15	Leveler Foot	4	80032
16	Washer	1	39340
PARTS LIST R 9361 DRAWER			
A	Drawer Channel	2	203842
B	Drawer	1	203862
C	Rd. Hd. Mach. Screw 1/4-20 x 1/2	4	80033
D	Kep Nut	4	80034