

CRAFTMASTER JOINTER-PLANER

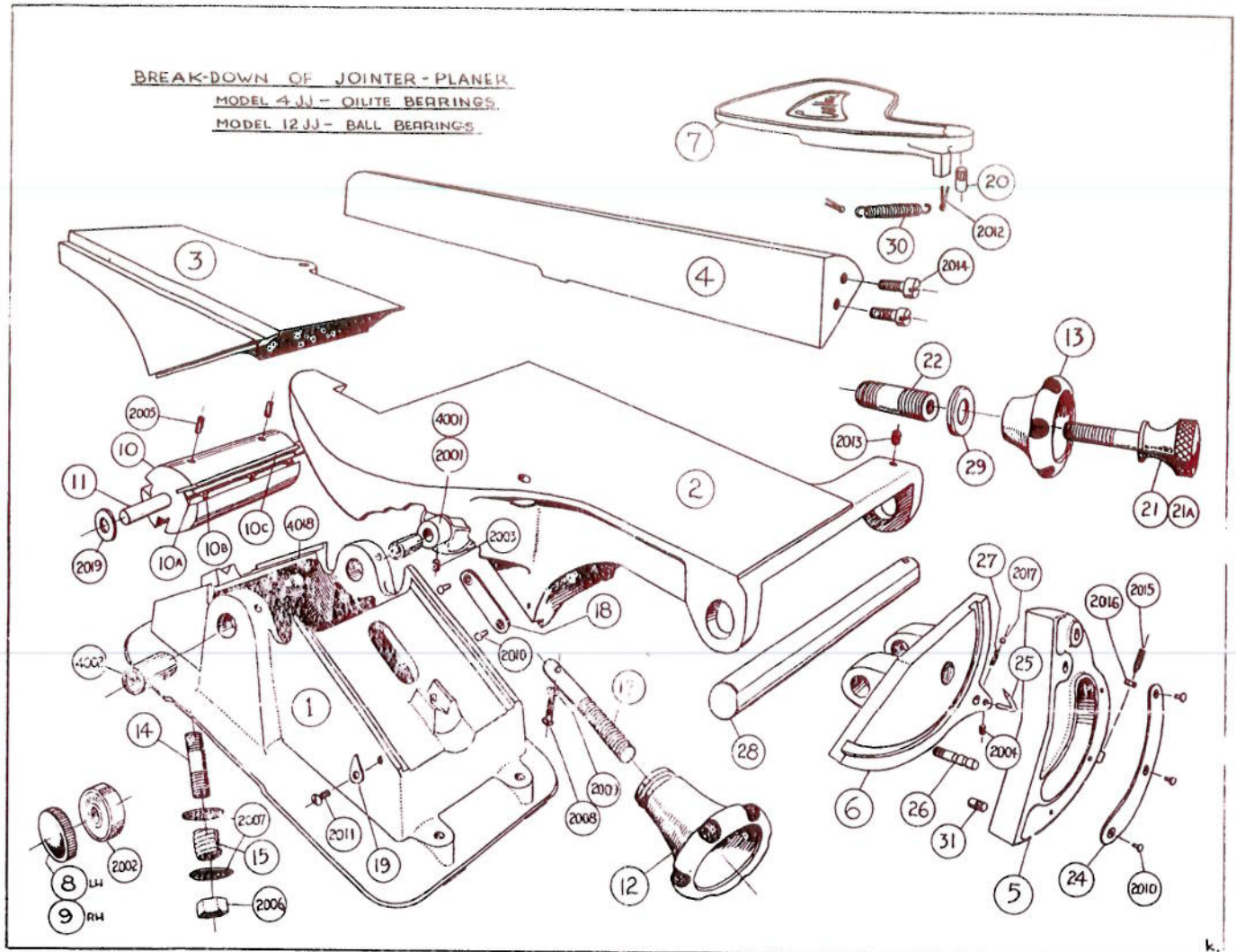

INSTRUCTIONS

READ CAREFULLY BEFORE SETTING UP MACHINE

This 4" Jointer-Planer is fully tested and inspected before shipment but mis-alignment is bound to occur in transit and the instructions below should be carefully followed when setting up machine.

Check cutter blade setting before operating machine. Blades should be exactly level with and parallel to front edge of rear table when table is at maximum height (5 $\frac{1}{4}$ " from bench surface).

After assembling, set and lock fence at 90° with table surface, (using set square), and set tilt pointer to the 0 mark on the tilt gauge. Push out stop plunger and adjust stop setscrew.

When front table is exactly level with cutter blades, depth pointer may be set to zero on depth gage.

Make sure slide lock knob is tight before tilt lock knob is loosened to tilt fence, when operating the machine.

Leave guard on machine at all times except when rabbetting.

Cutter head should be run at approximately 3500 RPM and to achieve best results, use a good 1 $\frac{3}{4}$ H.P. Motor.

Extra guard is available for rear fence.

For Parts List Please Turn Over

PARTS LIST

4 JJ & 12 JJ 4 INCH CRAFTMASTER JOINTER-PLANER

4JJ - 12JJ-1	Base	1	4JJ - 12JJ-26	Stop Plunger.....	1
4JJ - 12JJ-2	Front Table.....	1	4JJ - 12JJ-27	Plunger Spring.....	1
4JJ - 12JJ-3	Rear Table.....	1	4JJ - 12JJ-28	Fence Bar.....	1
4JJ - 12JJ-4	Fence	1	4JJ - 12JJ-29	Tilt Lock Washer.....	1
4JJ - 12JJ-5	Fence Quadrant.....	1	4JJ - 12JJ-30	Guard Spring.....	1
4JJ - 12JJ-6	Fence Slide.....	1	4JJ - 12JJ-31	Quadrant Pin.....	2
4JJ - 12JJ-7	Guard	1	#4001	Pulley (4JJ).....	1
12JJ-8	L.H. Bearing Plug.....	1	#2001	Pulley (12JJ).....	1
12JJ-9	R.H. Bearing Plug.....	1	#4002	Oilite Bushing (4JJ).....	2
4JJ - 12JJ-12	Raising Knob.....	2	#2002	Ball Bearing (12JJ).....	2
4JJ - 12JJ-13	Tilt Lock Knob.....	1	#2003	Pulley Setscrew.....	1
4JJ - 12JJ-10	Cutter Head.....	1	#2004	Pointer Setscrew.....	1
4JJ - 12JJ-10a	Chip Breaker.....	3	#2005	Cutter Head Setscrew.....	2
4JJ - 12JJ-10b	Blade Clamp Screw.....	9	#2006	Holdown Nut.....	2
4JJ - 12JJ-10c	Blade	3	#2007	Holdown Washer.....	4
4JJ - 12JJ-11	Spindle	1	#2008	Raising Screw Bolt.....	2
4JJ - 12JJ-14	Holdown Stud.....	2	#2009	Lock Washer.....	2
4JJ - 12JJ-15	Holdown Spring.....	2	#2010	Drive Screw.....	5
4JJ - 12JJ-17	Raising Screw.....	2	#2011	Depth Pointer Screw.....	1
4JJ - 12JJ-18	Depth Gage.....	1	#2012	Cotter Pin.....	2
4JJ - 12JJ-19	Depth Pointer.....	1	#2013	Fence Bar Set Screw.....	1
4JJ - 12JJ-20	Guard Pivot Pin.....	1	#2014	Quadrant Cap Screw.....	2
4JJ - 12JJ-21 } 21a }	Fence Slide Lock.....	1	#2015	Tilt Stop Set Screw.....	1
4JJ - 12JJ-22	Tilt Stud.....	1	#2016	Jam Nut.....	1
4JJ - 12JJ-24	Tilt Gage.....	1	#2017	Plunger Ball.....	1
4JJ - 12JJ-25	Tilt Pointer.....	1	#4018	Oil Cup.....	2
			#2019	Cutter Head Washer.....	2

HENRY POWER TOOLS LTD.

LONDON — CANADA