



[REDACTED]

**Jointer**

**JT - 205** [REDACTED]

**Operating instructions  
maintenance and  
parts list book**

[REDACTED]

INSERT HERE SERIAL NUMBER  
FOR FUTURE REFERENCE

**Machinerie  
POITRAS  
Ltée**

**Machinerie  
POITRAS  
Ltée**

C.P. 128 L'ISLETVILLE  
QUÉBEC, CANADA  
G0R 2C0  
418 247-3986  
TÉLEX 051-3968



Dear customer:

Congratulation! Thanks for your purchase of a new Poitras 8" jointer model JT-205. You can work entirely in confidence without fearing any problems. Your jointer was built with great attention to detail and carefully inspected prior to being shipped.

We are sure that you will be satisfied with this machine and we hope to satisfy you in the near future.

Once more, allow us to congratulate you for choosing this unit and we hope you will enjoy working with a tool of this quality.

Machinerie Poitras Ltée.

"For us a customer... is important!"

### Verification and installation

Well-protected by a solid wooden crate, tables covered with grease and a plastic sheet, your jointer should arrive in excellent condition. However, uncrate carefully your machine taking time to check for missing, broken or defective parts. Should any be discovered, please advise your dealer immediately. He will make the necessary arrangements to correct the situation as soon as possible.

After the inspection, remove the grease from the tables with a soft remover. Then place your jointer in its new location and make sure that it is perfectly levelled. Finally, to eliminate completely any possibility of vibrations, fix your jointer to the floor.

### Speed

#### (If bought without motor)

The pulley that we supply with your jointer has a 3" diameter. This pulley must be used on a high-speed motor (1 H.P. to 3 H.P. / 3600 RPM). The cutter head will then reach 4900 RPM which is the recommended working speed.

There is absolutely no advantage to accelerate the cutter head speed and the jointer bearing will not last any longer. Finally, we strongly recommend that any electrical connexion should be made by an electrician.

### Maintenance

Simple and easy to do, it will only help to keep your machine in good condition... if it is done regularly.

Periodically, lightly oil each table to protect them against the rust and to help the wood to slide more easily on the tables. Oil also each handle rod to help them to turn freely.

Finally, make sure that the knives are always well-sharpened and that they are levelled with the rear table. Your work will only be better!

## Various adjustments

Even if the tables, the tables slide tension and the knives were adjusted at factory, sooner or later you will have to do it by yourself. You will find here below easy tips that will help you to do these adjustments. (Always refer to drawing and the spare parts list to find out each different part mentioned in this section.)

### Table adjustment

If the tables are not levelled, here is what you should do:

1. Find out where is the problem by placing a straight piece of material over the table.

Note: Both tables must be raised to zero.

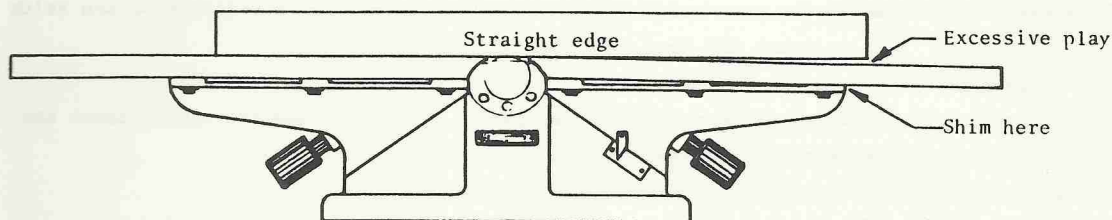

2. Loosen the bolt (#105) located underneath the tables and put a shim between the table slide (#19) and the table itself (#20 or #21). Do not forget to retighten the bolt when this is done.

Note: If you are too rough with your tables, they might have to be regrinded. In this case, remove your tables and go to the nearest place where they can regrind them. When this will be done, put them back in place.

### Tables slide tension adjustment

If the tables slide tension on the main arm frame (#13) is too tight or too loose, follow these next steps to set it:

1. Depending on the side that needs to be adjusted, loosen the nuts (#127) located behind your jointer.

2. a) To tighten the table slide tension: tighten the pressure screws (#112).  
b) To loosen the table slide tension: loosen the pressure screws (#112).
3. Finally, retighten the nuts (#127).

#### Knives adjustment

You will accomplish a better and safer work if the knives are parallel and at the same height with the rear table. It is very important to check if the knives are well-adjusted when you receive your jointer.

Proceed this way:

1. Raise the rear and the front tables to zero. Put a straight wooden stick of at least 20" long over them and the cutter head.
2. By turning the cutter head manually, each knife should lightly touch the stick and it should move 1/8" forward.
3. If a knife is too high (the stick will move more than 1/8" forward) or too low (the stick will not move 1/8" forward), loosen the screws (#118) which hold the unsettled knife. With the Halen key supplied with your jointer, raise or lower the knife by screwing or unscrewing the hexagonal socket head cap screw (#109) until the proper adjustment is done.
5. Retighten the pressure screws (#118).
6. Repeat the previous instructions for each knife.

To accomplish a top quality work, your jointer knives must always be very well-sharpened. If you let them wear, it could be very dangerous and the wood surface of your material will not be nice and smooth.

## Surfacing

Surfacing is quite simple to do but it demands you to respect certain practices if you want to realize good work, also to lessen the possibilities of injuries. By following the next instructions, you will be able to surface quite easily. However, with a little bit of experience, surfacing will become as easy as a child game.

1. Set the angle you need on the fence (between  $90^{\circ}$  -  $45^{\circ}$ ) by unscrewing the fence handle (#28) located behind the fence. It is preferable to check the angle with a protractor to get a better precision. Retighten the fence handle (#28) when this will be done.
2. If you want to move your fence forward, loosen the locking handle (#28B) and turn the fence handle (#48). Do not forget to retighten the locking handle (#28B) when the fence is set at the desired place. (Usually this step is practical when you want to rabbet material; but if this is the case, the safety guard must be removed.)
3. Set the height of the front table (feeding table) for about a  $1/16''$  cut with the knob located underneath the feeding table.
4. Find the concave side of your material. This face should be surfaced first.

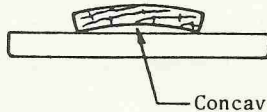

5. Turn on the machine and let it get its full running speed.
6. Push the piece of wood forward and hold it firmly with both hands. As soon as you have surfaced 12" of material, bring your left hand ahead the cutter head and stay on the left side of the feeding table. Always surface short and thin pieces.

7. Make sure that each point of your piece of wood has been surfaced and also that its surface is smooth. It might be necessary to go over a couple of times but the last cut will always be the thinner one.
8. Finally, if you have many pieces of wood to surface of the same width, move your fence frequently on all its width so the knives will wear equally.

Note: At point number 6 we mentioned to use a push-block. A push-block is a tool that has one or two knobs and also a surface that snatches the wood. This tool avoids your hands from leaning on the material. You can build one by yourself or buy one in a good tool store.

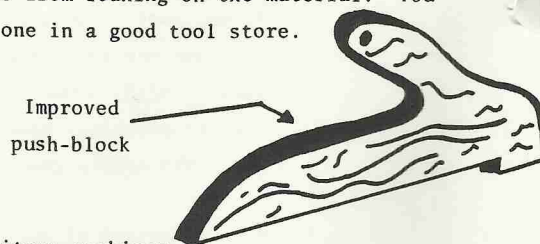
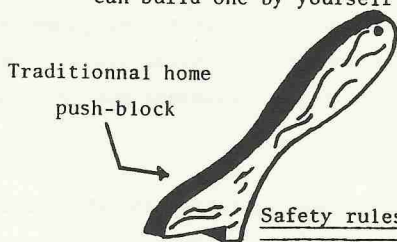

Safety rules for Poitras machines

As with all power tools, there is a certain amount of hazard involved with the operator and his use of the tool. Using the tool with respect and caution as demanded, as far as safety precautions are concerned, will considerably lessen the possibilities of personal injuries. However, if normal safety precautions are overlooked or completely ignored, personal injuries to the operator can develop.

There are also certain applications for which this tool was designed. Poitras strongly recommends that this tool is not to be modified and/or used for any applications other than for which it was designed. If you have any relative questions to its application, do not use the tool until you have contacted your dealer for advice.

Poitras cares about safety... Do you?

1. Know your power tool. Read the owner's manual carefully. Know the limits and applications of your tool.
2. Keep guards in place.
3. Ground your tool.
4. Remove adjusting keys and wrench.
5. Keep work area clean.
6. Avoid dangerous environments. Do not use your power tool in damp or wet locations and do not expose it to rain.
7. Keep children and visitors away when you work.
8. Do not force your tool.
9. Use the right tool for the kind of work you make.
10. Wear proper apparel. No loose clothing to get caught in moving parts.
11. Always use safety glasses.
12. Use secure work. Use clamps or vises to hold work when practical. It is safer than using your hands in the work area of your tool.
13. Do not overreach.
14. Maintain your tool in top conditions.
15. Disconnect your tool when changing accessories such as blades, bits, cutters...

16. Avoid accidental starting. Make sure switch is in off position before plugging cord.
17. Never stand on your tool because serious injuries may result from an accidental contact.
18. Check damaged parts. If you find any, repair them before reusing.
19. Never leave your tool running unattended.
20. Do not operate your tool under drugs, alcohol or medicine effect; you may injure yourself for the rest of your life.

Additional safety rules  
for the jointer

- Make sure that the knives are well-sharpened.
- Never try to set something when the machine is running.
- Body position: Keep both feet firmly to the ground on the left side of the machine. Never stand at the end of the tool because the piece of wood could accidentally be rejected to the rear. It is recommended to push the wood chips away especially if you are working on a wooden floor. This will reduce the risk of slipping on the floor.
- Never surface a piece of wood less than 12" long or 1/2" thick. Small pieces are dangerous to surface because your hands get too close to the cylinder. Use a hand planer for short pieces of wood.
- Always use a push-block when you surface pieces with a width less than 6".
- Do not try to surface the end of a piece less than 8" wide.
- Do not try to make a deep cut. The 1/16" thick cut is the one that gives the best results.

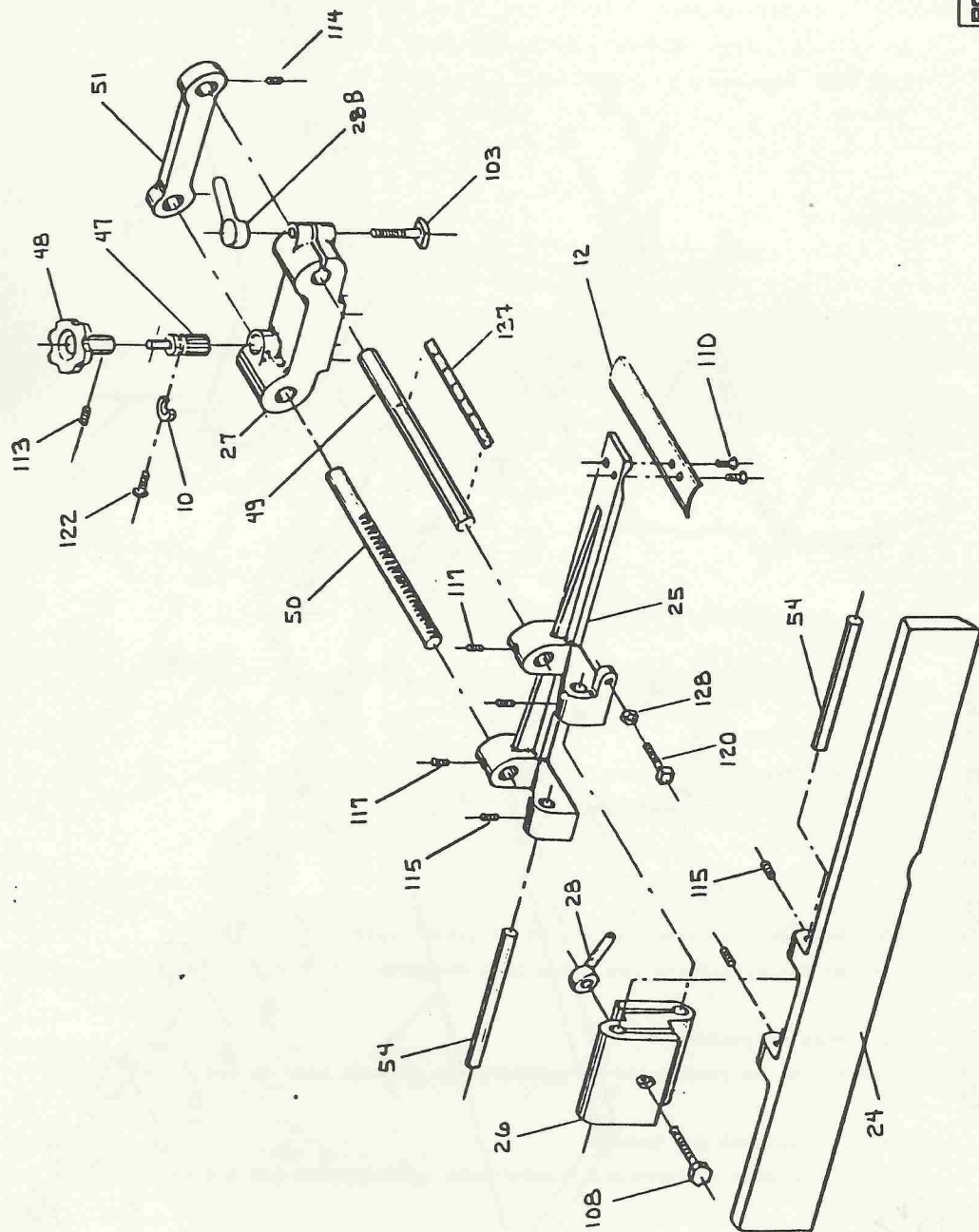

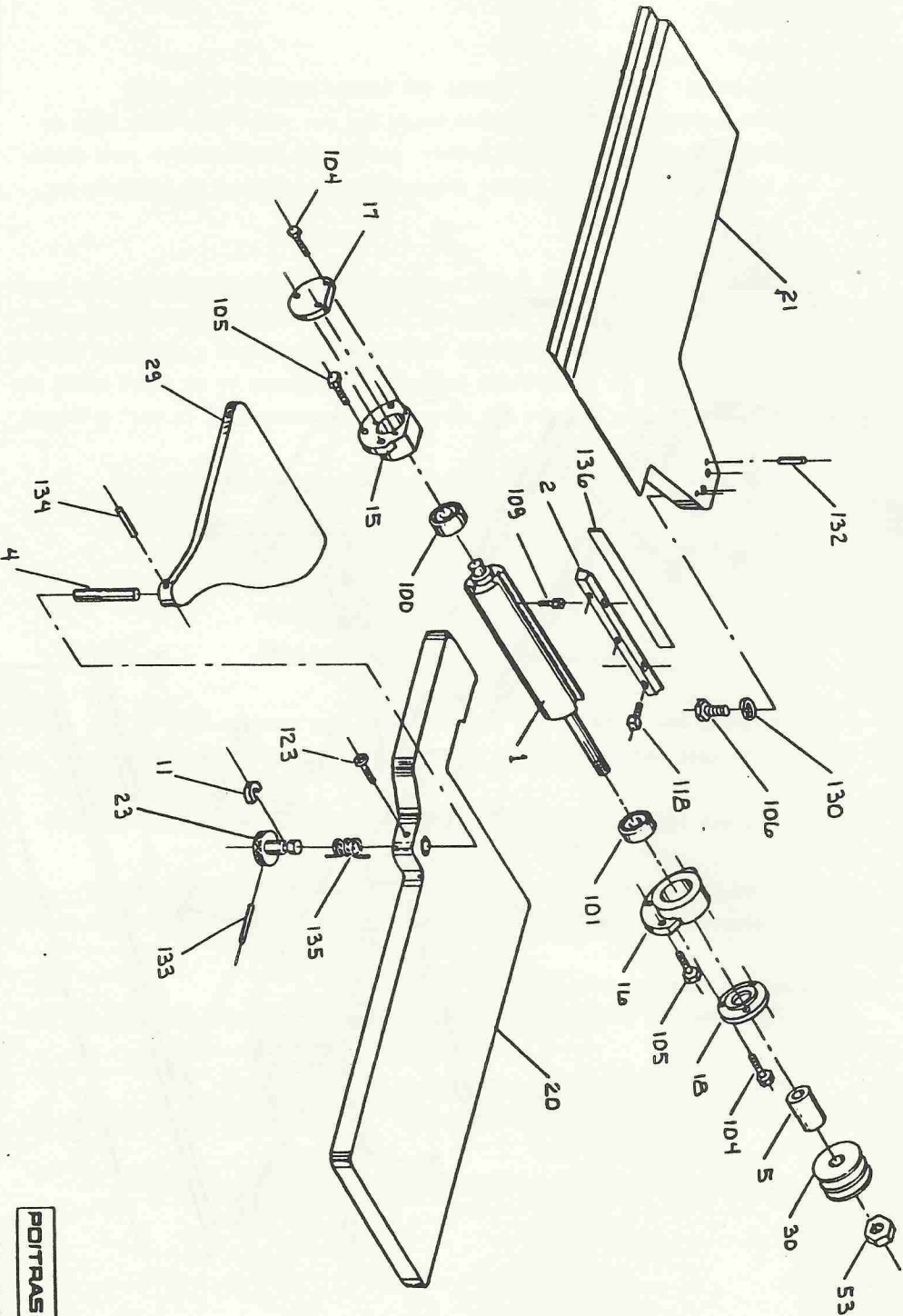

DEGAUCHISSEUSE / JOINTER



JT - 205

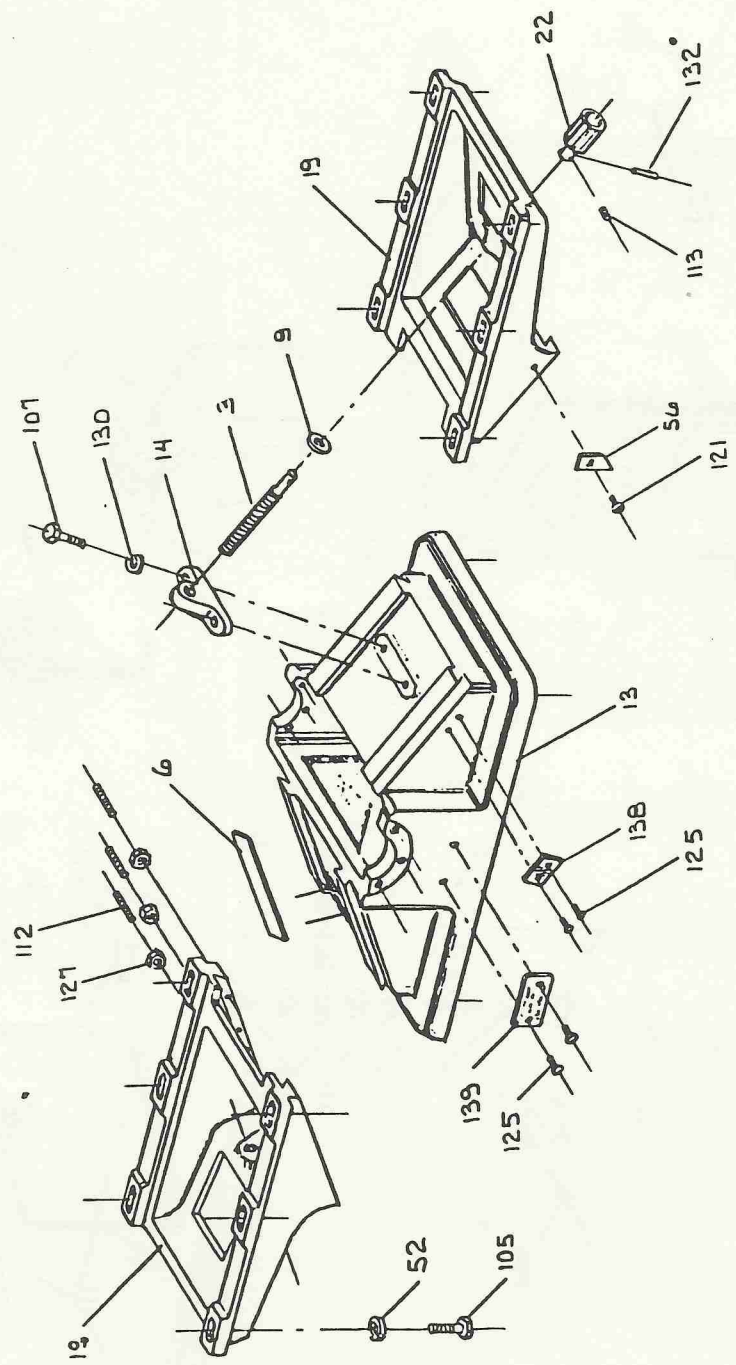

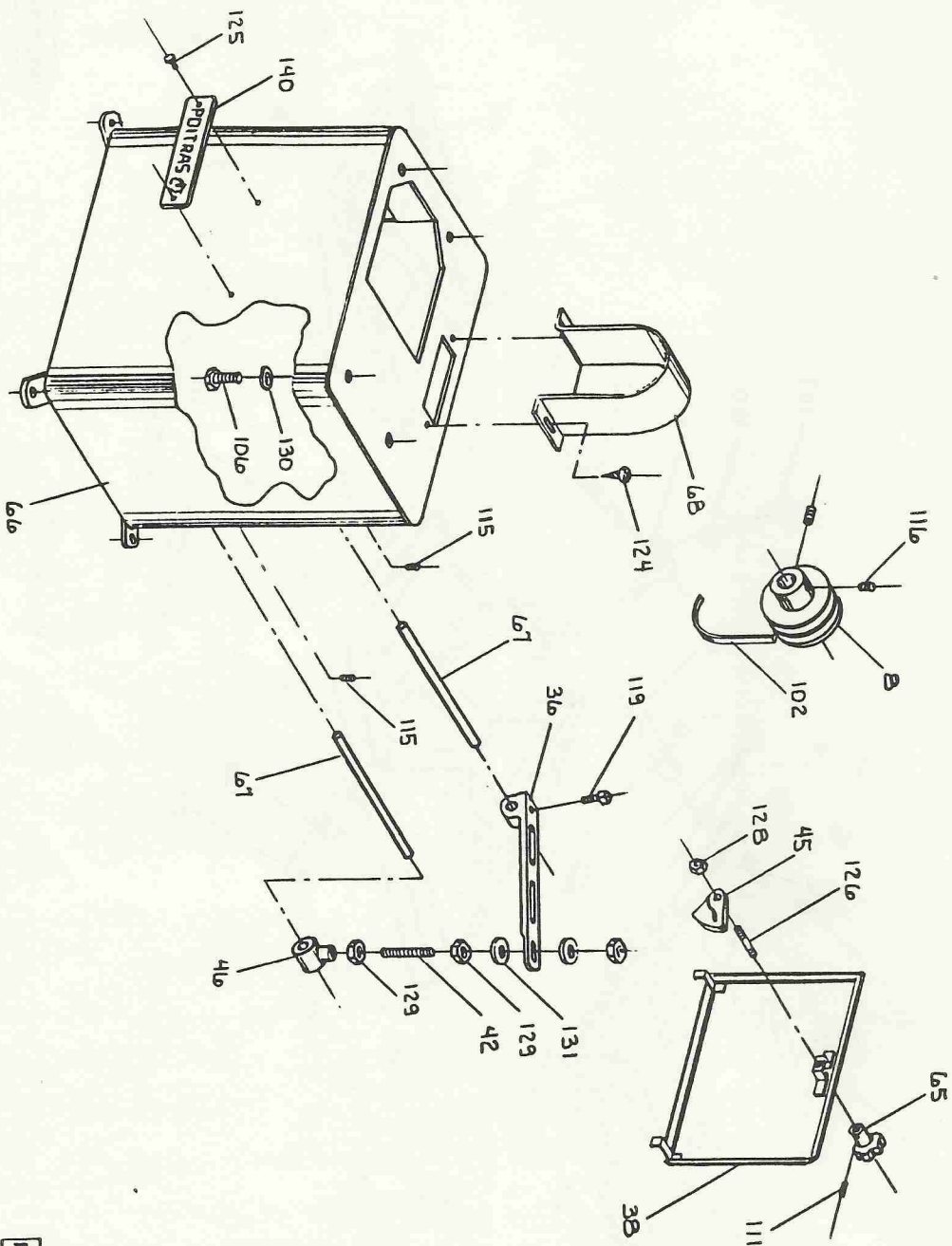

DEGAUCHISSEUSE / JOINTER



JT - 205

## SPARE PARTS LIST

DEGAUCHISSEUSE JT-205 JOINTER

DATE 84-06-20

REF	NO DE PIECE PART NUMBER	DESCRIPTION	QTE QTY
1	1538 2253 00	CYLINDRE CUTTERHEAD	1
2	1538 2254 00	BARRE DE SERRAGE KNIFE PRESSURE BAR	3
3	1538 2255 00	VIS POUR TABLE TABLE SCREW	2
4	1538 2256 10	TIGE DU GARDE DE SURETE SAFETY GUARD SHAFT	1
5	1538 2257 00	DOUILLE POUR CYLINDRE CYLINDER SLEEVE	1
6	1538 2258 00	CLE POUR COULISSE SLIDING KEY	2
8	1538 2259 00	POULIE OU MOTEUR 2 VA 7" TROU 5/8" MOTOR PULLEY 2 VA 7" 5/8" BORE	1
8	1538 2259 10	POULIE DU MOTEUR 2 VA 7" TROU 7/8" MOTOR PULLEY 2 VA 7" 7/8" BORE	1
8	1598 2301 10	POULIE DU MOTEUR 2 VA 3 1/2" TROU 5/8" MOTOR PULLEY 2 VA 3 1/2" 5/8" BORE	1
8	1598 2301 30	POULIE DU MOTEUR 2 VA 3 1/2" TROU 7/8" MOTOR PULLEY 2 VA 3 1/2" 7/8" BORE	1
8	1598 2301 40	POULIE DU MOTEUR 2 VA 3 1/2" TROU 24MM MOTOR PULLEY 2 VA 3 1/2" 24MM BORE	1
9	1538 2260 00	RONDELLE POUR VIS DE LA TABLE TABLE SCREW WASHER	2
10	1540 2504 00	SEGMENT DE CERCLE 3/4" X 1" CIRCLE SEGMENT 3/4" X 1"	1
11	1538 2261 00	SEGMENT DE CERCLE 5/8" X 7/8" CIRCLE SEGMENT 5/8" X 7/8"	1
12	1538 2262 00	TOLE DE SURETE SAFETY PLATE	1
13	1538 2263 00	BATI PRINCIPAL MAIN FRAME	1
14	1538 2264 00	BOITE A VIS SCREWING BLOCK	2

## DEGAUCHISSEUSE JT-205 JOINTER

REF	NO DE PIECE PART NUMBER	DESCRIPTION	QTE QTY
15	1538 2265 00	BOITE A BILLES, COTE FIGURAGE BEARING CASE, RABBETING SIDE	1
16	1538 2266 00	BOITE A BILLES, COTE POULIE BEARING CASE, PULLEY SIDE	1
17	1538 2267 10	COUVERCLE BOITE A BILLES, COTE FIGURAGE BEARING CASE COVER, RABBETING SIDE	1
18	1538 2268 10	COUVERCLE BOITE A BILLES, COTE POULIE BEARING CASE COVER, PULLEY SIDE	1
19	1538 2269 00	COULISSE POUR TABLE TABLE SLIDE	2
20	1538 2270 10	TABLE AVANT FRONT TABLE	1
21	1538 2271 10	TABLE ARRIERE REAR TABLE	1
22	1538 2272 00	POIGNEE POUR TABLE TABLE HANDLE	2
23	1538 2273 00	POIGNEE DE SERRAGE DU RESSORT DU GARDE SPRING TIGHTENING HANDLE	1
24	1538 2274 00	GUIDE FENCE	1
25	1538 2275 00	BASE DU GUIDE FENCE BASE	1
26	1538 2276 00	PENTURE DU GUIDE FENCE HINGE	1
27	1538 2277 00	SUPPORT POUR GLISSEMENT DU GUIDE FENCE SLIDING BRACKET	1
28 28B	1538 2278 00	POIGNEE POUR SERRAGE ET PIVOTEMENT DU GUIDE FENCE HANDLE	2
29	1538 2280 00	GARDE DE SURETE SAFETY GUARD	1
30	1538 2281 00	POULIE DU CYLINDRE 2 VA 2 1/2" CUTTERHEAD PULLEY 2 VA 2 1/2"	1
36	1538 2284 00	SUPPORT DU MOTEUR MOTOR BRACKET	2

## DEGAUCHISSEUSE JT-205 JOINTER

REF	NO DE PIECE PART NUMBER	DESCRIPTION	QTE QTY
38	1538 2285 00	PORTE DOOR	1
42	1538 2288 00	TIGE FILETEE STUD	2
45	1538 2290 00	PIECE BARRURE DE PORTE DOOR LOCK	1
46	1538 2291 00	COLLET POUR SUPPORT DU MOTEUR MOTOR SUPPORT COLLAR	2
47	1538 2292 00	PINION POUR AJUSTEMENT DU GUIDE FENCE ADJUSTMENT PINION	1
48	1538 2293 00	POIGNEE POUR PINION PINION HANDLE	1
49	1538 2294 10	TIGE POUR GLISSEMENT DU GUIDE ROD FOR FENCE SLIDING	1
50	1538 2295 00	TIGE DENTELEE POUR GLISSEMENT DU GUIDE TEETHED ROD FOR FENCE SLIDING	1
51	1538 2279 00	PIECE DU BOUT POUR TIGES DU GUIDE CAP FOR FENCE ROD	1
52	1538 2296 00	RONDELLE POUR COULISSE DE TABLE TABLE SLIDE WASHER	12
53	1507 0142 00	ECROU DE BLOCAGE 3/4"-16 N.F. LOCKING NUT 3/4"-16 N.F.	1
54	1538 2297 00	TIGE PIVOT PIVOT ROD	2
56	1538 2300 00	AIGUILLE INDICATRICE POINTER	1
65	1599 9501 10	POIGNEE HANDLE	1
66	1538 2302 00	BASE BASE	1
67	1538 2310 10	ARBRE SUPPORT DU MOTEUR 5/8" X 13 3/4" MOTOR BRACKET ROD 5/8" X 13 3/4"	2
68	1538 2311 00	GARDE COURROIES BELT GUARD	1

## DEGAUCHISSEUSE JT-205 JOINTER

REF	NO DE PIECE PART NUMBER	DESCRIPTION	QTE QTY
100	1120 0203 35	ROULEMENT 6203 2RS BEARING 6203 2RS	1
101	1120 0203 45	ROULEMENT 6204 2RS BEARING 6204 2RS	1
102	1121 2000 60	COURROIE V, A-60 APPAREILLEE MATCHED V-BELT, A-60	2
103	1122 0115 55	BOULON TETE CARREE 3/8"-16 X 2 1/2" SQUARE HEAD CAP SCREW 3/8"-16 X 2 1/2"	1
104	1122 0213 25	BOULON TETE HEX. 1/4"-20 X 3/4" HEX. HEAD CAP SCREW 1/4"-20 X 3/4"	6
105	1122 0214 31	BOULON TETE HEX. 5/16"-18 X 1" HEX. HEAD CAP SCREW 5/16"-18 X 1"	18
106	1122 0215 25	BOULON TETE HEX. 3/8"-16 X 3/4" HEX. HEAD CAP SCREW 3/8"-16 X 3/4"	6
107	1122 0215 37	BOULON TETE HEX. 3/8"-16 X 1 1/4" HEX. HEAD CAP SCREW 3/8"-16 X 1 1/4"	4
108	1122 0215 55	BOULON TETE HEX. 3/8"-16 X 2 1/2" HEX. HEAD CAP SCREW 3/8"-16 X 2 1/2"	1
109	1122 1013 17	VIS TETE CYL. 6 PANS CREUX 1/4"-28 X 1/2" HEX. SOCK. HEAD CAP SCREW 1/4"-28 X 1/2"	6
110	1122 1106 10	VIS TETE PLATE CREUSE 3/16"-24 X 3/8" SOCK. FLAT HEAD MACH. SCREW 3/16"-24 X 3/8"	2
111	1122 1313 10	VIS DE PRESSION 6 PANS CREUX 1/4"-20 X 3/8" HEX. SOCK. SET SCREW 1/4"-20 X 3/8"	1
112	1122 1313 31	VIS DE PRESSION 6 PANS CREUX 1/4"-20 X 1" HEX. SOCK. SET SCREW 1/4"-20 X 1"	8
113	1122 1314 05	VIS DE PRESSION 6 PANS CREUX 5/16"-18 X 1/4" HEX. SOCK. SET SCREW 5/16"-18 X 1/4"	3
114	1122 1314 07	VIS DE PRESSION 6 PANS CREUX 5/16"-18 X 5/16" HEX. SOCK. SET SCREW 5/16"-18 X 5/16"	2
115	1122 1314 10	VIS DE PRESSION 6 PANS CREUX 5/16"-18 X 3/8" HEX. SOCK. SET SCREW 5/16"-18 X 3/8"	8
116	1122 1314 16	VIS DE PRESSION 6 PANS CREUX 5/16"-18 X 1/2" HEX. SOCK. SET SCREW 5/16"-18 X 1/2"	2

## DEGAUCHISSEUSE JT-205 JOINTER

REF.	NO DE PIECE PART NUMBER	DESCRIPTION	QTE QTY
117	1122 1315 16	VIS DE PRESSION 6 PANS CREUX 3/8"-16 X 1/2" HEX. SOCK. SET SCREW 3/8"-16 X 1/2"	2
118	1122 1414 10	VIS DE PRESSION TETE CARREE 5/16"-18 X 3/8" SQUARE HEAD SET SCREW 5/16"-18 X 3/8"	9
119	1122 1414 25	VIS DE PRESSION TETE CARREE 5/16"-18 X 3/4" SQUARE HEAD SET SCREW 5/16"-18 X 3/4"	2
120	1122 1414 43	VIS DE PRESSION TETE CARREE 5/16"-18 X 2 1/2" SQUARE HEAD SET SCREW 5/16"-18 X 2 1/2"	1
121	1122 1606 10	VIS TETE RONDE CREUSE 3/16"-24 X 3/8" SOCK. ROUND HEAD MACH. SCREW 3/16"-24 X 3/8"	1
122	1122 1606 16	VIS TETE RONDE CREUSE 3/16"-24 X 1/2" SOCK. ROUND HEAD MACH. SCREW 3/16"-24 X 1/2"	1
123	1122 1606 25	VIS TETE RONDE CREUSE 3/16"-24 X 3/4" SOCK. ROUND HEAD MACH. SCREW 3/16"-24 X 3/4"	1
124	1122 2506 16	VIS TAR. TETE RONDE NO 10 X 1/2" ROUND HEAD METAL SCREW NO 10 X 1/2"	2
125	1122 2600 05	FAUSSE VIS TYPE "U" #4 X 1/4" DRIVE SCREW TYPE "U" #4 X 1/4"	6
126	1122 3514 49	TIGE PILETEE 5/16"-18 X 2" MILLED STUD 5/16"-18 X 2"	1
127	1122 4013 10	CONTRE-ECROU HEX. 1/4"-20 HEX. JAM NUT 1/4"-20	8
128	1122 4014 05	ECROU HEX. 5/16"-18 HEX. NUT 5/16"-18	2
129	1122 4015 05	ECROU HEX. 3/8"-16 HEX. NUT 3/8"-16	6
130	1122 4315 05	RONDELLE DE BLOCAGE 3/8" LOCK WASHER 3/8"	10
131	1122 4316 05	RONDELLE PLATE 7/16" S.A.E. PLAIN WASHER 7/16" S.A.E.	4
132	1122 5006 28	GOUPILLE RESSORT 3/16" X 7/8" SPRING PIN 3/16" X 7/8"	4
133	1122 5101 37	GOUPILLE RAINUREE 1/8" X 1 1/4" GROOVED PIN 1/8" X 1 1/4"	1

## DEGAUCHISSEUSE JT-205 JOINTER

REF	NO DE PIECE PART NUMBER	DESCRIPTION	QTE QTY
134	1122 5106 43	GOUPILLE RAINUREE 3/16" X 1 1/2" GROOVED PIN 3/16" X 1 1/2"	1
135	1122 5823 31	RESSORT DE TORSION TORSION SPRING	1
136	1123 0308 35	COUTEAU 1/8" X 3/4" X 8" KNIFE 1/8" X 3/4" X 8"	3
137	1130 0201 25	GRADUATION DEPLACEMENT DU GUIDE GUIDE TRAVEL SCALE	1
138	1130 0203 75	GRADUATION REGLAGE D'EPaisseur THICKNESS SCALE	1
139	1130 0300 26	PLAQUE NO DE SERIE SERIAL NUMBER PLATE	1
140	1130 0301 01	PLAQUE POITRAS 8" X 2" POITRAS NAME PLATE	1