

Model 141 14" Band Saw

ALL MACHINES PERFORMANCE-TESTED BEFORE SHIPMENT

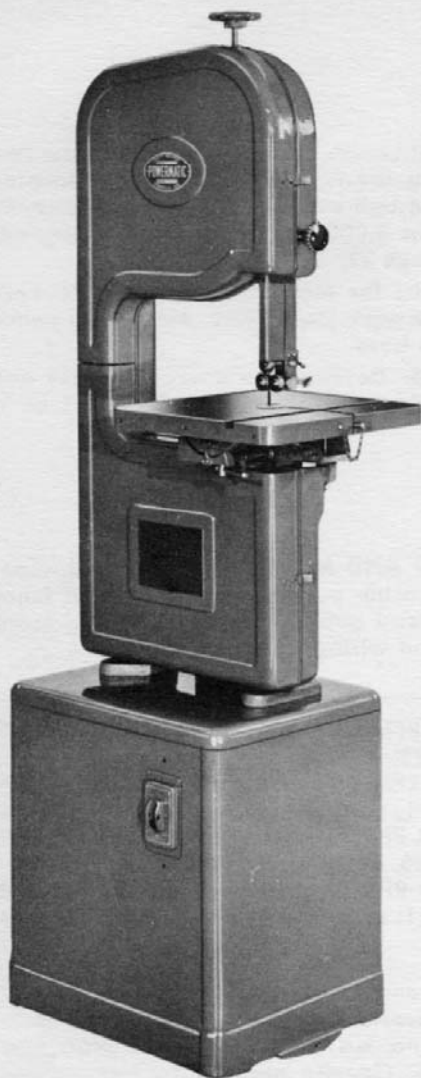

heavier . . . vibrationless . . . smoother . . .

Leading the field in performance . . . rugged, versatile, dependable . . . POWERMATIC's Model 141 Band Saw, through precise engineering, offers the outstanding performance required for every type of band sawing operation. The advance-design of the tremendous one-piece, box type frame casting makes it, without doubt, the heaviest 14" Band Saw available. The weight, vibrationless operation, and perfect alignment give you the smoothest performance ever and, insures years of trouble free operation. A complete line of accessories, blades and electricals provide flexibility and safety previously found only in higher priced production models.

T.E.F.C. Motor Standard

Rip Fence

Optional for precision ripping and resawing. Accurately scaled with pointer for vernier adjustment.

Table Trunnion

Heavy duty, widely spaced table trunnion assures positive lock and maximum table rigidity at any degree of tilt. Large, easy to read tilt scale located at rear of table.

Side Takeout Slot

for bandsaw blade eliminates necessity of split or narrow trunnions. Tapered pin keeps table surface flat.

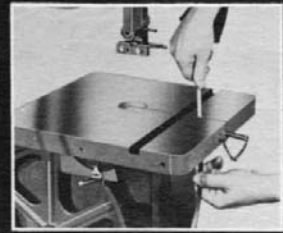
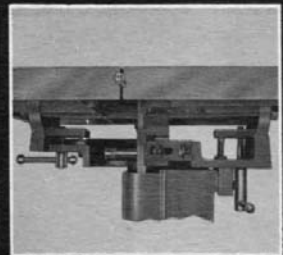
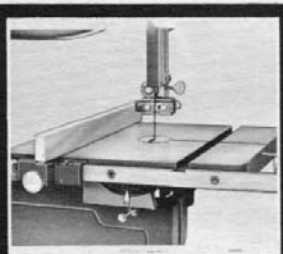

Eye level blade tension scale

shows correct tension for different blade widths. Adjustable from front of machine.



Exclusive "vulcanized" tires

eliminates frequent tire change—massive Box-type casting houses dynamically balanced wheel for smooth operation.

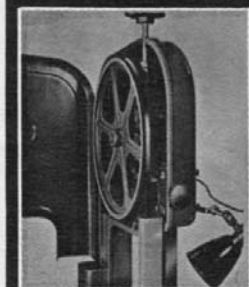

Swivel type table stop automatically

positions table or is easily moved for 15° left tilt.

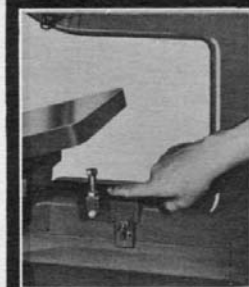

Ball bearing side and backup bearings

reduce blade fatigue as much as 50% on all non-ferrous materials.

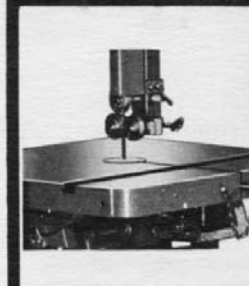

Flexibility, Safety and advanced features

**Model 141
14" Band Saw**

56 frame Balder 4 L 610 Belt

FEATURES

FRAME: Massive, box-type, one piece, cast iron frame, ribbed and cross ribbed for maximum rigidity, vibrationless, trouble-free service.

WHEELS: Heavy duty cast iron upper and lower wheels, precision machined and dynamically balanced for smooth running. Ground rubber tires provide positive grip preventing blade slippage.

TABLE: Huge 15" x 15" cast iron table, accurately ground and machined for hair-line cutting and equipped with side take-out to permit use of a solid rip-fence guard rail. Tilts 45° right—12° left, with positive stop at 90°.

TRUNNION: Wide spaced cast iron and steel trunnion assures positive locking of table. An easy to read 'sight' scale is mounted on front of trunnion for quick, positive tilt adjustment.

SAW GUIDES: Top saw guide is fitted with back-up ball bearing and large hardened steel side guides. Lower guide utilizes back-up ball bearing and ball bearing side guides. Lower guide is just below table surface for closer tolerance.

GUARDS: All moving parts are completely guarded. Only the operating portion of the blade is exposed. Large pressed steel doors enclose upper and lower wheels.

SAW BLADE ADJUSTMENT: Blade tension is adjusted with conveniently located handwheel, spring loaded to absorb shock and maintain equal tension on the blade. A tension scale, located at eye-level, controls proper blade tension.

DRIVE: Non-slip V-belt for utmost efficiency in any work load range. Drive, motor, and "v" belt are completely enclosed in a heavily braced steel floor stand.

STANDARD EQUIPMENT

BAND SAW WITH OR WITHOUT STAND: ¼" blade, ball bearing guides, wheel and blade guards, wrenches and arbor pulley—Less motor, motor pulley, V-belt and switch.

BAND SAW WITH MOTOR: ¼" blade, ball bearing guides, wheel and blade guards, wrenches, arbor pulley, motor, motor pulley, V-belt and switch.

STANDARD MACHINES

141-01—14" Band Saw, complete with guards and ¼" blade, wrenches, but less motor and stand.

41-02—Same as 141-01 except with floor stand.

141-03—Same as 141-02 except with 1/3-HP 1-phase motor, switch, # 1-21, belts, pulleys, cord and plug.

141-04—Same as 141-02 except with 1/3-HP 3-phase motor, switch, #3-25, belts, pulleys.

141-05—Same as 141-02 except with ½-HP 1-phase motor, switch, #1-21, belts, pulleys, cord and plug.

141-06—Same as 141-02 except with ½-HP 3-phase motor, switch, #3-25, belts, pulleys.

SPECIAL LISTINGS

141-07—14" band saw, complete with guards, floor stand, ½ HP single phase motor. Manual switch with overload protection, cord and plug.

141-08—14" band saw, complete with guards, floor stand, ½ HP 3 phase motor, manual switch with overload

protection.

141-09—14" band saw, complete with guards, floor stand, ½ HP single OR 3 phase motor, magnetic controls. Cord and plug std. on single phase only.
(Specify phase)

OPTIONAL ACCESSORIES

141-10—Work Lamp, wt. 10 oz.

141-11—Miter Gauge, wt. 3½ lbs.

141-12—Rip Fence, wt. 8 lbs.

141-13—½" Wide band saw blade, wt. 6 oz.

141-14—3/16" Wide band saw blade, wt. 6 oz.

141-15—¼" Wide band saw blade, wt. 6 oz.

141-16—⅜" Wide band saw blade, wt. 6 oz.

141-17—½" Wide band saw blade, wt. 6 oz.

141-18—¾" Wide band saw blade, wt. 6 oz.

141-19—3-phase O/L Switch #3-27, wt. 1 lb.

141-20—1-phase O/L Switch #1-23, wt. ¾ lb.

141-21—Magnetic 3-ph. Switch #3-30 & 1-3-32, wt. 6 lbs.

141-22—Magnetic 1-ph. Switch #1-29 & 1-3-32, wt. 6 lbs.

141-23—Floor Stand, wt. 57 lbs.

***141-24**—3½" diameter motor pulley for 1725 RPM motor.
(Specify bore). Wt. 1 lb.

141-25—Belt for 1750 RPM motor—4L600, wt. 8 oz.

141-26—JIC Electricals for 1-phase or 3-phase, wt. 20 lbs.

141-27—Upper guide assembly.

141-28—Lower guide assembly.

*(Order ONLY when machine is purchased less motor.)

SPECIFICATIONS

CAPACITY: Blade to frame.....	14"
Under guide.....	6½"
Blade Speed.....	3000 SFM
Overall Height (on stand).....	71"
Width.....	25½"
Front to Back.....	13¾"
Table Size.....	15" x 15"
Table height from floor.....	42"
Table tilt.....	45° right, 12° left
Blade width, maximum.....	¾"

Blade length, maximum.....	96"
Blade length, minimum.....	94"
Weight, net, less stand.....	222 lbs.
Weight, net, with stand.....	296 lbs.
Weight, crated, less stand.....	225 lbs.
Weight, crated, with stand.....	330 lbs.
Weight, crated, with stand and motor.....	355 lbs.
Export, boxed, less stand (22.1 cu. ft.).....	330 lbs.
Export, boxed, with stand (39.9 cu. ft.).....	422 lbs.
Export, boxed, with stand and motor (39.9 cu. ft.).....	450 lbs.

OPERATING INSTRUCTIONS

OPERATING INSTRUCTIONS AND PARTS LISTS

Model 141 — 14" Band Saw

For Serial Numbers from 1-101 Up

POWERMATIC, INC.

McMinnville, Tennessee

OPERATING INSTRUCTIONS

The Powermatic Model 141-14" Band Saw is constructed of cast iron, braced to give maximum rigidity. Streamlined in appearance, all moving parts are completely guarded for safe operation. The top and bottom band saw wheels are easily accessible through large hinged doors on the front of saw. Separate, enclosed floor stand keeps motor and drive free from cuttings and dust.

MOTOR AND WIRING: Electric wiring is connected to motor wiring in switch box mounted in the base. Motor should be inspected and checked for rotation before operating machine. Operate lower unit and check rotation before installing blade.

POWER DRIVE: The saw is driven with a motor mounted in the base of the machine. A 1/3 HP motor is sufficient for light and medium work and a 1/2 HP for heavy work and resawing. The motor is mounted on an adjustable hinged base.

INSTALLING BLADE: To install band saw blade, remove taper pin from front of table; open the large hinged doors. Take the blade in both hands and slide through the table slot and over band saw wheels. With blade placed in the center of the band wheels, increase tension with tension screw (1) fig. 1. Set upper and lower saw guides so that they will clear the saw blade. Turn the band wheels by hand to see that saw blade tracks properly. If blade runs to the front of the band wheel, handwheel (2) fig. 1 should be turned to the right or clockwise until blade runs to center of wheel. If blade runs to the back, turn handwheel (2) fig. 1 to left or counter-clockwise. For accurate work and maximum blade life it is important that the blade runs centered on the wheels. When the adjustment has been properly made, the blade will track; that is, it will run steadily in the same line.

WHEEL ALIGNMENT: The band wheels are properly aligned at the factory, and should operate properly. However, in shipping, the original adjustment may have moved, necessitating re-alignment. The lower wheel housing should be adjusted by shimming. Upper wheels are mounted on a pivot and can be positioned by turning set screw (7) fig. 2 to the left or right.

BLADE GUIDE ADJUSTMENT: For proper operation, the saw blade must be supported by an upper and lower saw guide. The lower guide is mounted under the table and the upper guide is mounted on an adjustable bar above the table. The purpose of the band saw guide is to support the blade in cutting circles. It is very important that the guides be set in proper relation to the saw blade. To set the guides to the saw blade, set the tension on the blade and start the saw to check tracking. Set the upper guide as follows: Loosen set screw on the guide blocks (8) fig. 2 and move the blocks until both upper and lower guides clear the blade. Loosen wingnut (5) fig. 2 and move guide holder until the guide edge is just back of the gullet in the saw blade. Loosen wing screw (4) fig. 2 and adjust backup bearing (6) by turning screw (10) fig. 2 until bearing (6) clears the back of the blade 1/64" when band wheel is turned by hand. To adjust side blocks to blade, set the right hand guide block until it just clears the blade and fasten in place with screw (8). Place a thin piece of paper (9) around saw band and push left hand guide block against saw band. Tighten saw guide block. Repeat this process in setting lower guide. The thin paper strip guarantees proper clearance of blade between guides.

BLADE TENSION: Correct blade tension is very important for efficient operation. The wider and thicker blades require more tension than narrow blades. Blades too tight or too loose increase blade fatigue, greatly reducing the life expectancy of the blade.

TABLE ADJUSTMENTS: The table is mounted on heavy duty trunnions that rest on trunion base (4) fig. 3. The table can be tilted 45 degrees to the right and 12 degrees to the left. Table is locked in position with trunion locks (5) fig. 3. To level table with blade, raise blade guide as high as possible and place machinist square against side of blade. Set table stop on the back of table by adjusting screw on top of the stop, (6) fig. 3. The stop bar may be removed for tilting table to the left.

LUBRICATION: The bearings on the top and bottom shaft are sealed for life, requiring no lubrication. The slides and adjusting screws should be lubricated at regular intervals with a light weight oil to insure proper operation.

MACHINE DESCRIPTION AND SPECIFICATIONS

FRAME: Throughout the years CAST IRON has proven to be the ultimate material for vibrationless, trouble free service, so Powermatic has chosen a MASSIVE one-piece cast iron frame, ribbed and cross-ribbed, to house the precision mechanism forming the 'heart' of the Model 141.

WHEELS: Heavy duty cast iron upper and lower wheels are precision machined and dynamically balanced for smooth running. Ground rubber tires provide positive grip preventing blade slippage.

TABLE: A huge 15" x 15" cast iron table, accurately ground and machined for hair-line cutting is equipped with side take-out permitting use of a solid rip fence guide rail. Tilts 45° right—12° left, with positive stop at 90°.

TRUNNION: Wide-spaced cast iron and steel trunnion assures positive locking of table. An easy to read 'sight' scale is mounted on rear of table for quick, positive tilt adjustment.

SAW GUIDES: The top saw guide is fitted with backup ball bearing and large hardened steel side guides. Lower guide also utilizes backup ball bearings with angular hardened steel side guides. This design places lower guide just below table surface for closer tolerance work.

GUARDS: All moving parts are completely guarded. Only the operating portion of the blade is exposed. Large pressed steel doors enclose upper and lower wheels.

SAW BLADE ADJUSTMENT: Blade tension is adjusted with conveniently located handwheel, spring-loaded to absorb shock and maintain equal tension on the saw blade. A tension scale, located at eye-level controls proper blade tension.

DRIVE: Non-slip V-belt for utmost efficiency in any work load range. Drive, motor and "v" belt are completely enclosed in a heavily braced steel floor stand.

SAFETY RULES

1. Before starting Band Saw, check blade tension and tracking. Also make certain table is clear of any foreign matter.
2. Always keep guards in place and use them.
3. Keep fingers and hands free of cutting area. On very small pieces, use a holding jig or push stick.
4. Remove or fasten loose articles of clothing, such as necktie, sleeves, coat, etc.
5. Read and thoroughly understand operation manual before using this piece of equipment.
6. By all means do not play around a running machine. Nine out of ten accidents are the result of carelessness and playing with the machine as though it were a toy.
7. Keep upper guide as close to top of work surface as possible.
8. Make sure machine is "off" and blade has completely stopped before opening doors for blade service. Disconnect power source when adjusting or repairing any moving part to avoid injury through accidental starting of machine.
9. Use only genuine Powermatic or factory authorized replacement parts and accessories. Otherwise all warranty and guarantee is null and void.
10. Base of machine should be grounded to a water pipe or central grounding station.

GENERAL SET-UP AND ALIGNMENT

1. RECEIVING

Uncrate and check for shipping damage. Clean all coated and greased surfaces. Read instructions thoroughly. Locate all lubrication points; adjustments; methods of drive.

2. MOUNTING

Mount machine securely to solid foundation. Concrete base mounting preferred. Locate in clean, dry and well ventilated building if possible. Motor and electrical connections should be protected when not in operation or if exposed to weather elements.

3. INSPECTION

The above machine requires the minimum amount of attention in service. Periodic or regular inspections are recommended to insure machine is in proper adjustment, positive electrical connections; worn or loose "V" belts and bearings heating or loose.

4. BEFORE OPERATING

Check motor nameplate data or wiring diagram of motor and switch for proper voltage connections before wiring into line. Run motor without load to check the connections and direction of rotation. Always refer to motor nameplate for rotation connections.

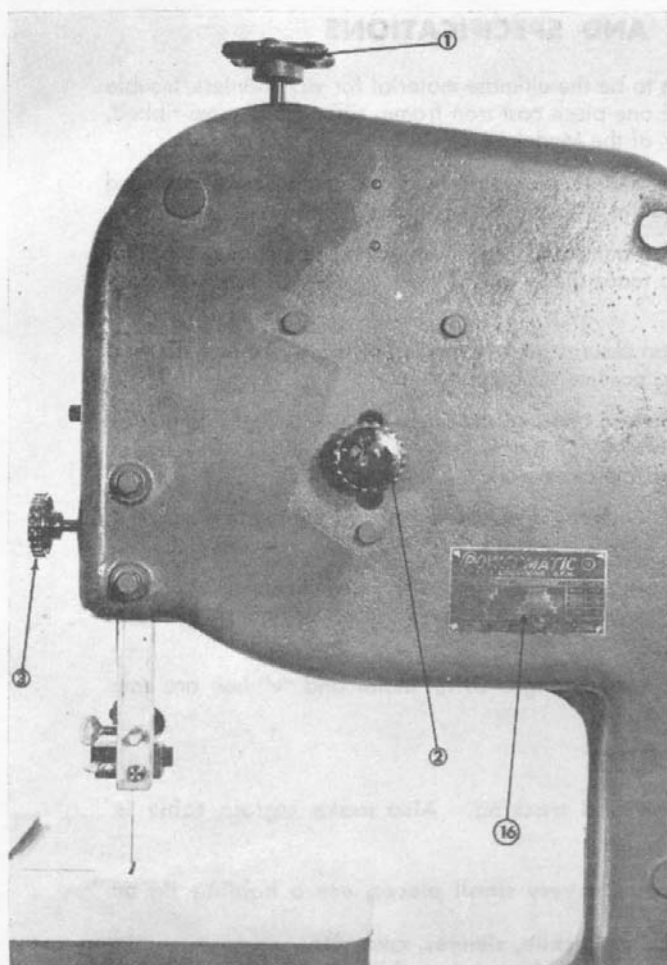

FIGURE 1

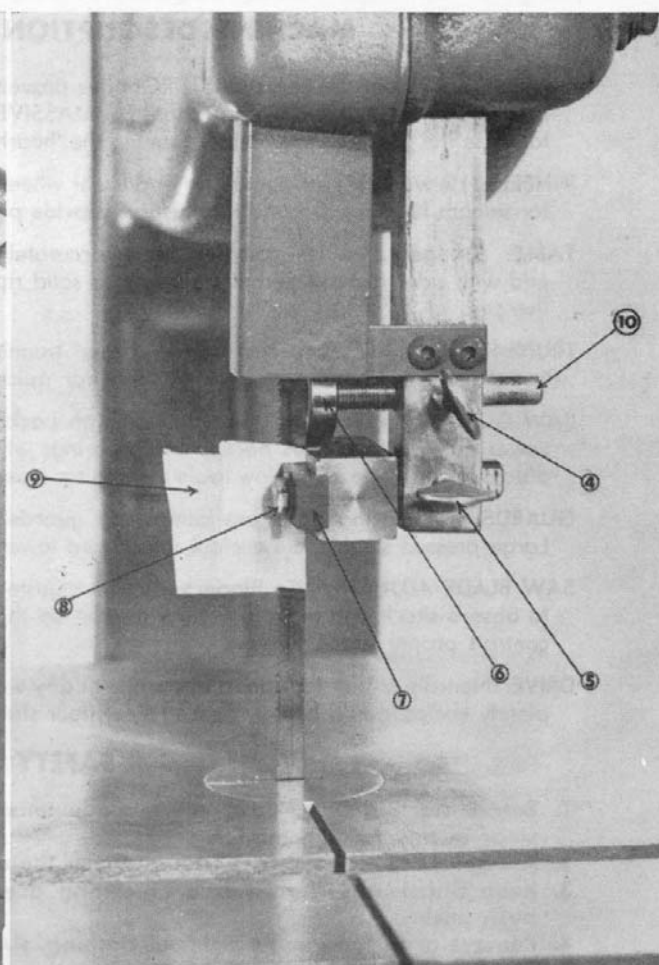

FIGURE 2

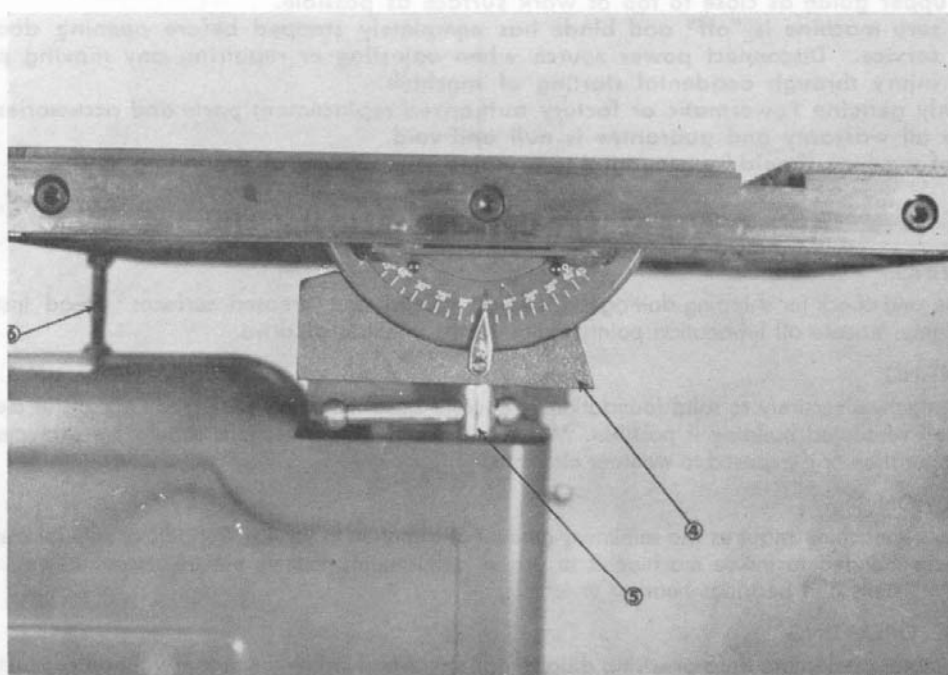
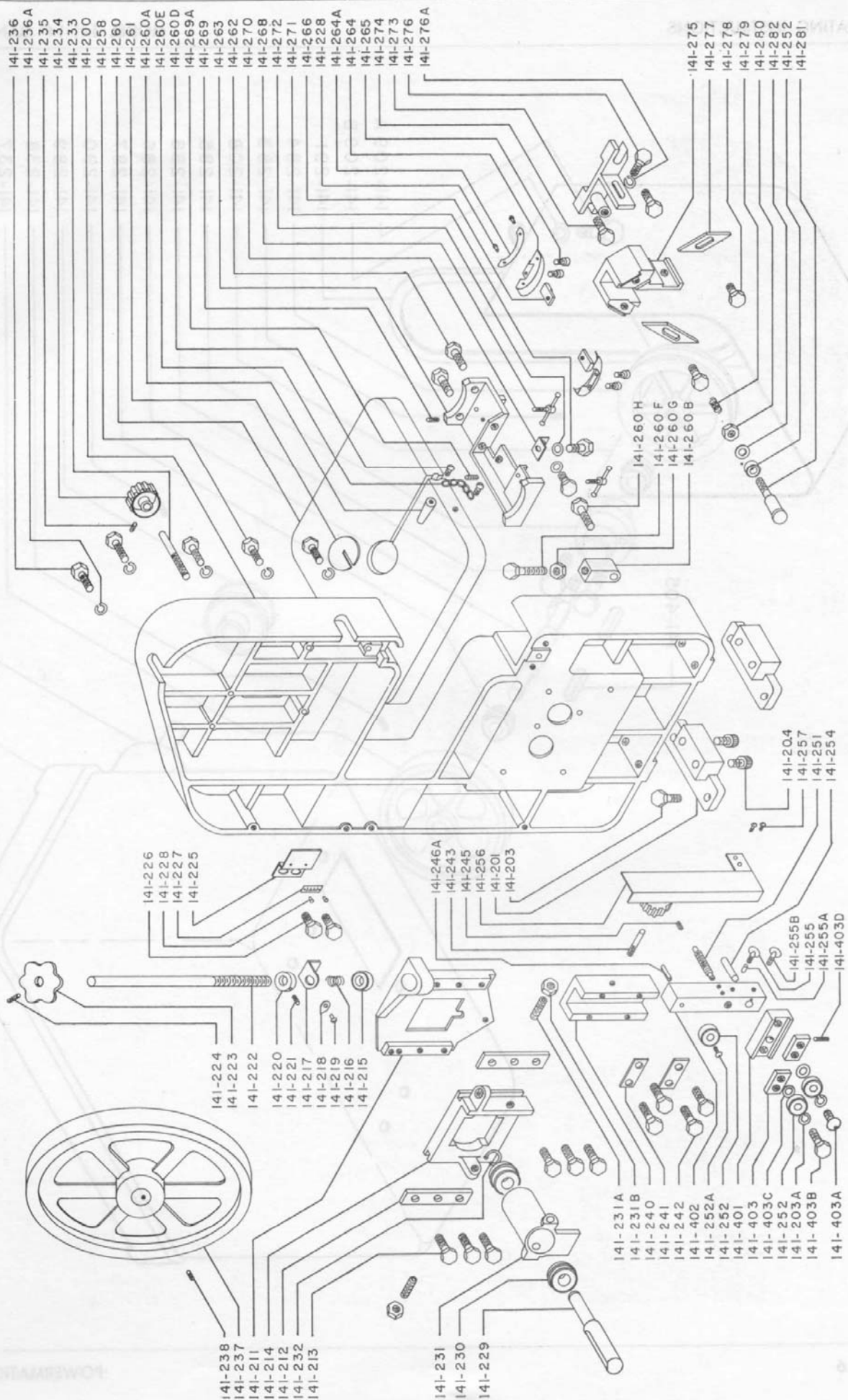
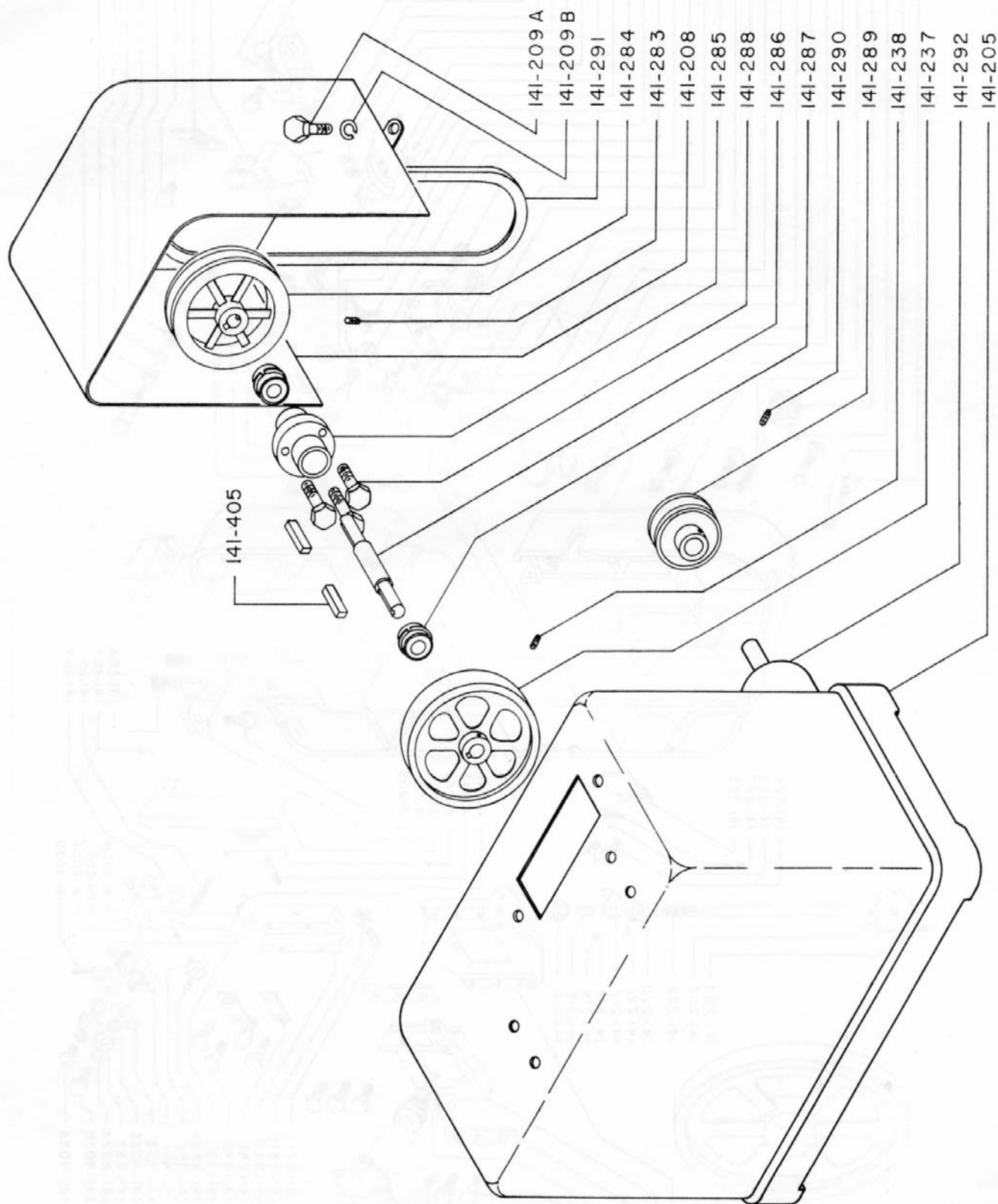
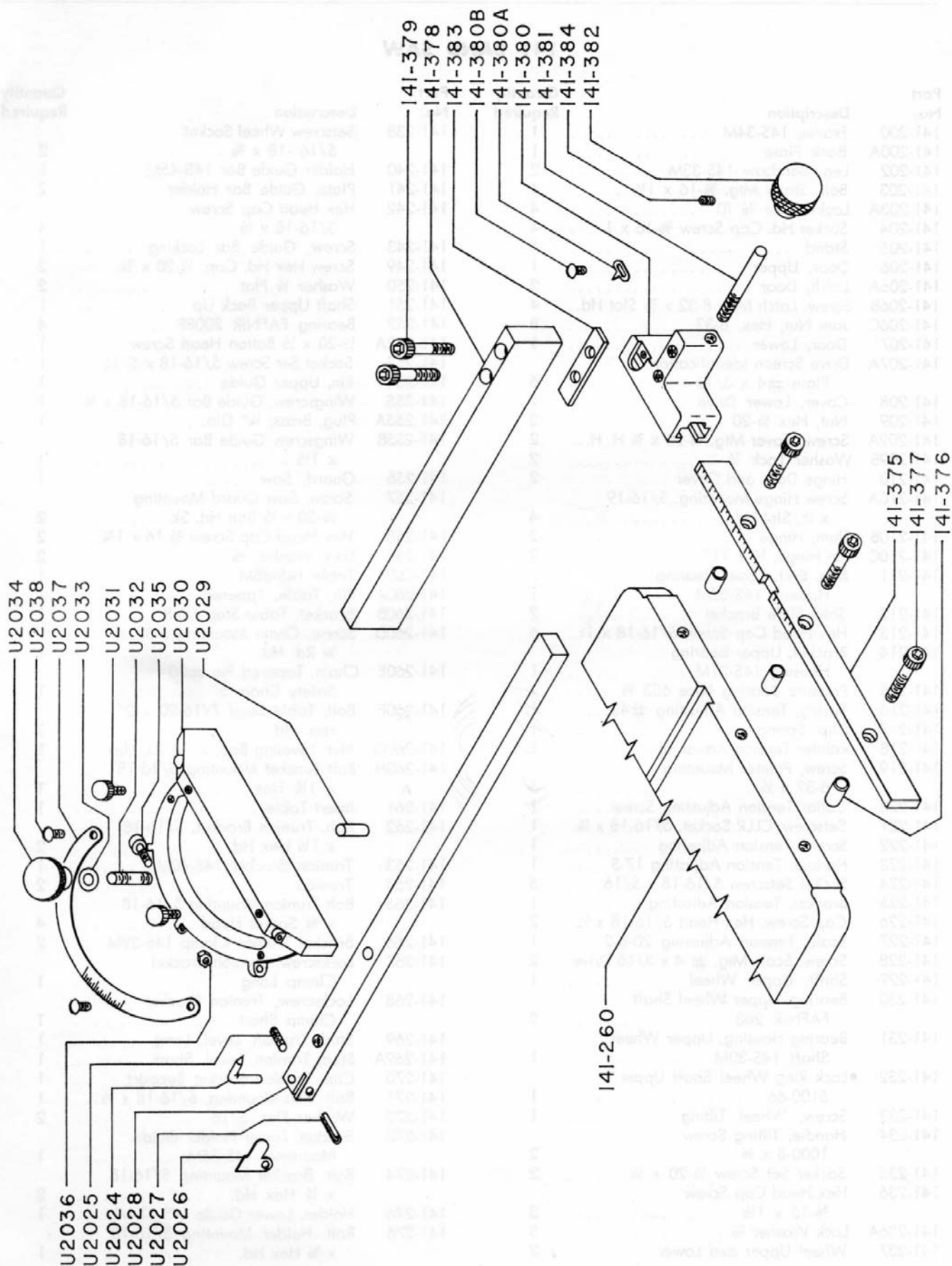

FIGURE 3







141 BAND SAW

Part No.	Description	Quantity Required	Part No.	Description	Quantity Required
141-200	Frame, 14S-34M	1	141-238	Setscrew Wheel Socket	
141-200A	Back Plate	1		5/16 -18 x 3/8	2
141-202	Leg, Bandsaw 14S-33M	2	141-240	Holder Guide Bar 14S-45M	1
141-203	Bolt, Stand Mtg. 3/8-16 x 1 1/4	4	141-241	Plate, Guide Bar Holder	2
141-203A	Lockwasher 3/8 ID	4	141-242	Hex Head Cap Screw	
141-204	Socket Hd. Cap Screw 3/8-16 x 1	4		5/16-18 x 1/2	4
141-205	Stand	1	141-243	Screw, Guide Bar Locking	1
141-206	Door, Upper	1	141-249	Screw Hex Hd. Cap. 1/4-20 x 3/4	2
141-206A	Latch, Door	2	141-250	Washer 1/4 Flat	2
141-206B	Screw, Latch Mtg. 8-32 x 3/8 Slot Hd.	4	141-251	Shaft Upper Back Up	1
141-206C	Jam Nut, Hex, 8-32	8	141-252	Bearing FAFNIR 200PP	4
141-207	Door, Lower	1	141-252A	1/4-20 x 1/2 Button Head Screw	1
141-207A	Drive Screen Identification		141-253	Socket Set Screw 5/16-18 x 5/16	1
	Plate #4 x 3/16	6	141-254	Pin, Upper Guide	1
141-208	Cover, Lower Drive	1	141-255	Wingscrew, Guide Bar 5/16-18 x 3/4	1
141-209	Nut, Hex 1/4-20	2	141-255A	Plug, Brass, 1/4" Dia.	1
141-209A	Screw, Cover Mtg. 1/4-20 x 3/4 H. H.	2	141-255B	Wingscrew Guide Bar 5/16-18	
141-209B	Washer Lock 1/4	2		x 1 1/2	1
141-210	Hinge Door and Cover	2	141-256	Guard, Saw	1
141-210A	Screw Hinge Mounting, 5/16-19		141-257	Screw, Saw Guard Mounting	
	x 1/2, Slot Hd.	4		1/4-20 x 1/2 Btn Hd. Sk.	2
141-210B	Shim, Hinge	2	141-258	Hex Head Cap Screw 3/8-16 x 1 3/4	2
141-210C	Pin Hinge, 1/8 x 11"	2	141-259	Lock Washer 3/8	2
141-211	Mtg. Brkt. Upper Bearing		141-260	Table 14S-38M	1
	Housing 14S-32M	1	141-260A	Pin, Table, Tapered	1
141-212	Shim Slide Bracket	2	141-260B	Bracket, Table Stop J-6-8	1
141-213	Hex Head Cap Screw 5/16-18 x 1	6	141-260D	Screw, Chain Mounting 6-32 x	
141-214	Bracket, Upper Bearing			1/4 Rd. Hd.	1
	Housing 14S-31M	1	141-260E	Chain, Tapered Pin #00	
141-215	Pressure Bearing Nice 603 1/2	1		Safety Chain 5"	1
141-216	Spring, Tension Adjusting #43	1	141-260F	Bolt, Table Level 7/16-20 x 2"	
141-217	Clip Spring	1		Hex Hd.	1
141-218	Pointer Tension Adjusting	1	141-260G	Nut, Leveling Bolt, 7/16-20, Hex.	1
141-219	Screw, Pointer Mounting		141-260H	Bolt Bracket Mounting 5/16-18	
	6-32 x 1/4	5		x 1 1/4 Hex.	1
141-220	Collar Tension Adjusting Screw	1	141-261	Insert Table	1
141-221	Setscrew, CLLR Socket, 5/16-18 x 1/4	1	141-262	Bolt, Trunion Bracket, 5/16-18	
141-222	Screw, Tension Adjusting	1		x 1 1/4 Hex Hd.	2
141-223	Handle, Tension Adjusting 17-S	1	141-263	Trunion Bracket 14S-40M	1
141-224	Socket Setscrew 5/16-18 x 5/16	5	141-264	Trunion	2
141-225	Bracket, Tension Adjusting	1	141-265	Bolt Trunion Mounting 5/16-18	
141-226	Cap Screw, Hex Head 5/16-18 x 1/2	2		x 3/4 Socket Head	4
141-227	Scale, Tension Adjusting 20-B-2	1	141-266	Bracket Trunion Clamp 14S-39M	2
141-228	Screw, Scale Mtg. # 4 x 3/16 Drive	2	141-267	Lockscrew, Trunion Bracket	
141-229	Shaft, Upper Wheel	1		Clamp Long	1
141-230	Bearing, Upper Wheel Shaft		141-268	Lockscrew, Trunion Bracket	
	FAFNIR 203	2		Clamp Short	1
141-231	Bearing Housing, Upper Wheel		141-269	Stud, Trunion, Level, Long	1
	Shaft 14S-30M	1	141-269A	Stud, Trunion, Level, Short	1
141-232	Lock Ring Wheel Shaft Upper		141-270	Clip, Trunion Bracket Support	1
	5100-66	1	141-271	Bolt, Clip Mounting, 5/16-18 x 1/2	1
141-233	Screw, Wheel Tilting	1	141-272	Washer Flat, 5/16	2
141-234	Handle, Tilting Screw		141-273	Bracket, Lower Holder Guide	
	1000-8 x 3/8	2		Mounting 14S-35M	1
141-235	Socket Set Screw 1/4-20 x 1/4	2	141-274	Bolt, Bracket Mounting 5/16-18	
141-236	Hex Head Cap Screw			x 1/4 Hex Hd.	2
	3/8-16 x 1 1/2	3	141-275	Holder, Lower Guide 14S-37 ML	1
141-236A	Lock Washer 3/8	3	141-276	Bolt, Holder Mounting 5/16-18	
141-237	Wheel Upper and Lower	2		x 3/4 Hex Hd.	1

Part No.	Description	Quantity Required	Part No.	Description	Quantity Required
141-276A	Washer, Lock 5/16	1	141-288	Bolt, Bearing Housing Mounting 5/16-18 x 2 Hex Hd.	3
141-277	Lower Guide (Tennessee)	2	141-289	Pulley, Motor AK22	1
141-278	Bolt, Lower Guide Mounting, 1/4-20 x 3/4 Hex Hd.	2	141-290	Setscrew Pulley (Same As 141-224)	1
141-279	Spring, Lower Back Up Bearing #143	1	141-291	Belt Pulley, Browning 4L620	1
141-280	Nut Hex 3/8-16	1	141-292	Motor	1
141-281	Shaft, Lower Back Up Bearing	1	141-293	Bolt, Motor Mounting 5/16-18 x 1 Hex Hd.	4
141-282	Washer Flat 3/8	1	141-294	Plate Motor Mounting	1
141-283	Socket Set Screw 5/16-18 x 3/8	1	141-401	Ball Bearing Guide Holder	1
141-284	Pulley, Lower Wheel Shaft AL-74	1	141-402	Guide Bar	1
141-285	Bearing Housing, Lower Wheel Shaft 14S-47M	1	141-403	Plate, Saw Guide Bearing	2
141-286	Shaft, Lower Wheel	1	141-403A	Button Head Screw 3/8-24 x 7/8	1
141-287	Bearing, Lower Wheel Shaft MRC 204SZZG	2	141-403B	Hex Head Cap Screw 3/8-24 x 7/8	1
			141-403C	Washer, Flat, Thin Plated 3/8	2
			141-403D	Socket Set Screw 5/16-18 x 5/16	1

OPTIONAL EQUIPMENT (RIP FENCE)

Part No.	Description	Quantity Required	Part No.	Description	Quantity Required
141-375	Bar Fence	1	141-380A	Pointer, Fence	1
141-376	Spacer, Fence Bar	3	141-380B	Screw, Fence Pointer 6-32 x 1/4 Round Head	1
141-377	Bolt, Fence Bar Mtg. 5/16-18 x 3/4 Socket Head	3	141-381	Screw Fence Lock	1
141-378	Fence	1	141-382	Handle, Fence Lock Screw 1-10	1
141-379	Bolt, Fence Mounting 5/16-18 x 1 3/4 Socket Hd.	2	141-383	Shim, Fence	1
141-380	Carriage, Rip Fence 14S-18	1	141-384	Socket Setscrew 1/4-20 x 1/4	1

MITER GAUGE

Part No.	Description	Quantity Required	Part No.	Description	Quantity Required
U2024	Pointer	1	U2032	Lock Screw (65-02)	1
U2025	Screw, Pointer 8-32 x 1/4 Socket Set	1	U2033	Washer, 1/4" Flat	1
U2026	Stop	1	U2034	Knob, Lock Screw (65-01)	1
U2027	Pin, Stop, Split Pin 1/8 x 5/16	1	U2035	Screw Stop, 6-32 x 3/8 Fillister Head	3
U2028	Bar, Miter Gauge	1	U2036	Nut, Stop Screw, 6-32 Hex	3
U2029	Pivot Pin, 1/4 x 1 Hardened Dowel	1	U2037	Dial, Miter Gauge (TA-1)	1
U2030	Casting, Miter Gauge	1	U2038	Screw, Dial 6-32 x 1/4 Rd. Head	2
U2031	Screw, Stop Rod Lock 1/4-20 x 3/4 Thumb	2	U3000-1	Stop Rod Assy. Miter Gauge (Not Shown)	1

PARTS PRICE LIST MODEL 141-14" WOOD BAND SAW

(EFFECTIVE MARCH 1965)

<u>PART NO.</u>	<u>DESCRIPTION</u>	<u>NUMBER</u>	<u>PRICE</u>
141-200	Frame	1	\$45.00
141-200A	Black Plate	1	2.00
141-201	Leg, Frame, Left	1	2.25
141-202	Leg, Frame, Right	1	2.25
141-203	Bolt, Stand Mounting (Not Pic) 3/8-16 x 1 1/4 Hex Hd.	4	.25 Ea.
141-203A	Lock Washer (Not Pic)	4	.10 Ea.
141-204	Bolt, Leg Mounting 3/8-16 x 1" Socket Hd.	4	.25 Ea.
141-205	Stand	1	35.00
141-206	Door, Upper (not pic)	1	15.00
141-207	Door, Lower (not pic)	1	15.00
141-208	Cover, Lower Drive	1	8.50
141-209A	Screw, Cover Mounting 1/4-20 x 3/4 Hex Hd.	2	.15 Ea.
141-209B	Washer	2	.10 Ea.
141-211	Mounting Bracket, Upper Bearing Housing Bracket	1	.15 Ea.
141-212	Shim, Slide Bracket	2	.75 Ea.
141-213	Screw, Shim Mounting 5/16-18 x 1" Button Hd.	6	.15 Ea.
141-214	Bracket, Upper Bearing Housing	1	4.00
141-215	Pressure Bearing, Tension Adj. Screw	1	1.00
141-216	Spring Tension Adj. Screw	1	.40
141-217	Clip, Spring	1	.50
141-218	Pointer, Tension Adj.	1	.25
141-219	Screw, Pointer Mounting 6-32 x 1/4	1	.10
141-220	Collar, Tension Adj. Screw	1	.50
141-221	Setscrew, Collar 5/16-18 x 1/4	1	.10
141-222	Screw, Tension Adj.	1	1.00
141-223	Handle, Tension Adj. Screw	1	1.50
141-224	Setscrew, Tension Adj. Screw Handle 5/16-18 x 1/4	1	.10
141-225	Bracket, Tension Adj. Scale	1	1.00
141-226	Bolt, Bracket Mounting 5/16-18 x 1/2 Hex Hd	2	.20 Ea.
141-227	Scale, Tension Adj.	1	.40
141-228	Screw, Scale Mounting 6-32 x 1/4	2	.10 Ea.
141-229	Shaft, Upper Wheel	1	4.00
141-230	Bearing, Upper Wheel Shaft, FAFNIR 203 NPPG or Equal	2	2.75 Ea.
141-231	Bearing, Housing, Upper Wheel Shaft	1	3.50
141-231A	Setscrew, Bearing Housing Mounting 1/2-13 x 1 1/4 DP	2	.25 Ea.
141-231B	Nut, Setscrew Locking 1/2-13 Hex Hd.	2	.10 Ea.
141-232	Lock Ring, Wheel Shaft 5100-66 Tru-ARC Waldes	1	.10
141-233	Screw, Wheel Tilting	1	.80
141-234	Handle, Tilting Screw	1	.75
141-235	Setscrew, Handle 1/4-20 x 1/4	1	.10

Page 2 PARTS PRICE LIST MODEL 141-14" WOOD BAND SAW

<u>PART NO.</u>	<u>DESCRIPTION</u>	<u>NUMBER</u>	<u>PRICE</u>
141-236	Bolt, Mounting Bracket 3/8 - 16 x 1 1/2 Hex	3	.25 Ea.
141-236A	Lock Washer	3	.10 Ea.
141-237	Wheel, Upper and Lower	2	8.00 Ea.
141-238	Setscrew, Wheel 5/16-18 x 3/8	2	.15 Ea.
141-240	Holder, Guide Bar	1	3.00
141-241	Plate, Guide Bar Holder	2	.75 Ea.
141-242	Screw, Plate Mounting 5/16-18 x 1/2	4	.20 Ea.
141-243	Screw, Guide Bar Locking	1	.60
141-244	Handle, Locking Screw	1	.75
141-245	Setscrew, Handle 1/4-20 x 1/4	1	.10
141-249	Screw, Guide Mounting 1/4-20 x 3/4 Hex Hd.	2	.15 Ea.
141-250	Washer, Guide Mounting Screw	2	.10 Ea.
141-251	Shaft, Upper Guide Back-Up Bearing	1	1.00
141-251A	Knob, Bearing Shaft	1	.50
141-252	Bearing Back-Up, Upper & Lower N. D. 3200 or Equal	2	2.00
141-252A	1/4-20 x 1/2 Button Head Screw	1	.15
141-252B	3/8-24 x 3/4 Button Head Screw	1	.20
141-252C	3/8 Thrust Washer	1	.15
141-253	Setscrew, Upper Guide Holder 5/16-18 x 5/16	1	.10
141-254	Pin, for Upper Guide	1	.50
141-255	Wing Screw, Guide Bar 5/16-18 x 3/4"	1	.25 Ea.
141-255A	Brass Plug	1	.15
141-255B	Wing Screw, Guide Bar 5/16-18 x 1 1/2	1	.25
141-256	Guard, Saw	1	1.50
141-257	Screw, Saw Guard Mounting 1/4-20 x 1/2 Hex Hd.	2	.10 Ea.
141-258	Bolt, Guide Bar Holder Mounting 3/8-16 x 1-3/4 Hex Hd.	2	.25 Ea.
141-259	Lock Washer	2	.10 Ea.
141-260	Table	1	13.00
141-260A	Pin, Table, Tapered	1	.40
141-260B	Bracket, Table Stop J-6-8	1	1.15
141-260D	Scr. Chain Mtg. 6-32 x 1/4 Rd. Hd.	1	.10
141-260E	Chain, Tapered Pin #00 Safety Chain 5"	1	.10
141-260F	Bolt, Table Level 7/16-20 x 2" Hex Hd.	1	.20
141-260G	Nut, Leveling Bolt 7/16-20, Hex	1	.15
141-260H	Bolt Brkt. Mtg. 5/16-18 x 1-1/4 Hex	1	.15
141-261	Insert, Table	1	.60
141-262	Bolt, Trunion Bracket Mounting 5/16-18 x 1-1/4 Socket Hd.	2	.25 Ea.
141-263	Trunion Bracket	1	5.00
141-264	Trunion	2	1.25 Ea.
141-265	Bolt, Trunion Mounting 5/16-18 x 3/4 Socket Hd.	4	.20 Ea.

Page 3 PARTS PRICE LIST MODEL 141-14" WOOD BAND SAW

<u>PART NO.</u>	<u>DESCRIPTION</u>	<u>NUMBER</u>	<u>PRICE</u>
141-266	Bracket, Trunion Clamp	2	1.35
141-267	Lockscrew, Trunion Clamp Bracket (Long)	1	1.50
141-268	Lockscrew, Trunion Clamp Bracket (Short)	1	1.50
141-269	Stud, Trunion Clamp Bracket Leveling (Long)	1	1.20
141-269A	Stud, Trunion Clamp Bracket Leveling (Short)	1	1.20
141-270	Clip, Trunion Bracket Support	1	1.50
141-271	Bolt, Clip Mounting 5/16-18 x 1/2 Hex Hd.	2	1.10 Ea.
141-272	Washer, Mounting Bolt	2	1.10 Ea.
141-273	Bracket, Lower Guide Holder Mounting	1	2.00
141-274	Bolt, Bracket Mounting 5/16-18 x 1-1/4 Hex Hd.	2	1.20
141-275	Holder, Lower Guide	1	4.00
141-276	Bolt, Holder Mounting 5/16-18 x 3/4 Hex Hd.	1	1.20
141-276A	Washer, Mounting Bolt	1	1.10
141-277	Lower Guide	2	2.00 Ea.
141-278	Screw, Lower Guide Mounting 1/4-20 x 3/4 Hex Hd.	2	1.20 Ea.
141-279	Spring, Lower Back-Up Bearing	1	1.25
141-280	Nut Hex 3/8-16	1	1.25
141-281	Shaft, Lower Back-Up Bearing	1	1.00
141-282	Washer Flat 3/8	1	1.25
141-283	Setscrew, Lower Wheel Shaft Pulley 5/16-18 x 1/4	1	1.10
141-284	Pulley, Lower Wheel Shaft AK74	1	5.00
141-285	Bearing Housing, Lower Wheel Shaft	1	6.50
141-286	Shaft, Lower Wheel	1	6.50
141-287	Bearing, Lower Wheel Shaft MRC 204 SZZG or Equal	2	2.75 Ea.
141-288	Bolt, Bearing Housing Mounting 5/16-18 x 2" Hex Hd.	3	1.25 Ea.
141-289	Pulley, Motor AK 22	1	2.35
141-290	Setscrew, Motor Pulley 5/16-18 x 1/4	1	1.10 Ea.
141-291	Belt, Pulley, Browning 4L610	1	1.83
141-293	Bolt, Motor Mounting 5/16-18 x 1" Hex Hd.	4	1.25 Ea.
141-294	Plate, Motor Mounting	1	4.50
141-375	Bar Fence	1	4.00
141-376	Spacer, Fence Bar	3	1.10
141-377	Bolt Fence Mtg. 5/16-18 x 3/4 Sock Hd.	3	1.15
141-378	Fence	1	4.00
141-379	Bolt, Fence Mtg. 5/16-18 x 1 3/4 Socket Hd.	2	1.15
141-380	Carriage, Rip Fence 14S-18	1	3.00
141-380A	Pointer, Fence	1	1.15
141-380B	Scr. Fence Pointer 6-32 x 1/4 Rd. Hd.	1	1.10
141-381	Screw Fence Lock	1	1.25
141-382	Handle, Fence Lock scr. 1-10	1	1.00

Page 4 PARTS PRICE LIST MODEL 141-14" WOOD BAND SAW

<u>PART NO.</u>	<u>DESCRIPTION</u>	<u>NUMBER</u>	<u>PRICE</u>
141-383	Shim, Fence	1	.15
141-384	Socket Setscrew 1/4-20 x 1/4	1	.15
141-401	Ball Bearing, Guide Holder	1	3.00
141-402	Guide Bar	1	3.50
141-403	Plate, Saw Guide Bearing	2	2.00
141-403A	Button Hd. Screw 3/8-24 x 7/8	1	.15
141-403B	Hex Hd. Capscrew 3/8-24 x 7/8	1	.15
141-403C	Washer, Flat, Thin Plated 3/8	2	.10
141-403D	Socket Set Screw 5/16-18 x 5/16	1	.15
141-406	Key, Lower Wheel Shaft 3/16 x 3/16 x 1	2	.15

A MINIMUM BILLING OF \$1.50 WILL BE MADE ON ALL ORDERS.